



Fire Your Imagination

Logic HE™ Range

Conventional Flue Log Effect



Instructions for Use, Installation and Servicing

For use in GB, IE (Great Britain and Republic of Ireland)

IMPORTANT

THE OUTER CASING, FRONT AND GLASS PANEL BECOME EXTREMELY HOT DURING OPERATION AND WILL RESULT IN SERIOUS INJURY AND BURNS IF TOUCHED. IT IS THEREFORE RECOMMENDED THAT A FIREGUARD COMPLYING WITH BS 8423 (LATEST EDITION) IS USED IN THE PRESENCE OF YOUNG CHILDREN, THE ELDERLY OR INFIRM.

This product contains a Heat resistant glass panel. This panel should be checked during Installation and at each servicing interval. If any damage is observed on the front face of the glass panel (scratches, scores, cracks or other surface defects), the glass panel must be replaced and the appliance must not be used until a replacement is installed. Under no circumstances should the appliance be used if any damage is observed, the glass panel is removed or broken.

It is essential that ALL of the screws that retain the glass frame are replaced and tightened correctly. Under no circumstances should the appliance be operated if any of these screws are loose or missing.

These Instructions must be left with the appliance for future reference and for consultation when servicing the appliance. Please make the customer aware of the correct operation of the appliance before leaving these instructions with them.

The commissioning sheet found on Page 3 of this Instruction manual must be completed by the Installer prior to leaving the premises.

Contents

Logic HE Conventional Flue

Covering the following models:

Nat Gas	LPG
101-245	101-482

Appliance Commissioning Checklist3

User Instructions.....4

Installation Instructions.....8

Technical Specification8

Site Requirements..... 11

Installation 13

Commissioning.....20

Servicing Instructions.....21

Fault Finding.....21

How to replace parts23

Spare parts list28

Service Records30

Information Requirement - Gas Heaters31



If you have purchased your stove or fire from an authorised stockist within our Expert Retailer Network, then automatically your product will carry a 2 year warranty as standard. The 2 year warranty can be further extended to a total warranty period of 5 years by registering your Gazco Stove or Fireplace within one month of the latter of the purchase date or installation date. Accordingly, the start date for the warranty period is the date of purchase. During the registration process, the Expert Retailer details will be required for your Extended Warranty to be activated. Any product purchased outside of our Expert Retailer Network will carry a standard 12 month, non-extendable warranty.

It is a condition of the Extended Warranty that the installation complies with the relevant Building Regulations and is carried out by a suitably trained and qualified individual (GasSafe in the UK or equivalent in other countries) with the certificate of installation and the Commissioning Report on Page 3 completed and retained by the end user.

Full terms and conditions are detailed in the Warranty Statement on the Gazco website www.gazco.com. In the event of any conflict of information the wording on the website shall prevail.

Important Note: Should any problems be experienced with your product, claims must first be submitted to the Expert Retailer where the appliance was purchased from who will offer immediate assistance or contact Gazco on your behalf.



It is a requirement of the Building Regulations 2010 that the installation of this appliance is notified to the Local Authority. It is the responsibility of the GasSafe registered installer to carry out this notification to the Local Authority via the GasSafe register Competent Persons Scheme in England and Wales (different rules apply in Scotland and Northern Ireland).

When the installation has been notified, GasSafe will send a Building Regulations Compliance Certificate to you containing details of the work completed. Please ensure that the person responsible for the installation of this appliance completes this notification and records it in the Appliance Commissioning Checklist on page 3.

IT IS YOUR RESPONSIBILITY TO COMPLY WITH THE BUILDING REGULATIONS AND BE ABLE TO PRODUCE THIS CERTIFICATE SHOULD IT BE REQUIRED IN THE FUTURE.

Appliance Commissioning Checklist

To assist us in any guarantee claim please complete the following information:-

IMPORTANT NOTICE

Explain the operation of the appliance to the end user, hand the completed instructions to them for safe keeping, as the information will be required when making any guaranteed claims.

FLUE CHECK	PASS	FAIL
1. Flue Is correct for appliance		
2. Flue flow Test		
3. Spillage Test		
GAS CHECK		
1. Gas soundness & let by test		
2. Standing gas pressure	mb	
3. Appliance working pressure (on High Setting) NB All other gas appliances must be operating on full	mb	
4. Gas rate	m ³ /h	
5. Does Ventilation meet appliance requirements		
SAFETY CHECK		
1. Glass checked to ensure no damage, scratches, scores or cracks		
2. Glass frame secured correctly and all screws replaced		
BUILDING CONTROL NOTIFICATION	YES	NO
1. Installer notified GasSafe/Local Authority of installation via Competent Persons Scheme?		

RETAILER AND INSTALLER INFORMATION

Retailer Contact No. Date of Purchase Model No. Serial No. Gas Type	Installation Company Engineer Contact No. GasSafe Reg No. Date of Installation.
--	--

User Instructions

Welcome

Congratulations on purchasing your Logic HE fire, if installed correctly Gazco hope it will give you many years of warmth and pleasure for which it was designed.

The purpose of this manual is to familiarise you with your appliance, and give guidelines for its installation, operation and maintenance. If, after reading, you need further information, please do not hesitate to contact your Gazco retailer.

WARNING



In the event of a gas escape or if you can smell gas, please take the following steps:

- Immediately turn off the gas supply at the meter/emergency control valve
- Extinguish all sources of ignition
- Do not smoke
- Do not operate any electrical light or power switches (On or Off)
- Ventilate the building(s) by opening doors and windows
- Ensure access to the premises can be made

Please report the incident immediately to the National Gas Emergency Service Call Centre on 0800 111 999 (England, Scotland and Wales) , 0800 002 001 (N. Ireland) or in the case of LPG, the gas supplier whose details can be found on the bulk storage vessel or cylinder.

The gas supply must not be used until remedial action has been taken to correct the defect and the installation has been recommissioned by a competent person.

1. General

- 1.1 Installation and servicing must only be carried out by a competent person whose name appears on the GasSafe register. To ensure the engineer is registered with GasSafe they should possess an ID Card carrying the following logo:



- 1.2 In all correspondence, please quote the appliance type and serial number, which can be found on the data badge adjacent to the control assembly.
- 1.3 Do not place curtains above the appliance: You must have 300mm clearance between the appliance and any curtains at either side.

- 1.4 No furnishings or other objects should be placed within 1 metre of the front of the appliance.
- 1.5 If a shelf is fitted, a distance of 150mm above the decorative front is required.
- 1.6 If any cracks appear in the glass panel do not use the appliance until the panel has been replaced.
- 1.7 The decorative front will become hot during normal use and should be treated as a working surface. It is recommended that a suitable fireguard be used for the protection of young children and the infirm.
- 1.8 This product is guaranteed for 5 years from the date of installation, as set out in the terms and conditions of sale between Gazco and your local Gazco retailer. Please consult with your local Gazco retailer if you have any questions. In all correspondence always quote the Model Number and Serial Number.



IMPORTANT: NEVER position a television or screen above this appliance.

2. Operating the Appliance

This appliance is operated using the slide control on the top right hand side of the decorative front.

When the appliance is OFF the slide control will be at the highest point, see Diagram 1.

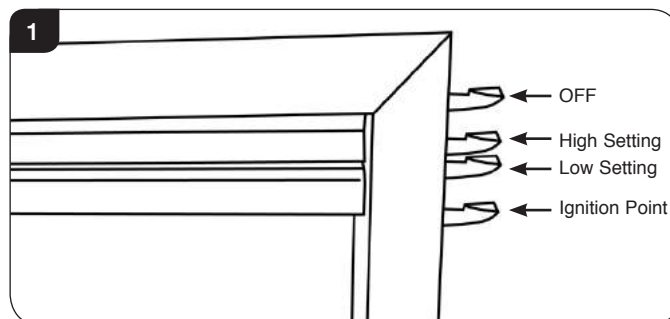

Lighting the Pilot

- 2.1 Push the slide control down as far as possible to its lowest point, see Diagram 1, this is the ignition point.

Keep the slide control pressed down for 5 seconds to ensure the pilot is lit. Then release.

The appliance should light on its lowest setting.

- 2.2 When released the slide control automatically raises to a natural stop point, see Diagram 1.

Repeat the above steps if the appliance does not light.

- 2.3 If, after repeating the above steps the pilot does not light, contact your Retailer or Installer.

Adjusting the Flame height

- 2.4 Increase the flame height and temperature by carefully moving the slide control up until the next stop point is felt, see Diagram 1. This denotes the highest setting.

User Instructions

- 2.5 Carefully move the slide control down to the lower stop point to return to the lowest setting.



IMPORTANT: YELLOW FLAMES TYPICALLY APPEAR WHEN THE APPLIANCE HAS REACHED NORMAL OPERATING TEMPERATURE. THIS CAN TAKE UP TO 30 MINUTES.



WARNING: IF THE APPLIANCE FAILS TO LIGHT OR BECOMES EXTINGUISHED IN USE, WAIT 3 MINUTES BEFORE ATTEMPTING TO RELIGHT.

Switching OFF the Appliance

- 2.6 To turn the appliance off lift the slide control to its highest stop point, see Diagram 1. The pilot goes out.

3. Changing the Battery

- 3.1 The battery box is located at the bottom left of the appliance behind the ash cover, see Diagram 2.

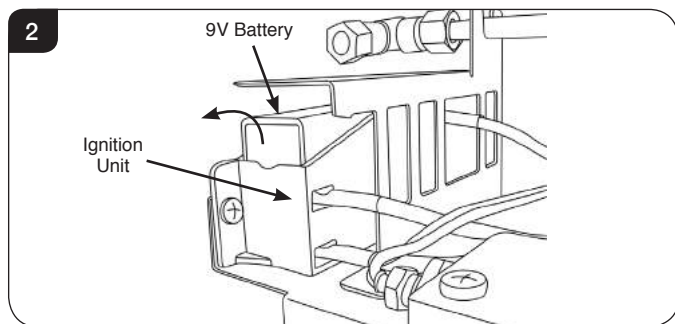

- 3.2 Remove the old battery and replace with a new high quality (Duracell or similar) 9V battery.



It is essential to use high quality batteries (Duracell or equivalent) when replacing batteries.

4. Cleaning the Appliance

- 4.1 Make sure the appliance and surrounds are cool before trying to clean.
- 4.2 Refer to the separate decorative front instructions to remove the front from the appliance.
- 4.3 Remove the glass frame by removing the 4 screws in the retaining bracket, see Diagram 3.

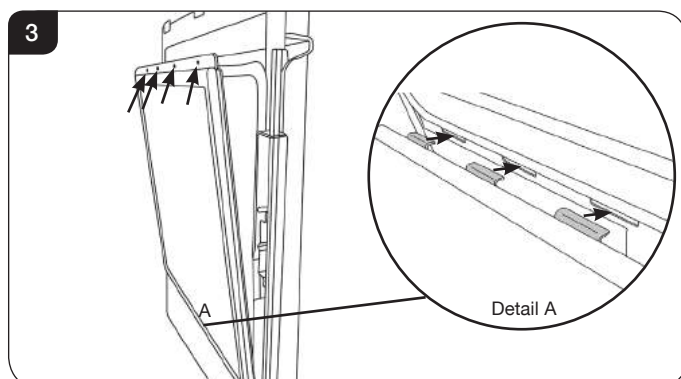

- 4.4 Tilt the top of the glass frame forward and disengage the lower location tabs from the slots in the firebox, see Diagram 3, Detail A. Place carefully to one side.
- 4.5 To clean the glass surface, Gazco recommends you use hot soapy water.
- 4.6 The glass frame must be refitted to the appliance following cleaning or servicing. Ensure that the rope seal on the box is intact, then locate the glass frame location tabs into the slots on the firebox, see Diagram 3, Detail A.
- 4.7 Secure the glass frame using 4 screws in the retaining bracket, see Diagram 3. Replace ALL of the securing screws ensuring that a screw is present in all fixing slots.

NEVER OPERATE THE APPLIANCE WHEN THE GLASS FRAME IS REMOVED OR BROKEN.

Refer to the separate decorative front instructions to replace the front on the appliance.



UNDER NO CIRCUMSTANCES SHOULD THE APPLIANCE BE USED IF ANY OF THE GLASS FRAME RETAINING SCREWS ARE LOOSE OR MISSING.

5. Arrangement of the Fuel Bed

Advice on handling and disposal of fire ceramics



The fuel effect and side panels of this appliance are made from Refractory Ceramic Fibre (RCF), a material which is commonly used for this application.

Protective clothing is not required when handling these articles, but we recommend you follow normal hygiene rules of not smoking, eating or drinking in the work area and always wash your hands before eating or drinking.

To ensure that the release of RCF fibres are kept to a minimum, during installation and servicing a HEPA filtered vacuum is recommended to remove any dust accumulated in and around the appliance before and after working on it. When servicing the appliance it is recommended that the replaced items are not broken up, but are sealed within heavy duty polythene bags and labelled as RCF waste.

RCF waste is classed as stable, non-reactive hazardous waste and may be disposed of at a licensed landfill site.

Excessive exposure to these materials may cause temporary irritation to eyes, skin and respiratory tract; wash hands thoroughly after handling the material.

User Instructions

6. Log Layout

LOGS MUST BE POSITIONED ACCORDING TO THE FOLLOWING INSTRUCTIONS TO GIVE THE CORRECT FLAME EFFECT.

- 6.1 Ensure the burner tray is clean and free from any debris, see Diagram 4.

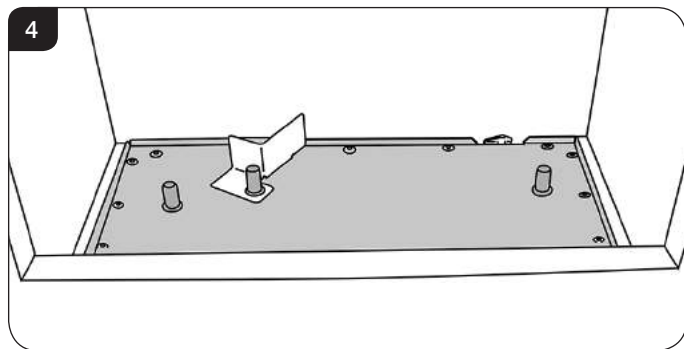

- 6.2 Place Log A in position on the 2 locating pins, see Diagram 5.

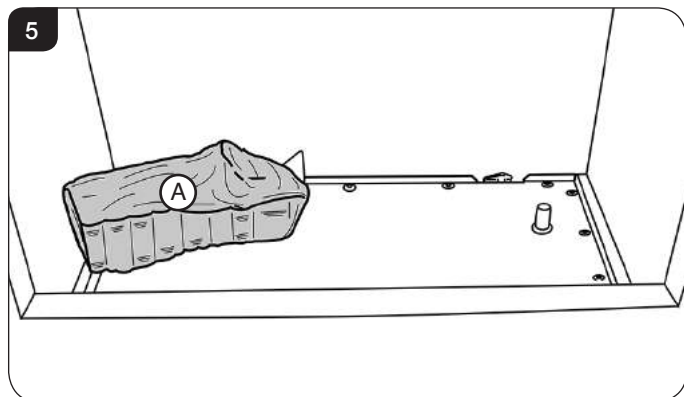

- 6.3 Spread the Lava Rock evenly over the fuel bed and around Log A, see Diagram 6.

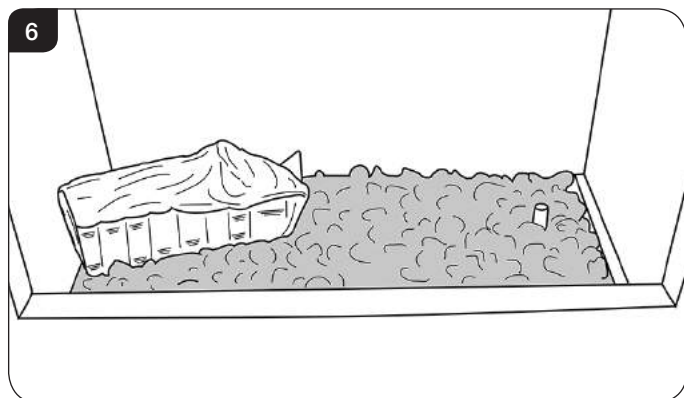

- 6.4 Log B is positioned on the right hand locating pin, and rests against the back liner, see Diagram 7.

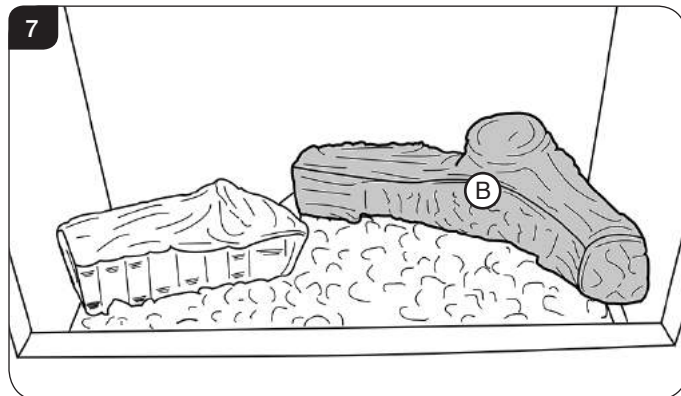

- 6.5 Log C rests on Log A and the front tray with the locating pin facing up, see Diagram 8.

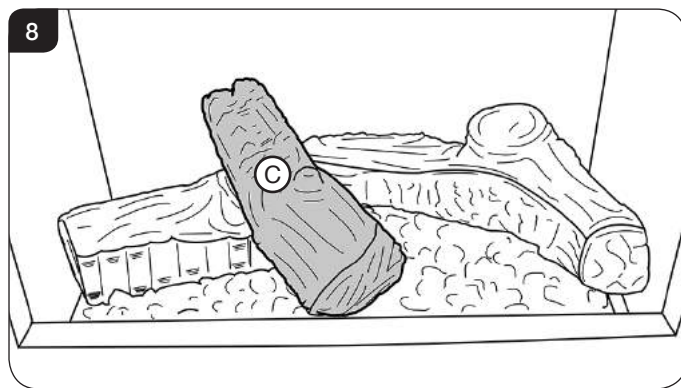

- 6.6 Log D fits onto the locating pin and rests on Log B, see Diagram 9.

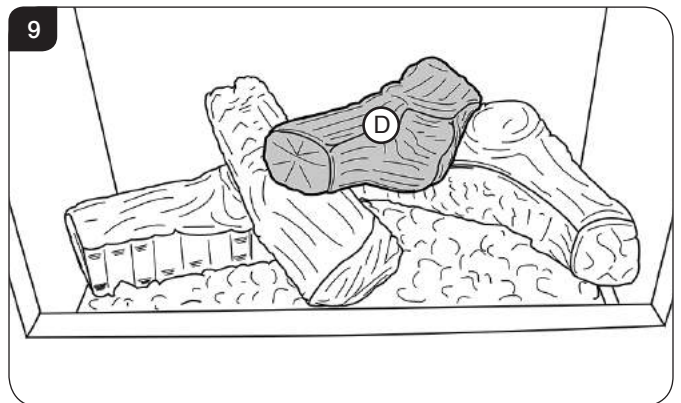

User Instructions

- 6.7 Position the 2 embers in the front right and back left corners, see Diagram 10.

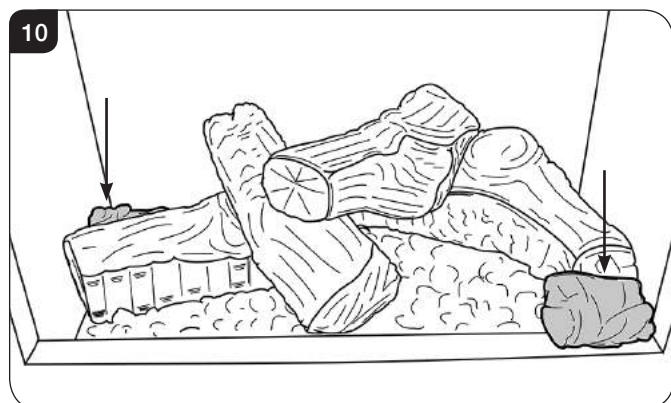

- 6.8 Spread a liberal amount of the Embaglow fibres provided on the sections highlighted, see Diagram 11.

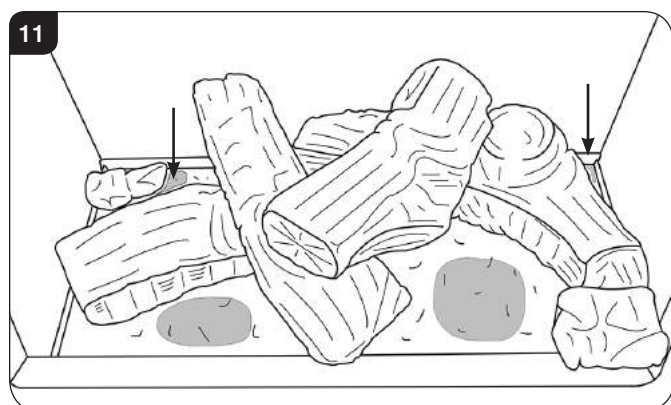

7. Oxygen Depletion Sensor

The appliance is fitted with an oxygen sensitive pilot system that will act to cut off the gas supply to the appliance should the oxygen in the room fall below its normal level. If the appliance is turned off by this device, it usually indicates that there is a problem with the flue system, and this should be inspected by a qualified engineer. **Do not attempt to use the appliance until an engineer says it is safe to do so.**

This device is not a substitute for an independently mounted carbon monoxide detector.

8. Flame Failure Device

- 8.1 This is a safety feature incorporated on this appliance which automatically switches off the gas supply if the pilot goes out and fails to heat the thermocouple.

IF THIS OCCURS DO NOT ATTEMPT TO RELIGHT THE APPLIANCE FOR 3 MINUTES.

9. Running In

- 9.1 During initial use of a new GAZCO appliance a strong odour will be encountered as various surface coatings become hot for the first time. Although these odours are harmless it is recommended that the appliance is operated on maximum for 4 to 8 hours in order to fully burn off these coatings. After this period the odours should then disappear.

If the odours persists, please contact your installer for advice.

- 9.2 During the first few hours of burning there may be discolouration of the flames. This will also disappear after a short period of use.

10. Servicing

- 10.1 The appliance must be serviced every 12 months by a qualified GasSafe Engineer. In all correspondence always quote the Model number and the Serial number which may be found on the Commissioning Checklist (Page 3).

11. Ventilation

- 11.1 Any purpose provided ventilation should be checked periodically to ensure that it is free from obstruction.

12. Installation Details

- 12.1 Your installer should have completed the commissioning sheet at the front of this book. This records the essential installation details of the appliance. In all correspondence always quote the Model number and Serial number.

13. Hot Surfaces

- 13.1 Parts of this appliance become hot during normal use.
- 13.2 Regard all parts of the appliance as a working surface, except for the slider handle.
- 13.3 Provide a suitable fireguard to protect young children and the infirm.

Installation Instructions

Technical Specification

Covering the following models:

Nat Gas	LPG
101-245	101-482

Model	Gas CAT.	Gas Type	Working Pressure	Aeration	Injector	Gas Rate m ³ /h	Input kW (Gross)		Country
							High	Low	
Logic HE CF Log	I _{2H}	Natural Gas G20	20mbar	2 x 6.5mm	170	0.495	5.2	2.5	GB, IE
Logic HE CF Log	I _{3P}	Propane G31	37mbar	-	150	0.192	5.1	2.5	
Efficiency 81% Net (Class 1)									
NO _x Class 5									
Min Flue Size - 5" Diameter									
Min Flue Size - pre cast - 90mm x 183mm (16,500mm²)									
Minimum Flue Specification = T250/N2/O/D/1									
Gas Inlet - 8mm									

i The net efficiency of this appliance has been measured as specified in BS7977-1:2009 and the result after conversion to gross using the appropriate factor from Table E4 of SAP 2012 is 75.5%. The gross efficiency value may be used in the UK Government's Standard Assessment Procedure (SAP) for energy rating of dwellings.

PACKING CHECKLIST

Qty Description	Fixing Kit containing:
Log Version 1 x Log Set 1 x Lava Rock	1 x Instruction Manual 1 x Embaglow 4 x Wood Screw 1 x Cable Retention Kit 1 x 1.7m Silicone Seal 4 x Steel Expansion Plug 4 x Eye Bolts 1 x 9v Battery

Installation Instructions

Technical Specification

Complete Front Options

FRONT	Slide Control
DESIGNIO 2	901-539, 901-580, 901-643
TEMPO	901-385, 901-403, 901-414
WINCHESTER	901-369, 901-372

Frame & Front Combinations

FRAMES		
FINISH	Box Profil2 Frame *	Arts2 Frame *
Matt Black	901-272	901-167
Polished Brass Effect	901-286	-
Polished Steel Effect	901-299	-
Brushed Steel Effect	901-310	-
Polished Brass	-	901-194
Polished Stainless	-	901-206
Brushed Stainless	-	901-214

FRONTS					
FINISH	Arts Front	Wave Front	Chartwell Front	Holyrood Front	Spanish Front
Matt Black	901-425	901-024	901-159	912-020	912-083
Polished Brass Effect	901-530	901-061	901-164	912-226	912-160
Highlight Polished	901-296	901-092	901-185	912-257	912-127
Polished Chrome	901-476	901-083	901-170	912-392	912-216

* A Box Profil2 frame or Arts2 frame must be used in conjunction with an Arts, Wave, Chartwell, Holyrood, or Spanish front.

Installation Instructions

Technical Specification

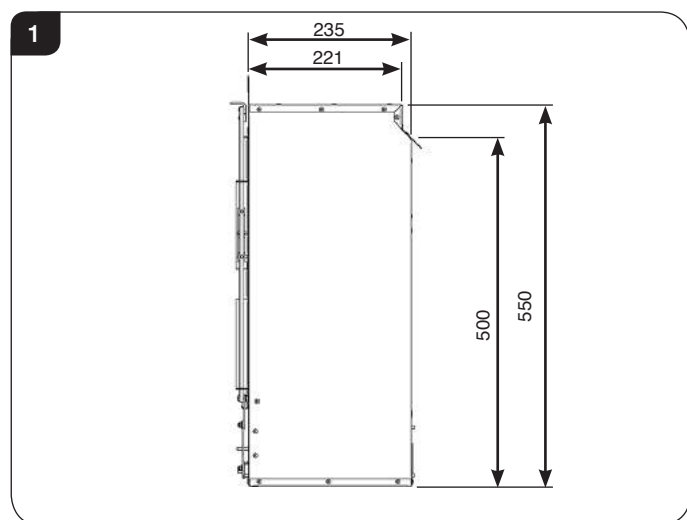

OVERALL EXTERNAL DIMENSIONS SIDE VIEWS

MINIMUM DEBRIS COLLECTION SPACE REQUIREMENTS (EXISTING MASONRY CHIMNEYS OR PREFABRICATED METAL FLUE BOX)

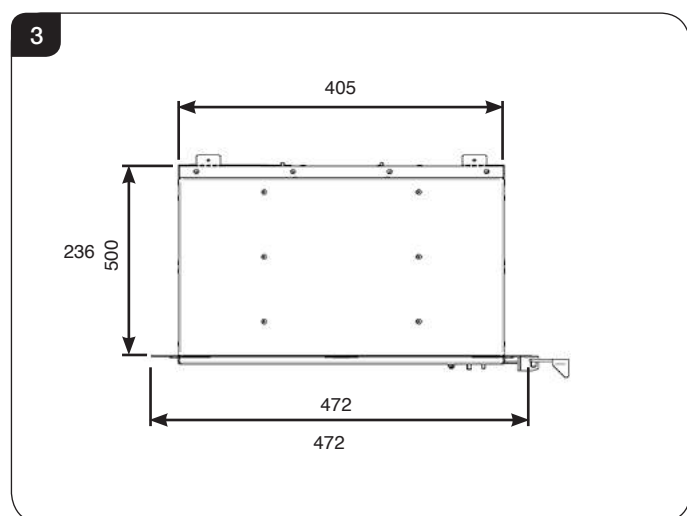
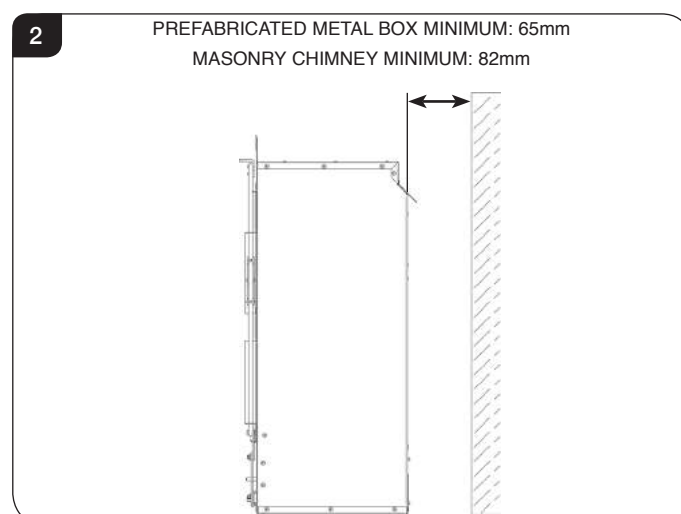

OVERALL EXTERNAL DIMENSIONS PLAN VIEW

Installation Instructions

Site Requirements

1. Flue & Chimney Requirements

- 1.1 The chimney or flue system must comply with the rules inforce, and must be a minimum of 125mm (5") in diameter.

The appliance can also be fitted into a LFE type (non recessed) metal flue box with a 5" (125mm) diameter prefabricated metal flue system or flexible liner. Refer to Diagram 1, Pre Fab Metal Box for dimensions.

* Class 1 flues. Chimneys over 9" x 9" must be lined.

- 1.2 The minimum effective height of the flue or chimney must be 3 m (10ft).
- 1.3 The chimney or flue must be free from any obstruction. Any damper plates should be removed or secured in the fully open position, and no restrictor plates should be fitted.
- 1.4 The chimney should be swept immediately before installing the appliance, but it need not be swept if you can see the chimney is clean and free from obstruction throughout.
- 1.5 Ensure that there is a smooth taper transition from the fireplace opening into the chimney or flue.
- 1.6 The flue pull should be checked prior to installation of the appliance. Apply a smoke pellet to the flue or chimney opening and ensure that the smoke is drawn into the opening. If there is not a definite flow, preheat the chimney for a few minutes and re-test the flow.

IF THERE IS STILL NO DEFINITE FLOW, THE CHIMNEY MAY REQUIRE ATTENTION - SEEK EXPERT ADVICE.

2. Appliance Location

- 2.1 This appliance must stand on a non combustible hearth that is at least 12mm thick. If the appliance is greater than 50mm above the floor, then no hearth is required, although due consideration should be given to how the heat may affect the floor material.
- 2.2 **NOTE: It is recommended you construct the back panel of the fireplace from natural materials cut into three or more sections to prevent cracking. Resin-based materials may not be suitable. This appliance is an effective heat producer and attention must be paid to the construction and finish of the fireplace.**
- 2.3 These appliances must be hearth mounted into a into a non-combustible opening to National Standards. The minimum dimensions shall be as shown in Diagram 1.

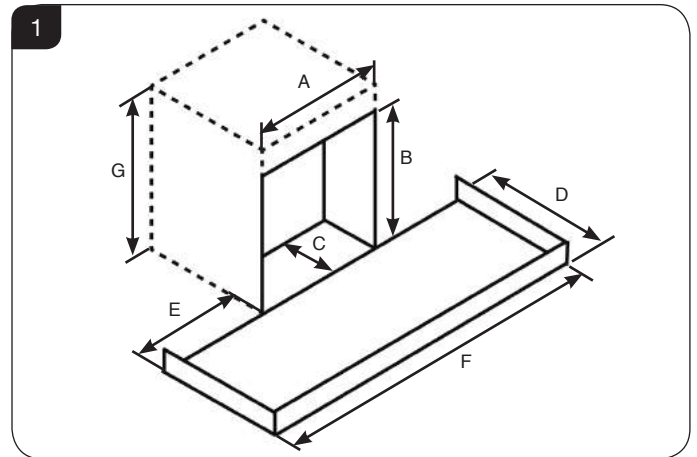

Flue Type Dimension	Brick Built Class 1	Pre Fab Metal Box
A	410	407
B	560	560
C	350	300
D	300	300
E	150	150
F	710	707
G	-	600

Installation Instructions

Site Requirements

- 2.4 This appliance must stand on a non-combustible hearth that is at least 12mm thick and 50mm thick at least at the periphery.

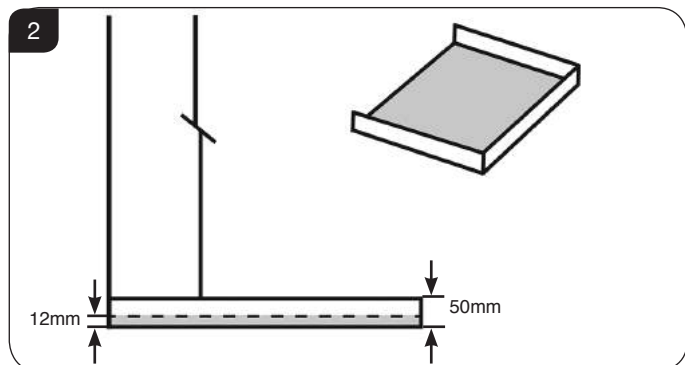

- 2.5 If the appliance is greater than 50mm above the floor, then no hearth is required, although due consideration should be given to how the heat may affect the floor material.
- 2.6 Ensure that no naked flame or incandescent part of the fire bed projects beyond the vertical plane of the fireplace opening.
- 2.7 The appliance must not be installed in any room that contains a bath or shower.
- 2.8 Ensure clearances to combustible materials, see Diagram 3.

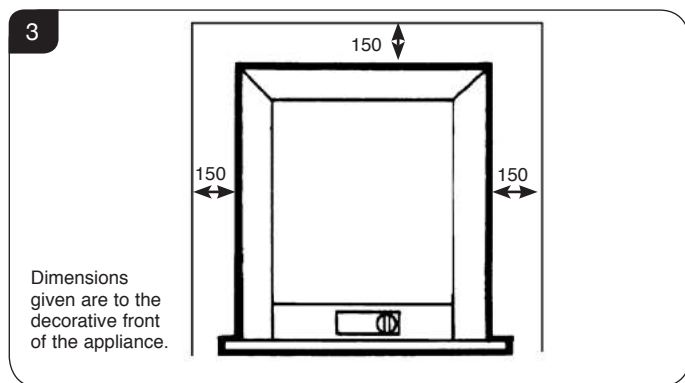

- 2.9 The maximum depth of combustible shelf is 150mm at a minimum height of 150mm above the decorative front. **Refer to the appropriate Frame Instructions regarding additional wall strengthening for the frame.**

3. Gas Supply

- 3.1 Make sure local distribution conditions (identification of the type of gas and pressure) and the adjustment of the appliance are compatible before installation.
- 3.2 Ensure the gas supply delivers the required amount of gas and is in accordance with the rules in force.
- 3.3 This appliance is supplied complete with a factory fitted isolation device incorporated into the inlet connection, no further isolation device is therefore required.

4. Ventilation

IMPORTANT: Ensure any national ventilation requirements are taken into account during installation of the appliance.

- 4.1 This appliance has a nominal input not exceeding 7.0kW and therefore does not normally require any additional permanent ventilation. If, however, spillage is detected when commissioning the appliance, there may be insufficient natural ventilation and additional ventilation may be required.

FOR THE REPUBLIC OF IRELAND REFER TO THE RULES IN FORCE FOR VENTILATION REQUIREMENTS.

AIR VENTS MUST NOT BE RESTRICTED.

Installation Instructions

1. Safety Precautions

- 1.1 For your own and other's safety, you must install this appliance according to local and national codes of practice. Failure to install the appliance correctly could lead to prosecution. **Read these instructions before installing and using this appliance.**
- 1.2 These instructions must be left intact with the user.
- 1.3 Do not attempt to burn rubbish on this appliance.
- 1.4 Keep all plastic bags away from young children.
- 1.5 Do not place any object on or near to the appliance and allow adequate clearance above the appliance.

IF THE APPLIANCE IS EXTINGUISHED OR GOES OUT IN USE, WAIT 3 MINUTES BEFORE ATTEMPTING TO RELIGHT THE APPLIANCE.

- 1.6 The appliance is fitted with an oxygen sensitive pilot that will act to cut off the gas supply to the appliance in the event of incorrect operation of the flue. If the system acts to shut off the gas supply, this indicates that there is insufficient flue pull. Continued operation of this safety device means that there may be a serious problem with the flue system, and this should be inspected by a qualified gas engineer. **Do not use the appliance until an engineer says it is safe to do so.** The oxygen sensitive pilot must not be tampered with. Use only genuine Gazco replacement parts when servicing the appliance - refer to Servicing section.



IMPORTANT: REFER TO DATA BADGE AND TECHNICAL SPECIFICATION AT THE FRONT OF THE MANUAL TO ENSURE THE APPLIANCE IS CORRECTLY ADJUSTED FOR THE GAS TYPE AND CATEGORY APPLICABLE IN THE COUNTRY OF USE.

FOR DETAILS OF CHANGING BETWEEN GAS TYPES REFER TO SERVICING, SECTION 13, REPLACING PARTS.

Unpacking

- 1.7 Remove the appliance from its packaging, and check that it is complete and undamaged.

Put the loose ceramic parts to one side so that they are not damaged during installation.

2. Installation of the Gas Supply

For specific gas types and working pressures see Technical Specifications, page 8.

TO CHANGE FROM ONE GAS TYPE TO ANOTHER A CONVERSION KIT AND DATA BADGE WILL BE REQUIRED. SEE SECTION 13 REPLACING PARTS.

- 2.1 Before installation, ensure that the local distribution conditions (identification of the type of gas and pressure) and the adjustment of the appliance are compatible. See Technical Specification on page 8.
- 2.2 Ensure that the gas supply is capable of delivering the required amount of gas and is in accordance with the rules in force. Please refer to the technical specification for the correct working pressure for the gas used.
- 2.3 Soft copper tubing and soft soldered joints can be used but must not be closer than 50mm (2") to the underside of the burner.
- 2.4 An isolation device is provided with the appliance.
- 2.5 All supply gas pipes must be purged of any debris that may have entered, prior to connection to the appliance.
- 2.6 This appliance is intended for use on a gas installation with a governed meter.

3. Removing the Glass Frame

- 3.1 Remove the glass frame by removing the 4 screws in the retaining bracket, see Diagram 1.
- 3.2 Tilt the top of the glass frame forward and disengage the lower location tabs from the slots in the firebox, see Diagram 1, Detail A. Place carefully to one side.

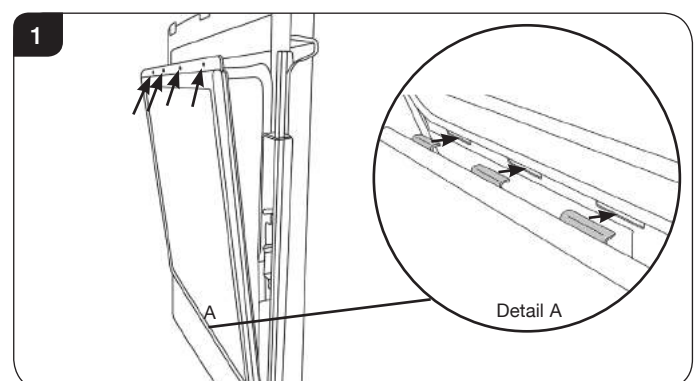

Installation Instructions

4. Installation of the Appliance

4.1 Ensure that the fireplace opening is in compliance with Section 2 Site Requirements.

4.2 There are 2 methods of installation:

4a) Cable Retention method.

4b) Screw Fixing Method

4a) Cable Retention Method

For this method of installation it will be necessary to remove the main burner and control assembly.

4a.1 Remove the 2 screws at the front of the burner tray, see Diagram 2.

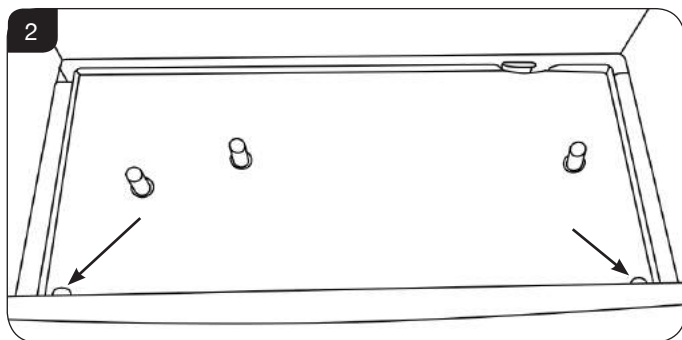

4a.2 Lift the left hand side of the burner tray to disengage from the injector, before lifting the right hand side, see Diagram 3.

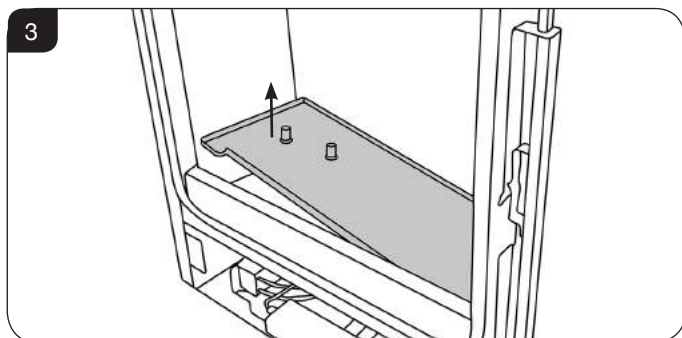

4a.3 Slide the burner tray fully to the left and remove through the front of the firebox, see Diagram 3.

4a.4 Remove the 2 wing nuts, see Diagram 4.

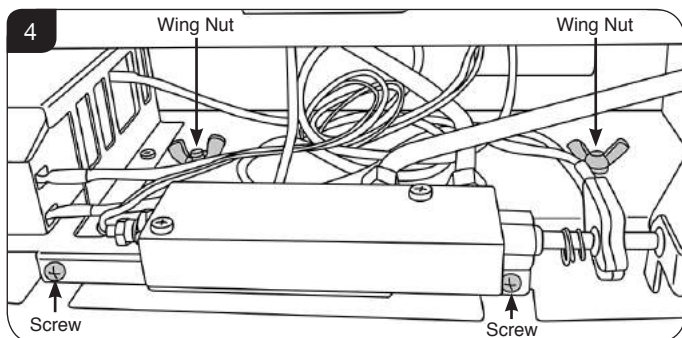

4a.5 Remove the 2 screws, see Diagram 4.

4a.6 Remove the M4 lock nut and spacer securing the slider arm to the appliance and loosen the 2 nuts, see Diagram 5.

Ensure that the spacer is retained and replaced when the control assembly is reinstalled.

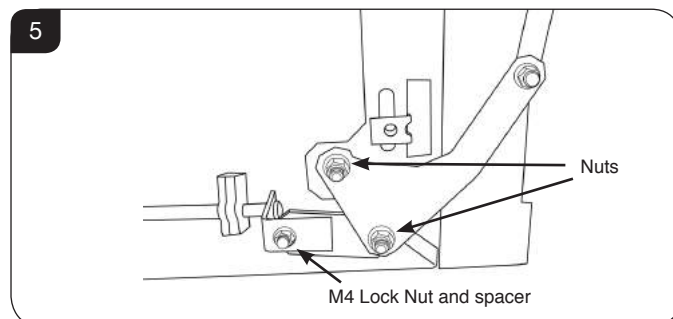

4a.7 Lift the control assembly, move to the left and angle forward to remove through the front of the firebox, see Diagram 6.

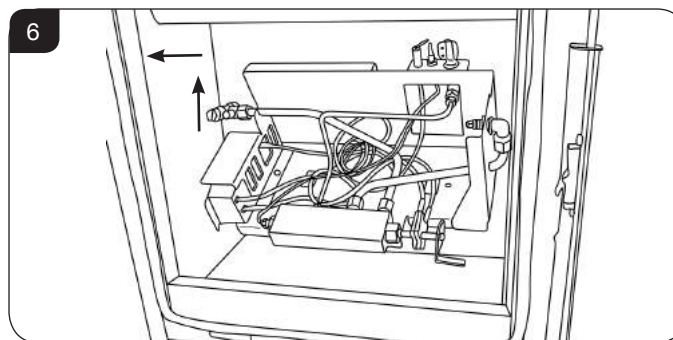

Take care not to damage the liners.

4a.8 Undo the screws and remove the convector air panel, see Diagram 7.

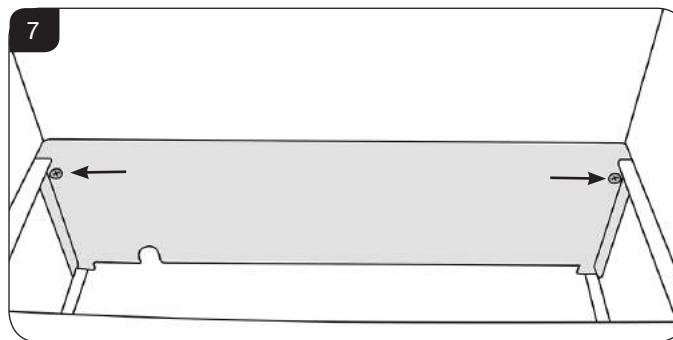

4a.9 Remove the 2 knockout holes on the rear of the box using a sharp hammer blow, see Diagram 8.

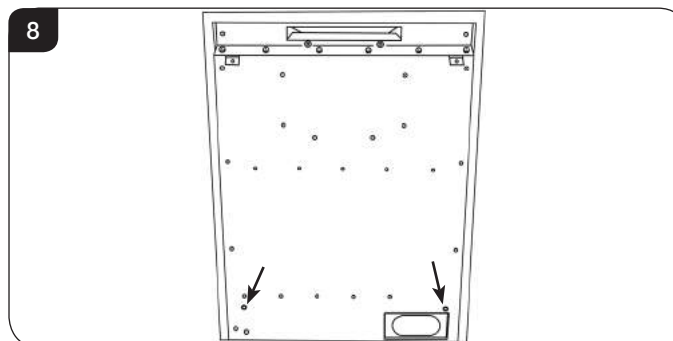

Installation Instructions

- 4a.10 Remove the backing from the self-adhesive silicone sealing strip and apply to the rear flange of the firebox ensuring that it is positioned as close to the outer edge as is practically possible, see Diagram 9, Arrow A.

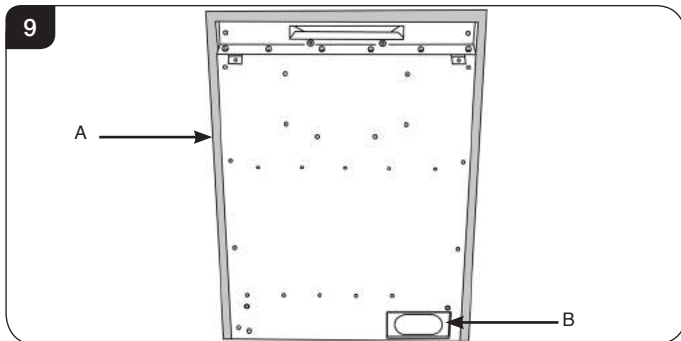

- 4a.11 Gas pipe entry must come through the rear of the box on the right-hand side. The rubber seal must be cut using a sharp knife to allow the isolating elbow to pass through it. Ensure the rubber is not damaged when doing this, see Diagram 8, Arrow B.

A means of isolation is provided with the appliance. This must be fitted to the supply pipe prior to installing the firebox.

- 4a.12 Mark the position of the 4 fixing holes on the rear of the fireplace opening and drill the holes using a 7mm masonry drill bit. Insert the 4 steel expansion plugs and screw the eyebolts in as far as possible leaving the eye horizontal, see Diagram 10.

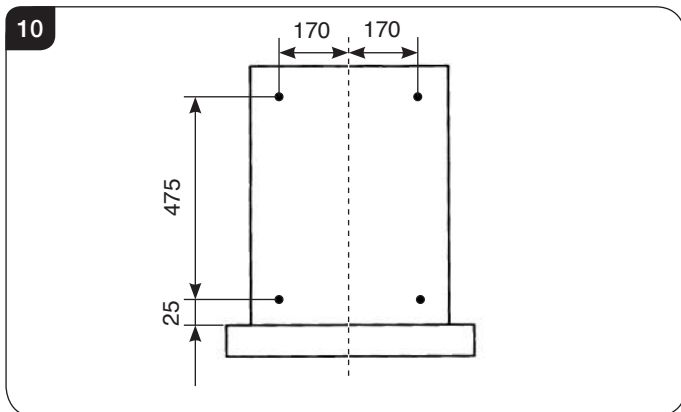

- 4a.13 Pass the 2 cables through the holes in the brackets on the back of the firebox and pull taut so that the stop ends sit tightly against the top of the brackets, see Diagram 11.

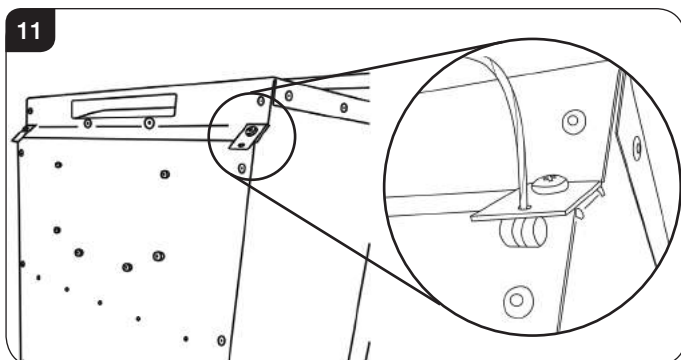

- 4a.14 Pass the cables vertically through the 2 sets of eyebolts, see Diagram 12.

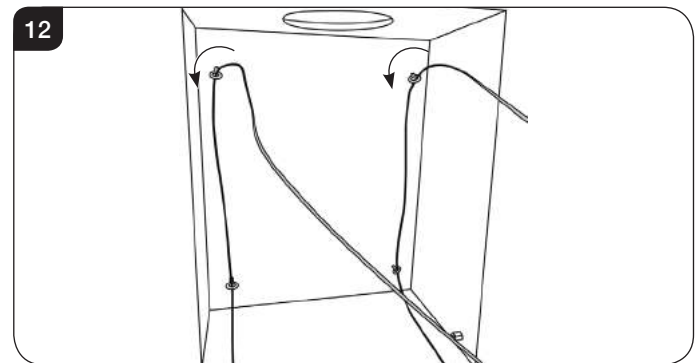

- 4a.15 Thread the ends through the holes in the lower back of the firebox. Pass the gas supply pipe through the hole in the rubber seal and push the appliance into place.

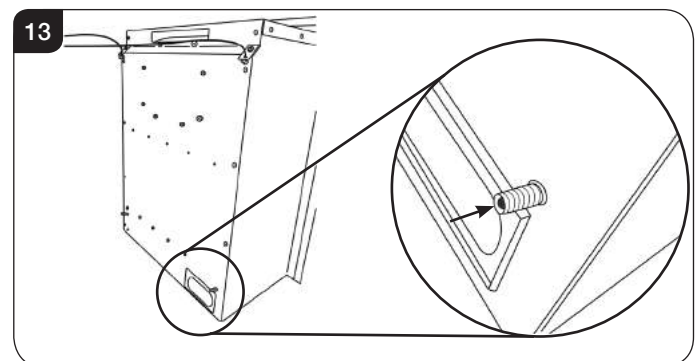

- 4a.16 Thread the cables through the tensioner bolts and push the threaded portions through the holes in the firebox so that the lock nut sits against the back wall (ensure that the nut is screwed fully up to the head of the tensioner to allow maximum adjustment).

- 4a.17 Slide the locking nipples onto the cables, pull the cables taut and tighten the locking screw. Adjust the lock nuts using a 10mm spanner until the silicone sealing strip forms a tight seal between the fireplace opening and the firebox flange, see Diagram 14.

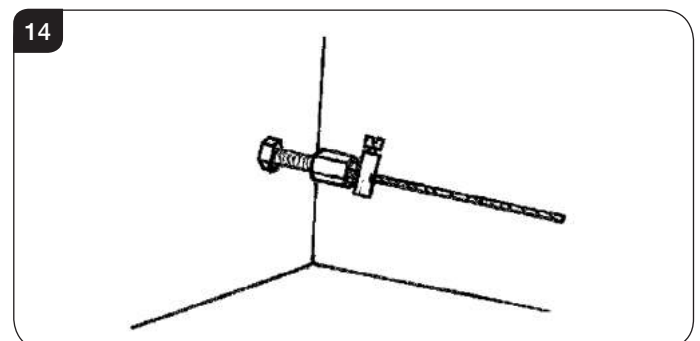

- 4a.18 Coil up the surplus cable and locate in the back of the firebox.

NEVER SHORTEN THE CABLES, THEY WILL BE REQUIRED WHEN SERVICING THE APPLIANCE.

- 4a.19 Replace the lower cover plate.

Note: The cable adjuster may need to be tucked upward in order to fit the lower cover plate.

Installation Instructions

- 4a.20 Replace the control assembly, ensuring the front of locates in front of the tabs on the base of the firebox.

Take care not to damage the liners.

4b) Screw Fixing Method

- 4b.1 Alternatively, this appliance can be secured back to the fireplace opening using the screws and expansion plugs provided.
- 4b.2 Remove the backing from the self-adhesive silicone sealing strip and apply to the rear flange of the firebox ensuring that it is positioned as close to the outer edge as is practically possible, see Diagram 15, Arrow A.

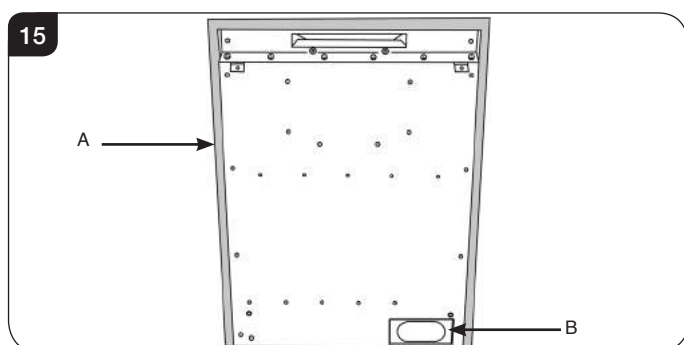

- 4b.3 Place the firebox centrally in the opening and mark the positions of the 4 fixing holes. Drill the holes and insert the 4 expansion plugs, see Diagram 16.

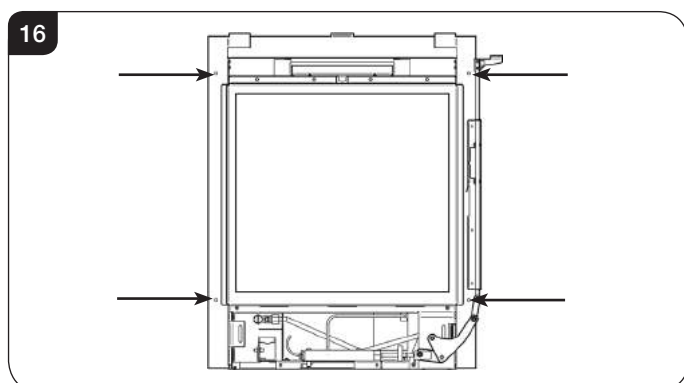

- 4b.4 Offer the firebox into the opening and ensure that the gas supply pipe passes through the rubber seal.
- 4b.5 Secure the appliance through the 4 fixing holes, see Diagram 16.

- 4b.6 Remove the 2 screws at the front of the burner tray, see Diagram 17.

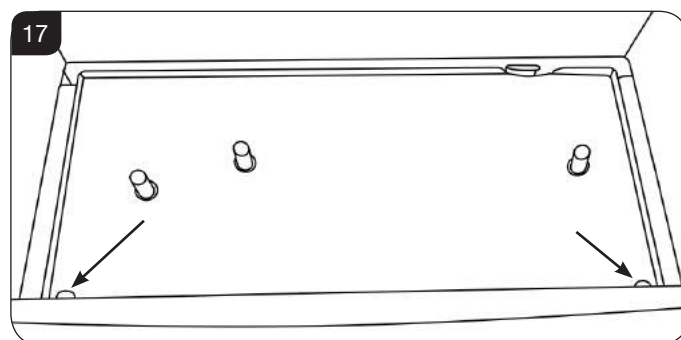

- 4b.7 Lift the left hand side of the burner tray, before lifting the right hand side, see Diagram 18.

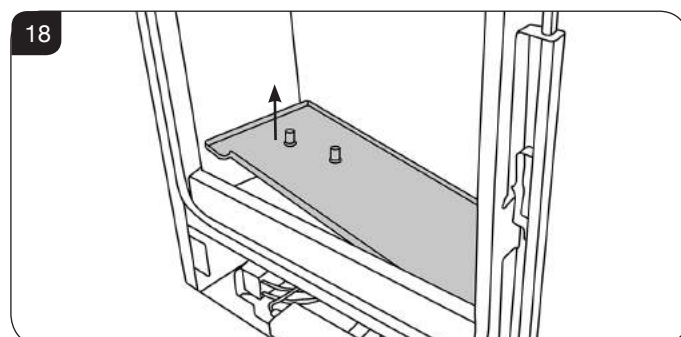

- 4b.8 Slide the burner tray fully to the left and remove through the front of the firebox, see Diagram 18.

5. Gas Supply

- 5.1 Connect the gas supply to the inlet connection on the control assembly and tighten. It may be necessary to support the inlet connection with another spanner whilst tightening this joint, see Diagram 19.

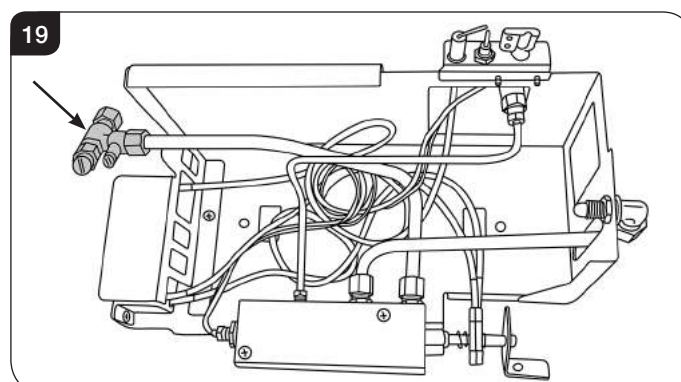

- 5.2 Turn on the gas supply to the appliance and check for leaks.
- 5.3 Remove the pressure test point screw from the inlet connection and connect a suitable "U" gauge manometer.
- 5.4 Carefully refit the main burner.
- 5.5 Light the appliance, turn to maximum and check that the supply pressure is as stated on the databadge. If the pressure varies significantly from that on the data badge, this may indicate a supply problem and will require immediate attention.

Installation Instructions

- 5.6 Turn the appliance off and remove the main burner.
- 5.7 Disconnect the "U" gauge and replace the pressure test point screw. Check the pressure test point screw for leaks.
- 5.8 Carefully refit the main burner.

6. Arrangement of the Fuel Bed

Advice on handling and disposal of fire ceramics



The fuel effect and side panels of this appliance are made from Refractory Ceramic Fibre (RCF), a material which is commonly used for this application.

Protective clothing is not required when handling these articles, but we recommend you follow normal hygiene rules of not smoking, eating or drinking in the work area and always wash your hands before eating or drinking.

To ensure that the release of RCF fibres are kept to a minimum, during installation and servicing a HEPA filtered vacuum is recommended to remove any dust accumulated in and around the appliance before and after working on it. When servicing the appliance it is recommended that the replaced items are not broken up, but are sealed within heavy duty polythene bags and labelled as RCF waste.

RCF waste is classed as stable, non-reactive hazardous waste and may be disposed of at a licensed landfill site.

Excessive exposure to these materials may cause temporary irritation to eyes, skin and respiratory tract; wash hands thoroughly after handling the material.

7. Log Layout

LOGS MUST BE POSITIONED ACCORDING TO THE FOLLOWING INSTRUCTIONS TO GIVE THE CORRECT FLAME EFFECT.

- 7.1 Ensure the burner tray is clean and free from any debris, see Diagram 20.

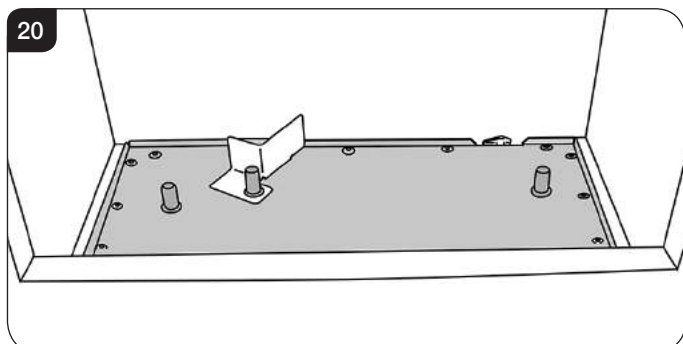

- 7.2 Place Log A in position on the 2 locating pins, see Diagram 21.

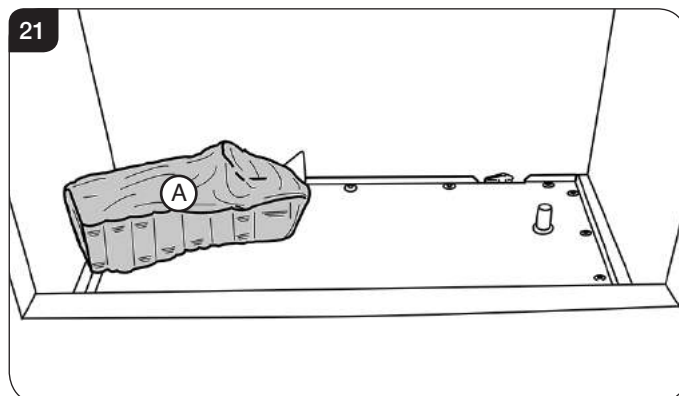

- 7.3 Spread the Lava Rock evenly over the fuel bed and around Log A, see Diagram 22.

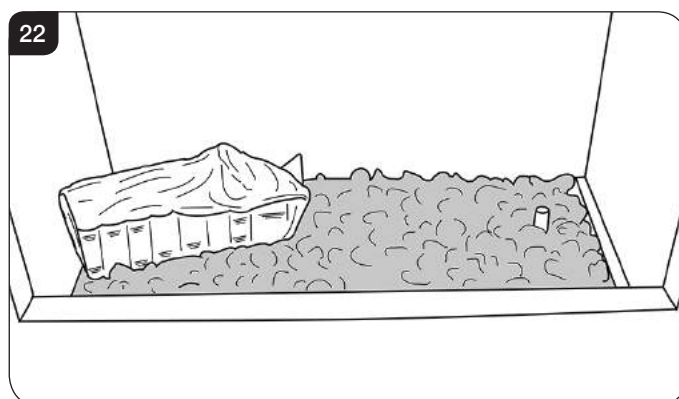

- 7.4 Log B is positioned on the right hand locating pin, and rests against the back liner, see Diagram 23.

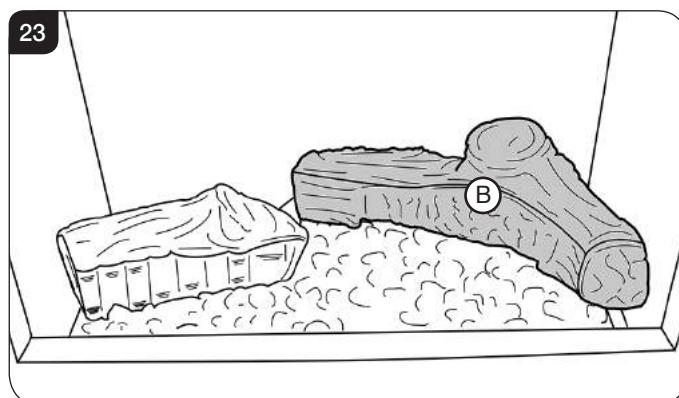

Installation Instructions

- 7.5 TLog C rests on Log A and the front tray with the locating pin facing up, see Diagram 24.

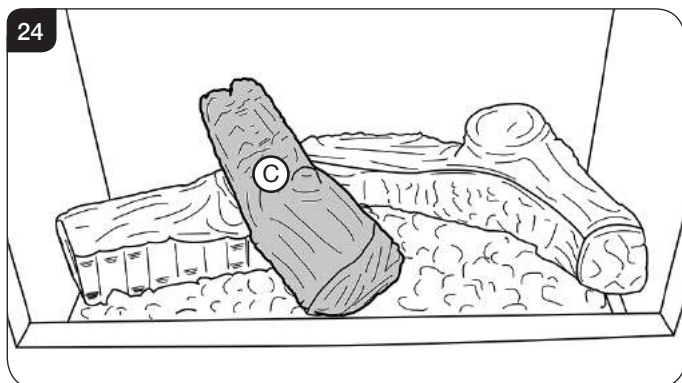

- 7.6 Log D fits onto the locating pin and rests on Log B, see Diagram 25.

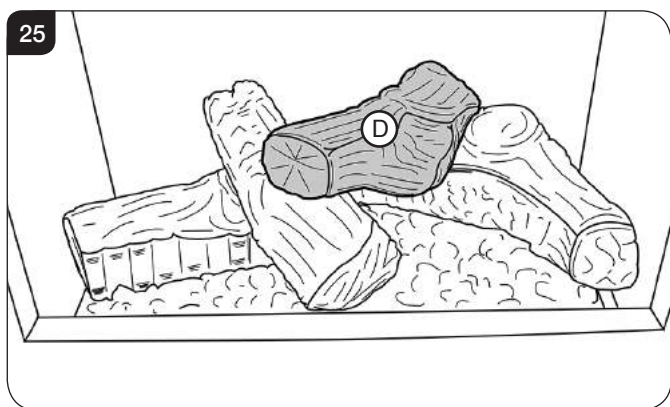

- 7.7 Position the 2 embers in the front right and back left corners, see Diagram 26.

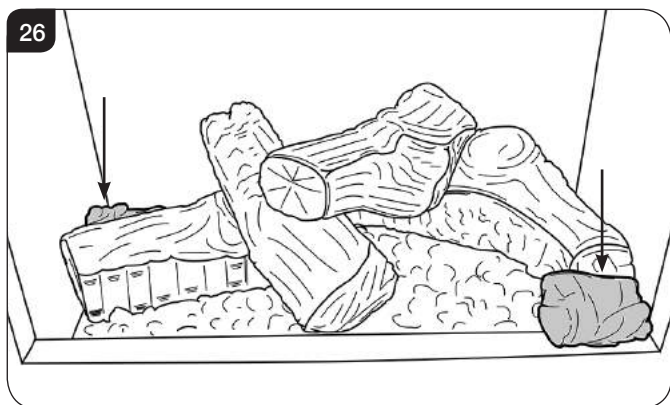

- 7.8 Spread a liberal amount of the Embaglow fibres provided on the sections highlighted, see Diagram 27.

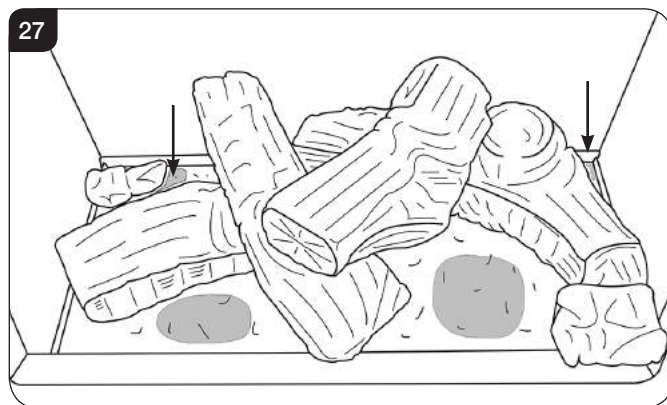

8. Fitting the Glass Frame

- 8.1 Ensure that the rope seal on the box is intact, then locate the glass frame location tabs into the slots on the firebox, see Diagram 28, Detail A.
- 8.2 Secure the glass frame using 4 screws in the retaining bracket, see Diagram 28. Replace ALL of the glass frame securing screws ensuring that a screw is present in all fixing slots.

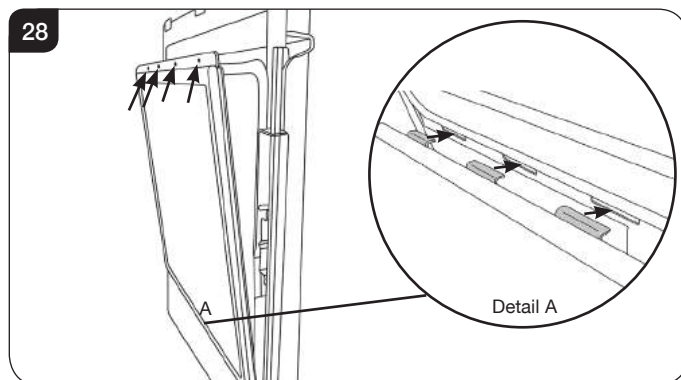

NEVER OPERATE THE APPLIANCE WHEN THE GLASS FRAME IS REMOVED OR BROKEN.

Refer to the separate decorative front Instructions to replace the front on the appliance.



UNDER NO CIRCUMSTANCES SHOULD THE APPLIANCE BE USED IF ANY OF THE GLASS FRAME RETAINING SCREWS ARE LOOSE OR MISSING.

Installation Instructions

9. Operating the Appliance

This appliance is operated using the slide control on the top right hand side of the decorative front.

When the appliance is OFF the slide control will be at the highest point, see Diagram 29.

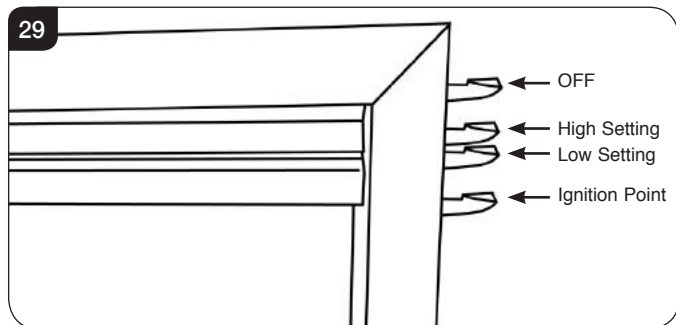

Lighting the Pilot

- 9.1 Push the slide control down as far as possible to its lowest point, see Diagram 29, this is the ignition point.

Keep the slide control pressed down for 5 seconds to ensure the pilot is lit. Then release.

The appliance should light on its lowest setting.

- 9.2 When released the slide control automatically raises to a natural stop point, see Diagram 29.

Repeat the above steps if the appliance does not light.

- 9.3 If, after repeating the above steps the pilot does not light, contact your Retailer or Installer.

Adjusting the Flame height

- 9.4 Increase the flame height and temperature by carefully moving the slide control up until the next stop point is felt, see Diagram 29. This denotes the highest setting.
- 9.5 Carefully move the slide control down to the lower stop point to return to the lowest setting.

YELLOW FLAMES APPEAR WHEN THE APPLIANCE HAS REACHED SUFFICIENT HEAT – (10 TO 20 MINUTES). IF THE APPLIANCE IS EXTINGUISHED OR GOES OUT IN USE, WAIT 3 MINUTES BEFORE TRYING TO RELIGHT.

Switching OFF the Appliance

- 9.6 To turn the appliance off lift the slide control to its highest stop point, see Diagram 29. The pilot goes out.

Commissioning

1. Commissioning

- 1.1 Close all windows and doors to the room, check all controls, and allow appliance to burn on maximum for 5 minutes. Test for spillage of flue products using a smoke match. Pass the lighted smoke match along the top front of the draught diverter, just inside, see Diagram 1.

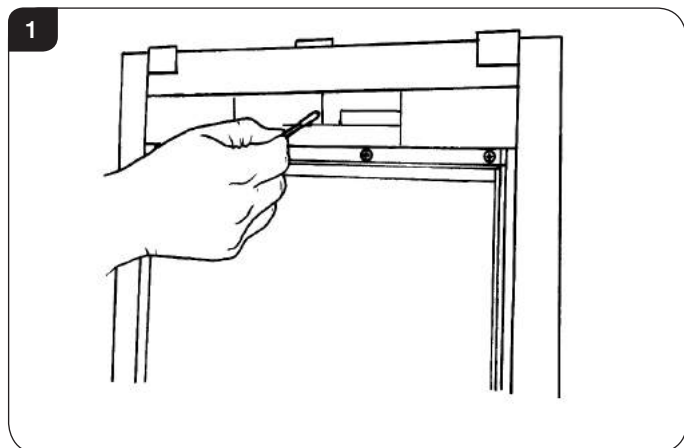

- 1.2 If the appliance spills, run for a further 10 minutes and re-check.

If there are any extractor fans in the room or adjacent rooms, the test must be repeated with the fans running on maximum.

IF SPILLAGE PERSISTS, DISCONNECT THE APPLIANCE AND SEEK EXPERT ADVICE.

- 1.3 Complete the Commissioning Checklist at the front of this manual covering:
- Flue checks
 - Gas checks
 - Fuel effect layout - flame picture
- 1.4 Upon completion of the commissioning and testing of the installation and correct operation of the appliance, the installer must instruct the user how to operate the appliance.
- 1.5 Guide the user through the User Instructions paying particular attention to:
- a) Regular servicing (Section 10 of the User Instructions).
 - b) Ventilation (Section 11 of the User Instructions) - point out the ventilation positions where applicable.
 - c) Hot surfaces (Section 13 of the User Instructions).

For future reference record the installation details on the commissioning sheet on page 3 of these instructions.

Servicing Instructions

Servicing/Fault Finding Charts

1. Servicing Requirements

IMPORTANT – The glass panel on this appliance should be checked for any signs of damage on the front face of the glass panel (scratches, scores, cracks or other surface defects). If damage is observed, the glass panel must be replaced and the appliance must not be used until a replacement is installed. Under no circumstances should the appliance be used if any damage is observed. Please isolate the appliance until a replacement glass panel has been obtained and installed. Replacement glass panels can be purchased from Gazco via the retailer from which the appliance was purchased or any other Gazco distributor.

This appliance must be serviced at least once a year by a competent person.

All tests must be carried out in accordance with the current GasSafe recommendations.

1.1 Before Testing:

- Conduct a gas soundness test for the property ensuring there are no leaks before servicing.
- Check the operation of the appliance before testing.

1.2 Special checks:

- Clean the burner using a vacuum cleaner with a soft brush attachment. Ensure all debris is removed from the burner ports.
- Clean away lint or fluff from the pilot.
- Clean away lint or fluff from under the burner.
- Check the spark gap on the pilot is correct, see Diagram 1.
- Ensure that the glass frame is secured correctly and that all retaining screws are in place.
- Check debris collection space & clean if necessary.

1.3 Correct any faults found during the initial test.

1.4 Re-commission the appliance in accordance with Commissioning Procedures.

1.5 Advise the customer of any remedial work undertaken.

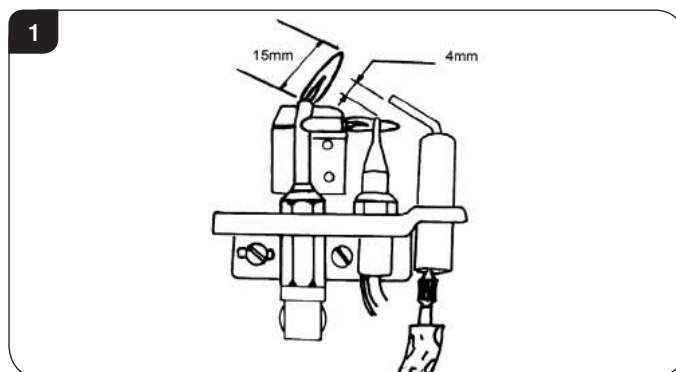

IGNITION FUNCTIONAL CHECK 1

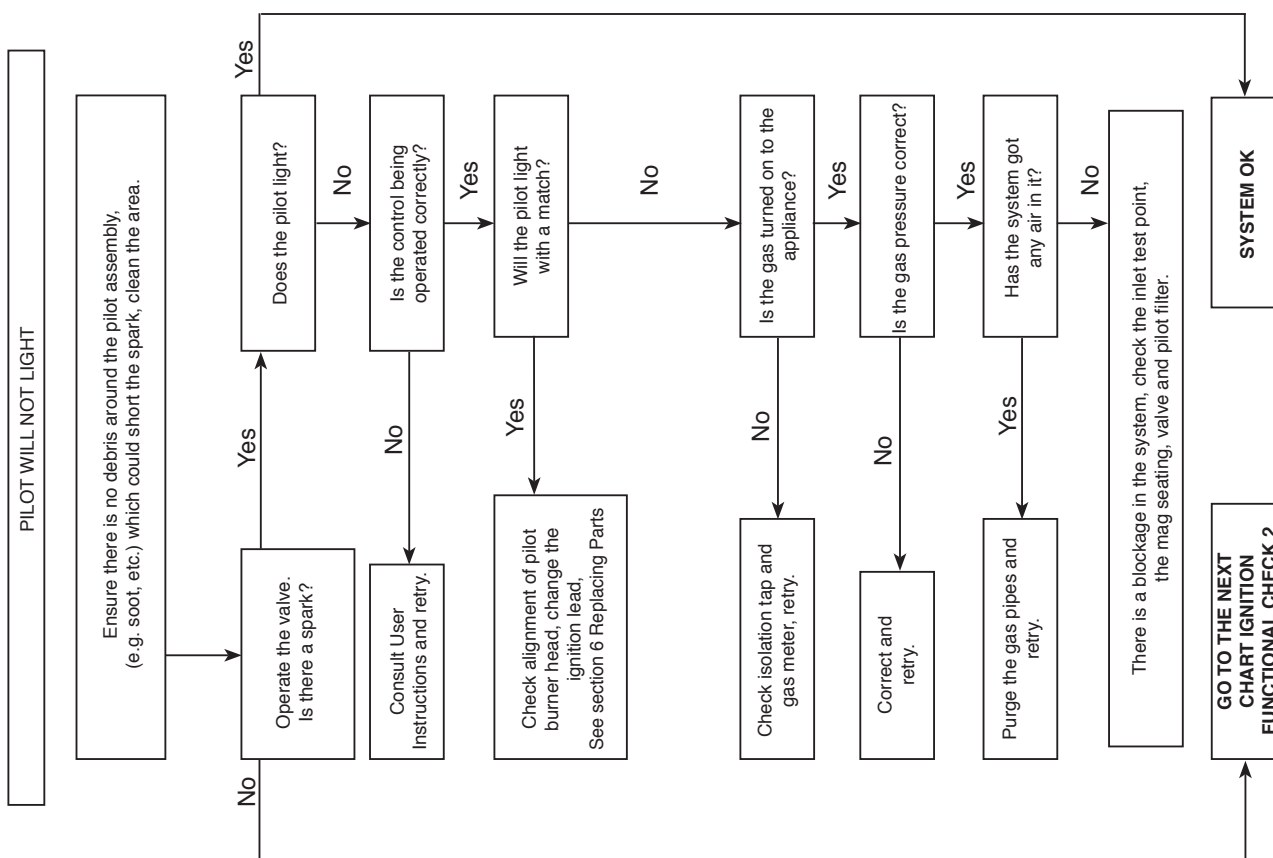

Servicing Instructions

Fault Finding Charts

FLAME FAILURE FUNCTIONAL CHECK 3

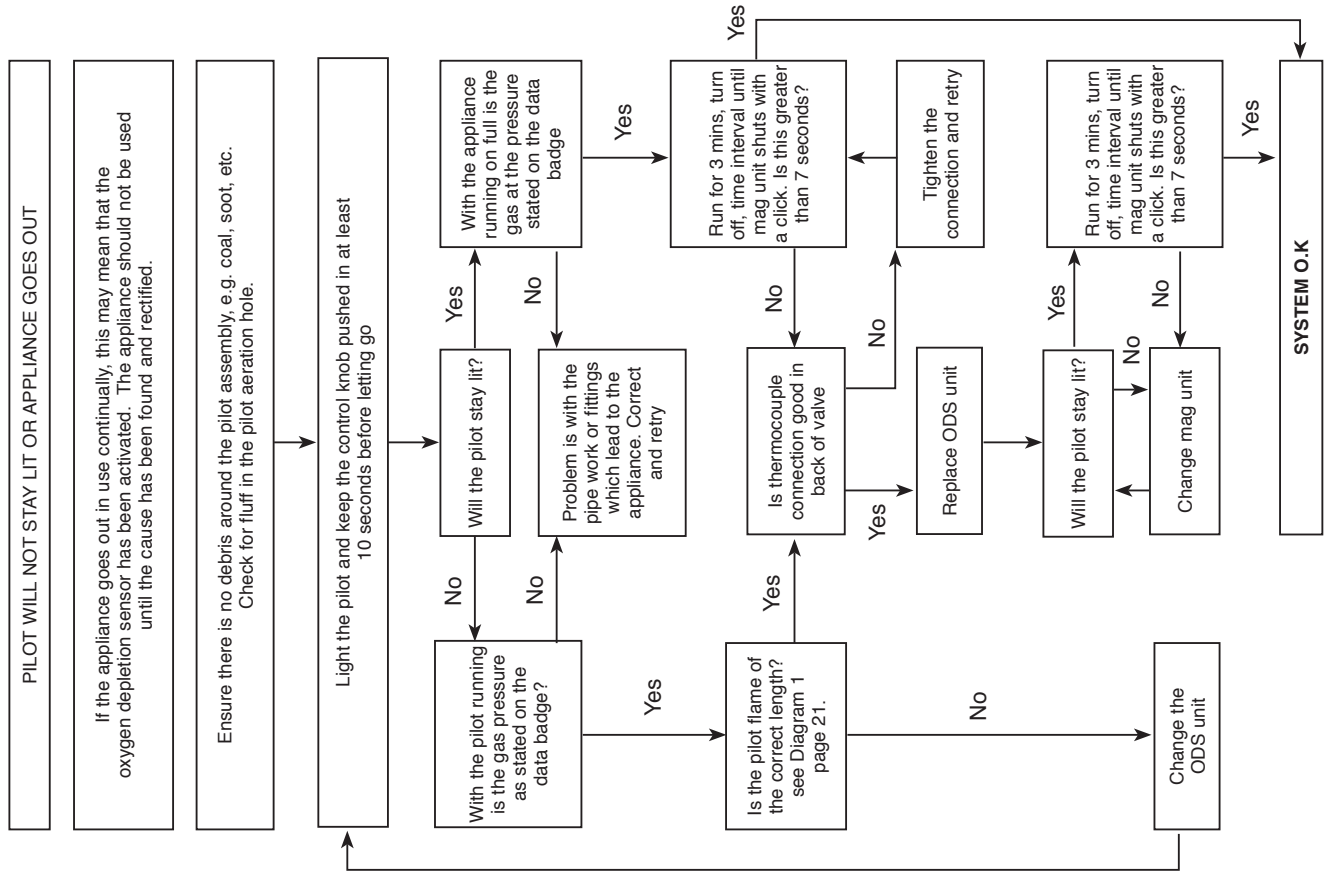

IGNITION FUNCTIONAL CHECK 2 SLIDE CONTROL

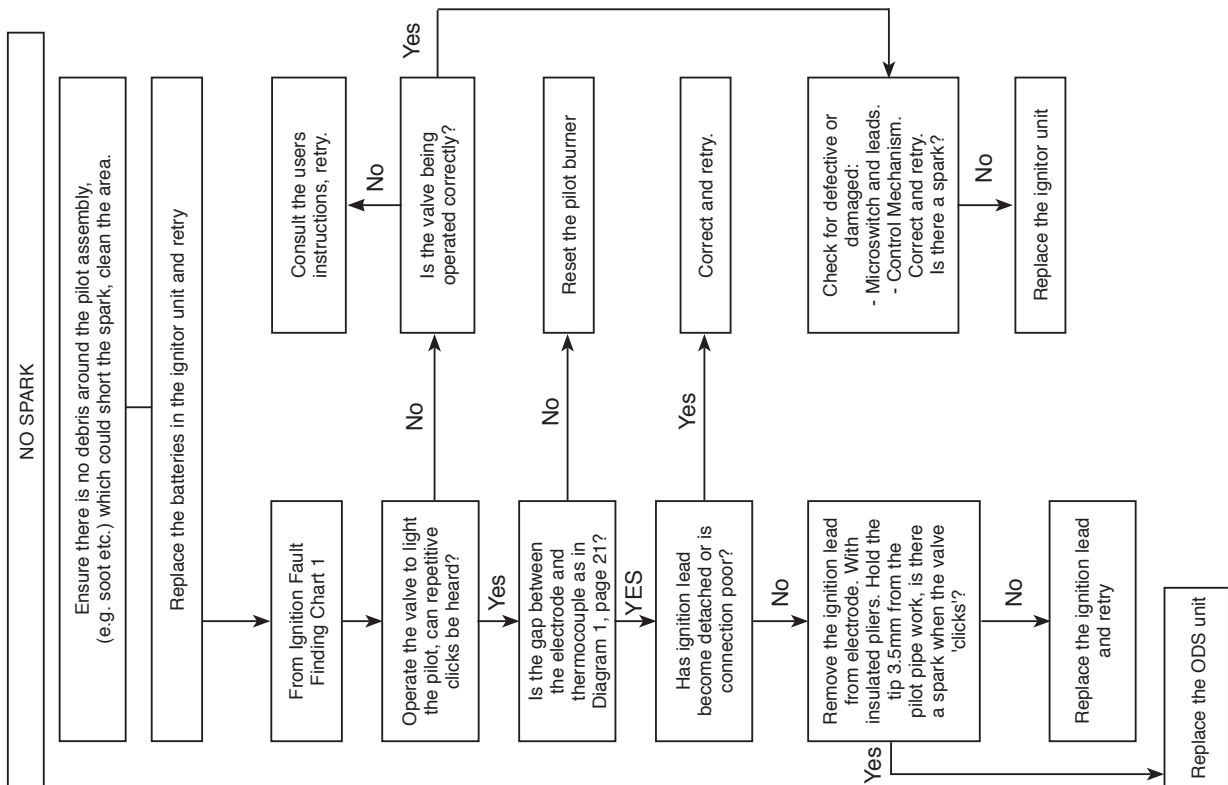

Servicing Instructions - Replacing Parts

1. Servicing

As part of the annual service, the space behind the firebox must be inspected for any debris, which may have fallen down the chimney.

- 1.1 To service the appliance first remove the decorative front. There are 2 screws securing the front to the appliance. Refer to separate instructions.

2. Removing the Glass Frame

- 2.1 Remove the glass frame by removing the 4 screws in the retaining bracket, see Diagram 1.

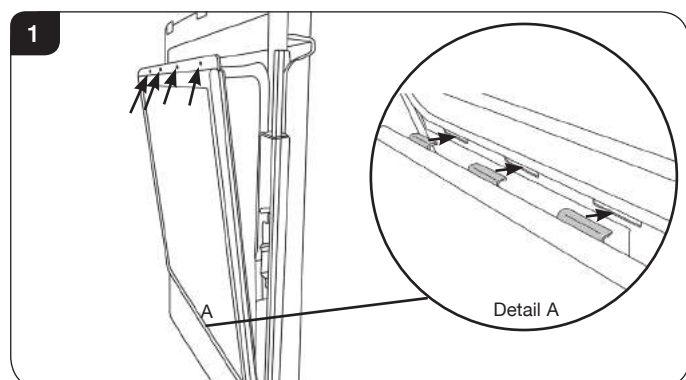

- 2.2 Tilt the top of the glass frame forward and disengage the lower location tabs from the slots in the firebox, see Diagram 1, Detail A. Place carefully to one side.
- 2.3 Remove the logs and Embaglow and place on a dry, clean surface.
- 2.4 The glass frame must be refitted to the appliance following cleaning or servicing. Ensure that the rope seal on the box is intact, then locate the glass frame location tabs into the slots on the firebox, see Diagram 1, Detail A.
- 2.5 Secure the glass frame using 4 screws in the retaining bracket, see Diagram 1. Replace ALL of the securing screws ensuring that a screw is present in all fixing slots.

NEVER OPERATE THE APPLIANCE WHEN THE GLASS FRAME IS REMOVED OR BROKEN.

Refer to the separate decorative front instructions to replace the front on the appliance.



UNDER NO CIRCUMSTANCES SHOULD THE APPLIANCE BE USED IF ANY OF THE GLASS FRAME RETAINING SCREWS ARE LOOSE OR MISSING.

3. Appliance Battery

- 3.1 Remove the battery before carrying out work on this appliance.

Removing the battery:

- 3.2 The battery box is located at the bottom left of the appliance, see Diagram 2.

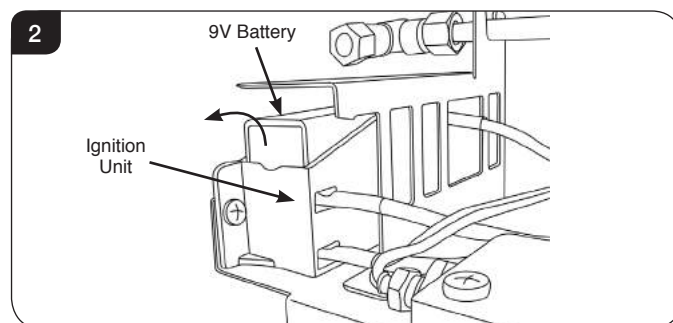

4. Main Burner

- 4.1 Remove the 2 screws at the front of the burner tray, see Diagram 3.

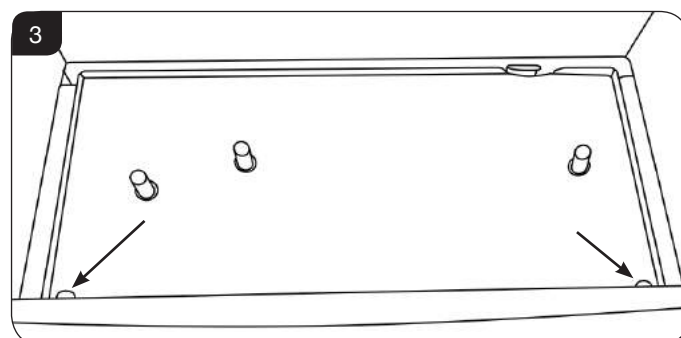

- 4.2 Lift the left hand side of the burner tray, before lifting the right hand side, see Diagram 4.

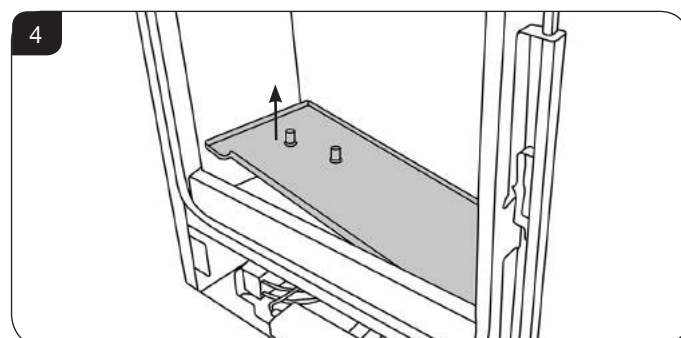

- 4.3 Slide the burner tray fully to the left and remove through the front of the firebox, see Diagram 4.

5. Control Assembly

Isolate and disconnect the gas supply at the Isolation elbow.

- 5.1 Remove the 2 wing nuts, see Diagram 5.

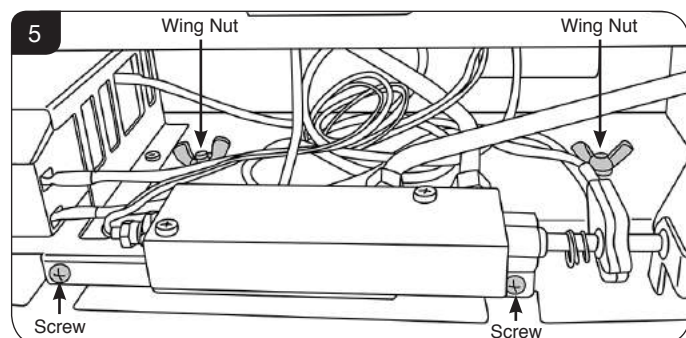

- 5.2 Remove the 2 screws, see Diagram 6.
- 5.3 Remove the M4 lock nut and spacer securing the slider arm to the appliance and loosen the 2 nuts, see Diagram 5. **Ensure that the spacer is retained and replaced when the control assembly is reinstalled.**

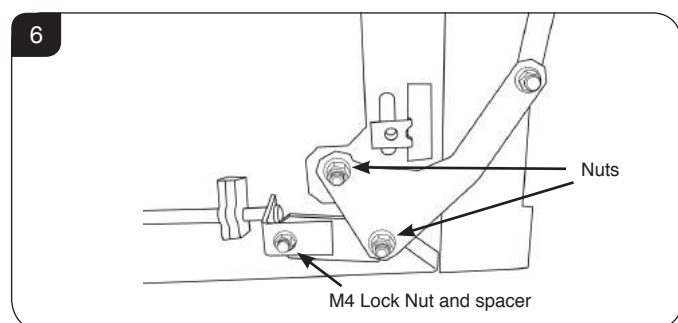

- 5.4 Lift the control assembly, move to the left and angle forward to remove through the front of the firebox, see Diagram 7.

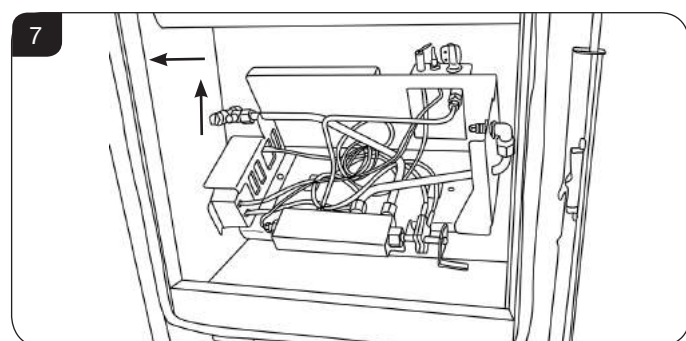

Take care not to damage the liners.

6. Ignition Lead

- 6.1 Disconnect the ignition lead from the ignition unit and the pilot unit, see Diagram 8.

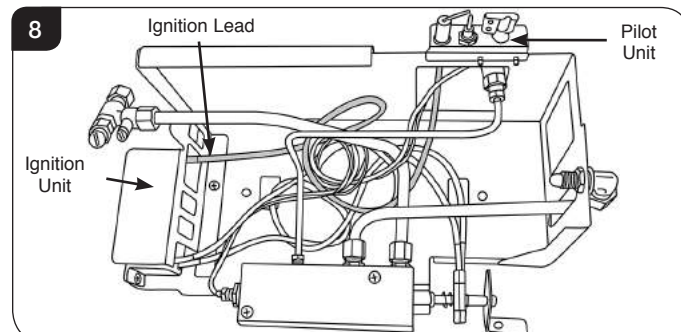

- 6.2 Remove the vidaflex from the old ignition lead.
- 6.3 Refit the vidaflex cover over the new ignition lead and fit following the same route as the old one.
- 6.4 Refit the burner.
- 6.5 Check the operation of the new ignition lead.
- 6.6 Reassemble the appliance.

7. ODS Pilot Unit

Note: The pilot unit on the appliance is a non serviceable unit due to the complex nature of its manufacture.

Replacement of the complete unit must be carried out when one of the following items becomes faulty:

- Pilot injector
- Ignition electrode
- Thermocouple

Remove the main burner, see Section 4.

- 7.1 Gently pull the ignition lead off the electrode, see Diagram 9, Arrow A.
- 7.2 Remove the 2 screws securing the pilot assembly, see Diagram 9, Arrow B.

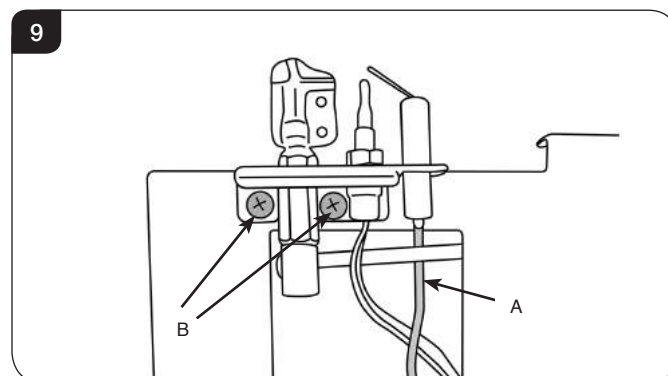

7.3 Undo the thermocouple connection from the gas valve, see Diagram 10.

7.4 Undo the pilot pipe from the pilot unit, see Diagram 10, arrow A and from the gas valve, see Diagram 10, arrow B.

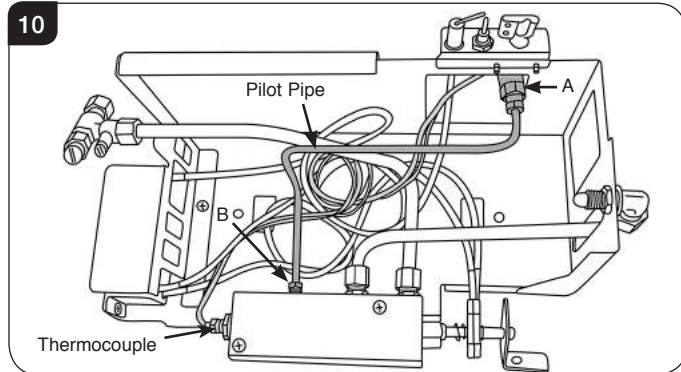

7.5 Replace with a new pilot assembly and check the spark gap, see Diagram 11.

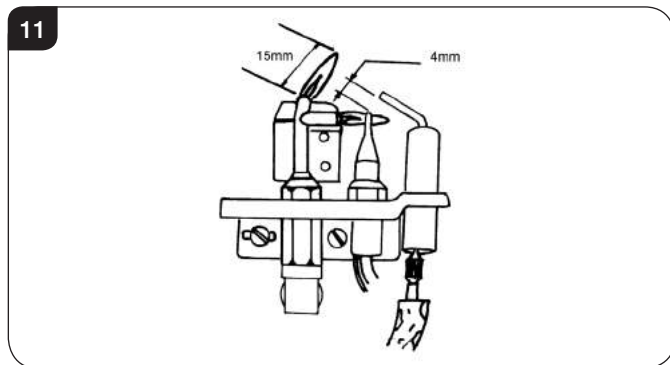

7.6 After reassembly check for gas soundness and carry out a flame failure functional check as detailed in the Fault Finding chart, especially the time it takes for the mag unit to close.

8.1 To remove the gas valve first remove the thermocouple, see Diagram 12, Arrow A.

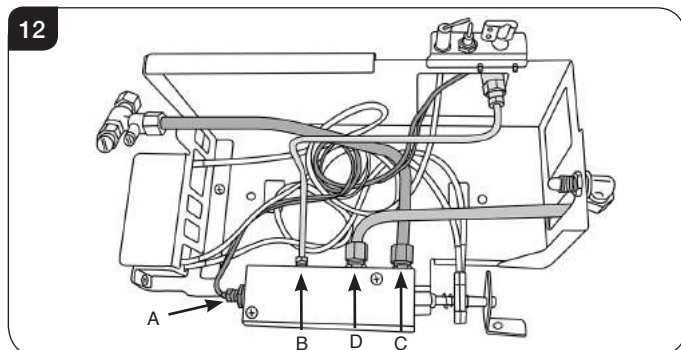

8.2 Undo the pilot pipe from the gas valve, see Diagram 12, Arrow B.

8.3 Undo the inlet pipe from the gas valve, see Diagram 12, Arrow C.

8.4 Undo the main injector feed pipe from the gas valve, see Diagram 12, Arrow D.

8.5 Disconnect the 2 leads from the micro-switch, see Diagram 13.

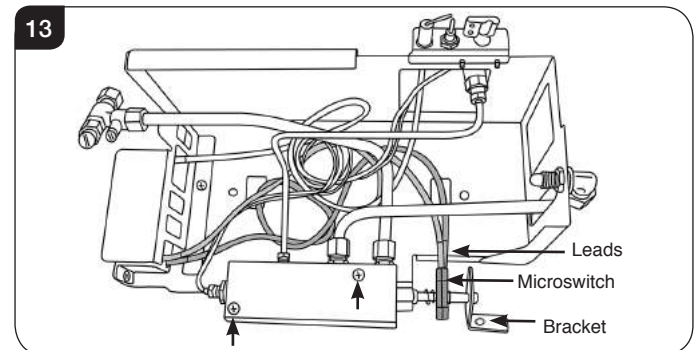

8.6 Undo the screw from the end of the spindle and remove the bracket, see Diagram 13. Ensure bracket is replaced during reassembly.

8.7 Remove the two screws from the gas valve, see Diagram 13.

8.8 Replace in reverse order.

8.9 Check for gas leaks.

9.1 Disconnect the two leads from the Micro-Switch, see Diagram 13.

9.2 Remove the screw, bracket, washer & spacer from the Micro-Switch spindle, see Diagrams 14 & 15.

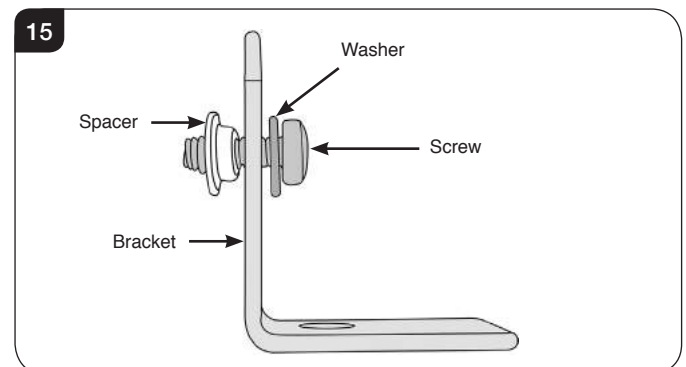
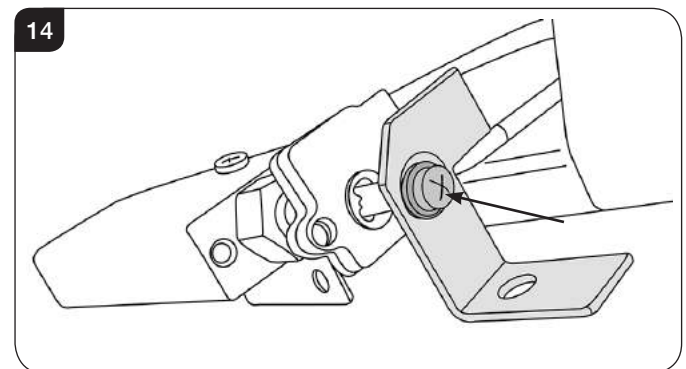

When replacing ensure that the components are assembled in the same order.

- 9.3 Remove the circlip from the spindle, see Diagram 16.

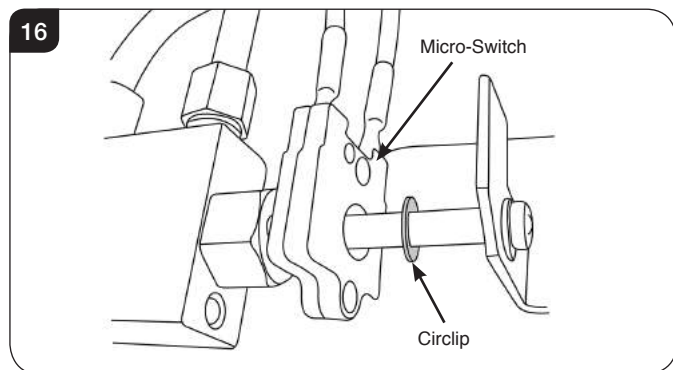

- 9.4 Replace the micro-switch.

Reassemble in reverse order.

- 10.1 Undo the compression nut from the feed pipe, see Diagram 17, Arrows D

- 10.2 Undo the lock nut from the injector, see Diagram E.

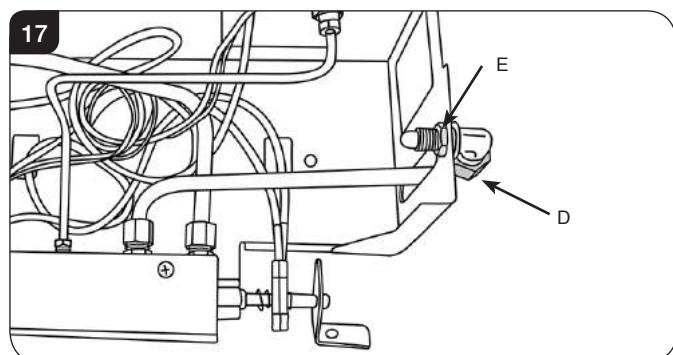

- 10.3 Replace with the correct replacement injector. When ordering, always state the model, gas type and serial number.

- 10.4 Reassemble and turn the gas supply on, check for any leaks.

- 11.1 Remove the battery, see Section 3.

- 11.2 Remove the 2 screws to remove the heat shield, see Diagram 18.

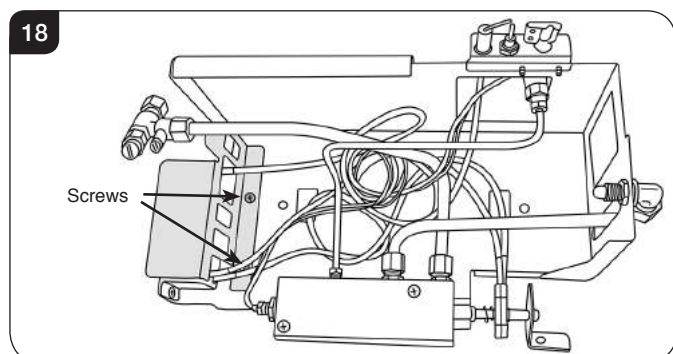

- 11.3 Remove the 2 leads and the pilot ignition lead from the ignition unit, see Diagram 19.

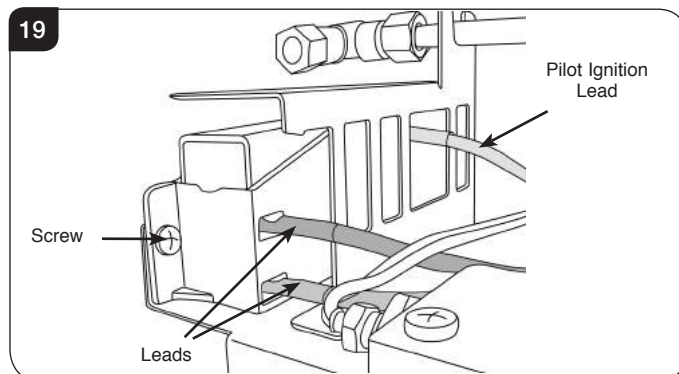

- 11.4 Undo the screw securing the unit in place, see Diagram 19.

- 11.5 Replace in reverse order.

The Baffle and Liners do not need to be removed for servicing.

- 12.1 Undo the 3 screws securing it to the roof of the firebox, see Diagram 20.

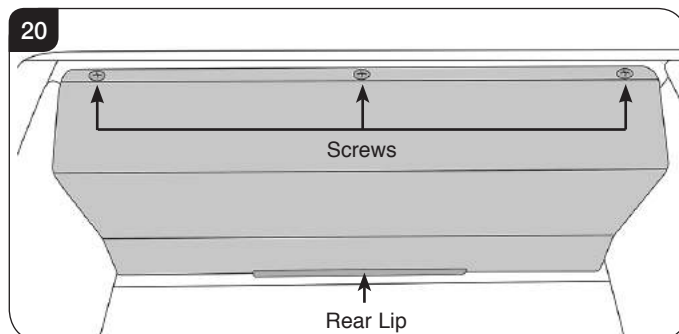

- 12.2 The baffle can now be removed by lowering the front edge and pulling forward through the front of the appliance. **TAKE CARE NOT TO DAMAGE THE SIDE PANELS.**

- 12.3 Note: When replacing the baffle ensure that the rear edge locates above the rear lip, see Diagram 20.

Servicing Instructions - Replacing Parts

LINERS

Once the baffle has been placed carefully to one side the liners can then be taken out in the following order.

- 12.4 To remove the Right Hand liner first tilt inwards towards the centre of the firebox before lifting up and pulling out through the front of the firebox, see Diagram 21.

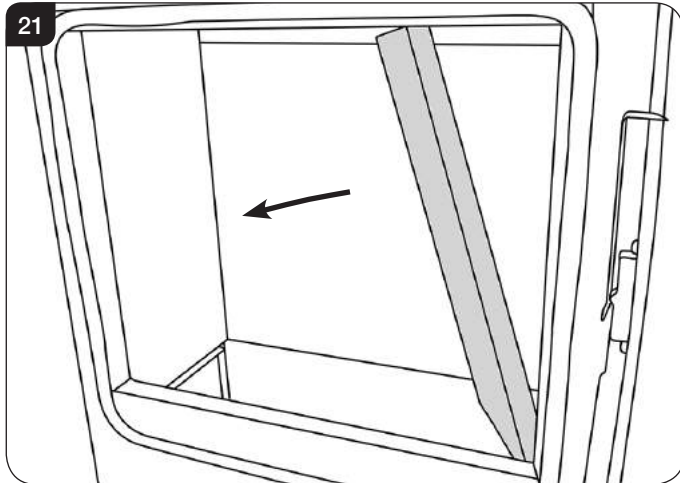

- 12.5 To remove the Left Hand liner first tilt inwards towards the centre of the firebox before lifting up and pulling out through the front of the firebox, see Diagram 21.

The 2 side liners also support the rear liner. Taking out the side liners will allow the rear liner to drop down so ensure it is supported.

- 12.6 Remove the rear liner by carefully lifting over the bottom bracket and twisting slightly to allow it to be removed through the front of the appliance, see Diagram 22.

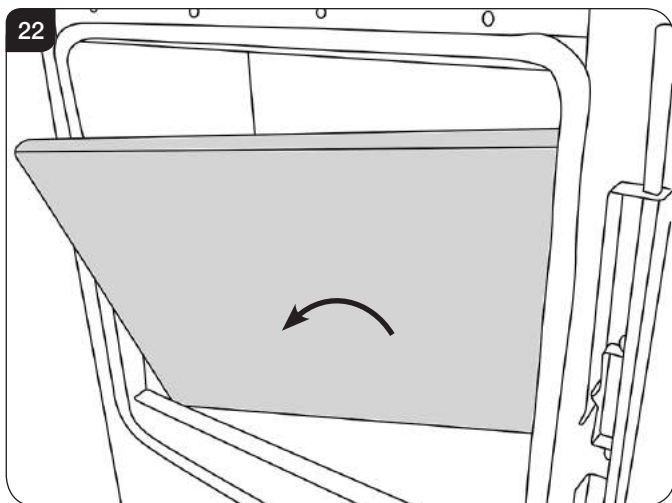

- 12.7 To replace the liners and baffle reverse these procedures.

13. Changing between Gas Types

In order to change between gas types, it will be necessary to change the **Gas Valve, Pilot, Injector, Burner, & Databadge**.

Note: The control valve will be set for the particular appliance and gas type. In all instances, when ordering new parts, be sure to quote the appliance type and serial number.

Use only genuine Gazco replacement parts. Nonstandard components will invalidate the guarantee and may be dangerous.

14. Debris Collection

- 14.1 Remove the frame from the appliance by referring to the separate instructions supplied with the front.
- 14.2 Remove the glass frame, see Section 2 and the fuel bed components. Place carefully to one side.
- 14.3 Remove the baffle and liners, see Section 12.
- 14.4 Remove the main burner, see Section 4.
- 14.5 Remove the Control Assembly, see Section 5.
- 14.5 Undo the screws and remove the convector air panel, see Diagram 23.

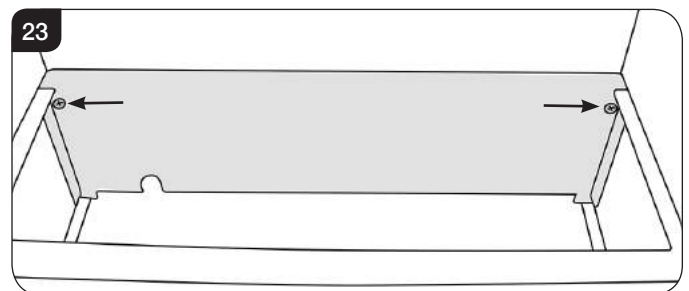

- 14.6 Pull the top of the air panel forwards to release, then tilt the bottom edge upwards into the firebox to remove.
- 14.7 Remove the appliance from the fireplace opening noting the installation method.
- 14.8 Clean out any debris.
- 14.9 Replace the appliance into the opening and securing using the chosen method as described in the installation section.
- 14.10 To replace the convector air panel:

Angle the top edge of the panel up and under the lip at the back of the firebox.

Clip the panel into place and secure with the 2 previously removed screws.

Servicing Instructions - Replacing Parts

15. Spares List

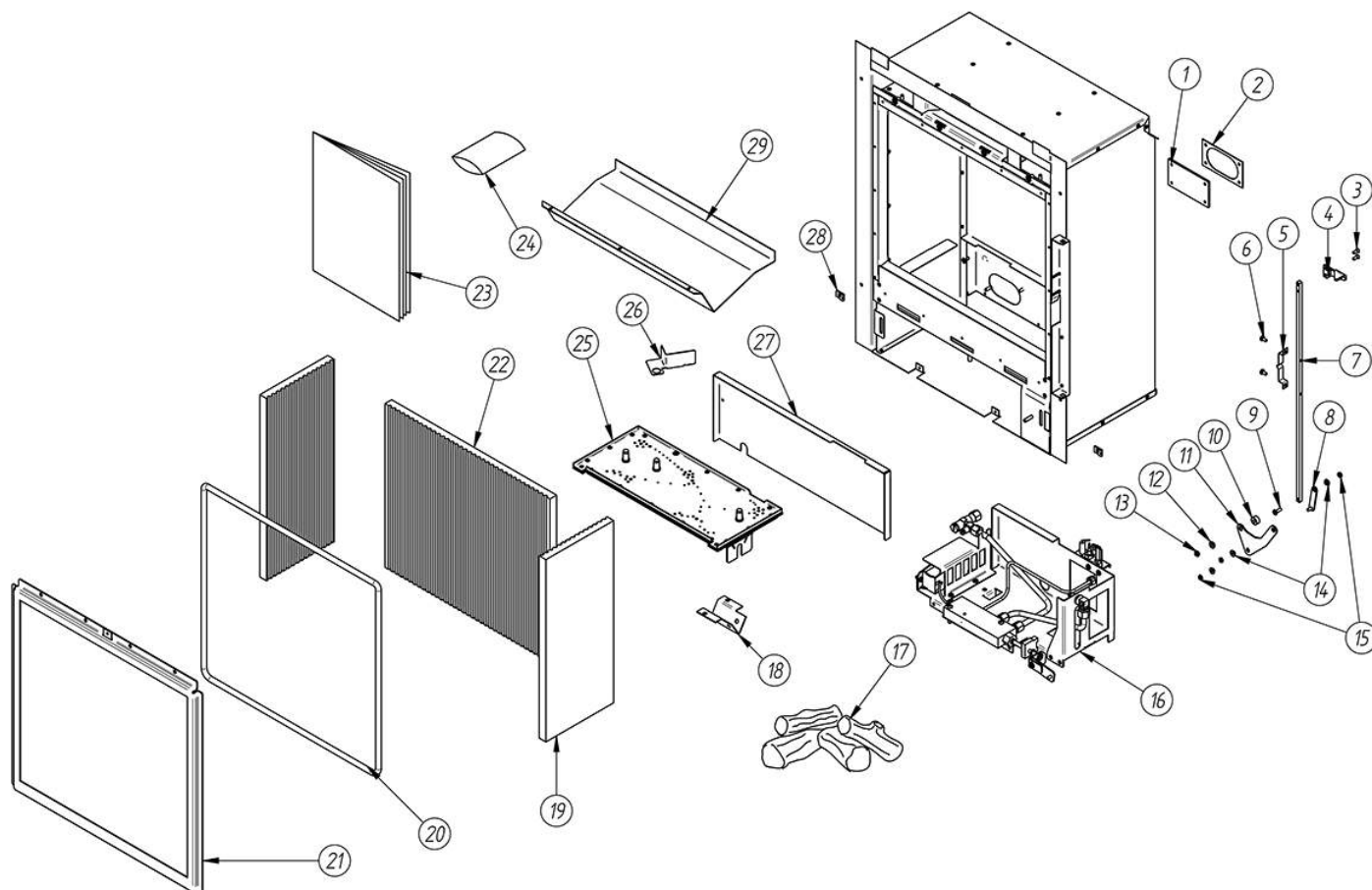

No.	Component	Part Code		
		Natural Gas	LPG	Quantity
1	Inlet Silicone Seal	FA0354		1
2	Inlet Plate	ME3746		1
3	M4 x 10 Screw	FA0330		2
4	Handle	GZ11002		1
5	Spring Clip	GZ11061		1
6	M4 x 6 Pozi	FA0694		2
7	Pushrod	GZ11009		1
8	Link Plate - Small	GZ10052		1
9	M4 x 12 Screw	D2150-1412		1
10	Metal Spacer	FA0691		1
11	Crank Lever	ME11008		1
12	Circular Clearance Spacer - M5	FA0689		1
13	M5 Locknut	FA0038		1
14	Circular Clearance Spacer - M4	FA0685		3
15	M4 Nyloc Nut	C94323		3

No.	Component	Part Code		
		Natural Gas	LPG	Quantity
16	Engine Assembly	GZ14021		1
17	Log Set	CE1755		1
18	Aeration Cover 2 x Ø6.5mm	GZ14549	-	1
19	Black Reed LH & RH Lining	CE1856		2
20	Ropeseal	FA0600		1
21	Door Assembly	GZ14017		1
22	Black Reed Rear Lining	CE1857		1
23	Installation Instruction	PR2443		1
24	Embaglow	GZ8471		1
25	Burner Assembly	GZ14537	GZ14540	1
26	Burner Tray Divider	GZ14398		1
27	Rear Inner Baffle	GZ14399		1
28	Spire Clip	FA0041		2
29	Top Baffle	GZ14401		1



Due to continual technical improvements please check online or with your Gazco retailer for the most up to date parts lists.

Only use Genuine Gazco spares when servicing your appliance.

All of our essential spare parts and consumable items are available to purchase from our webshop at www.gazcospares.com.

Servicing Instructions - Replacing Parts

15. Spares List

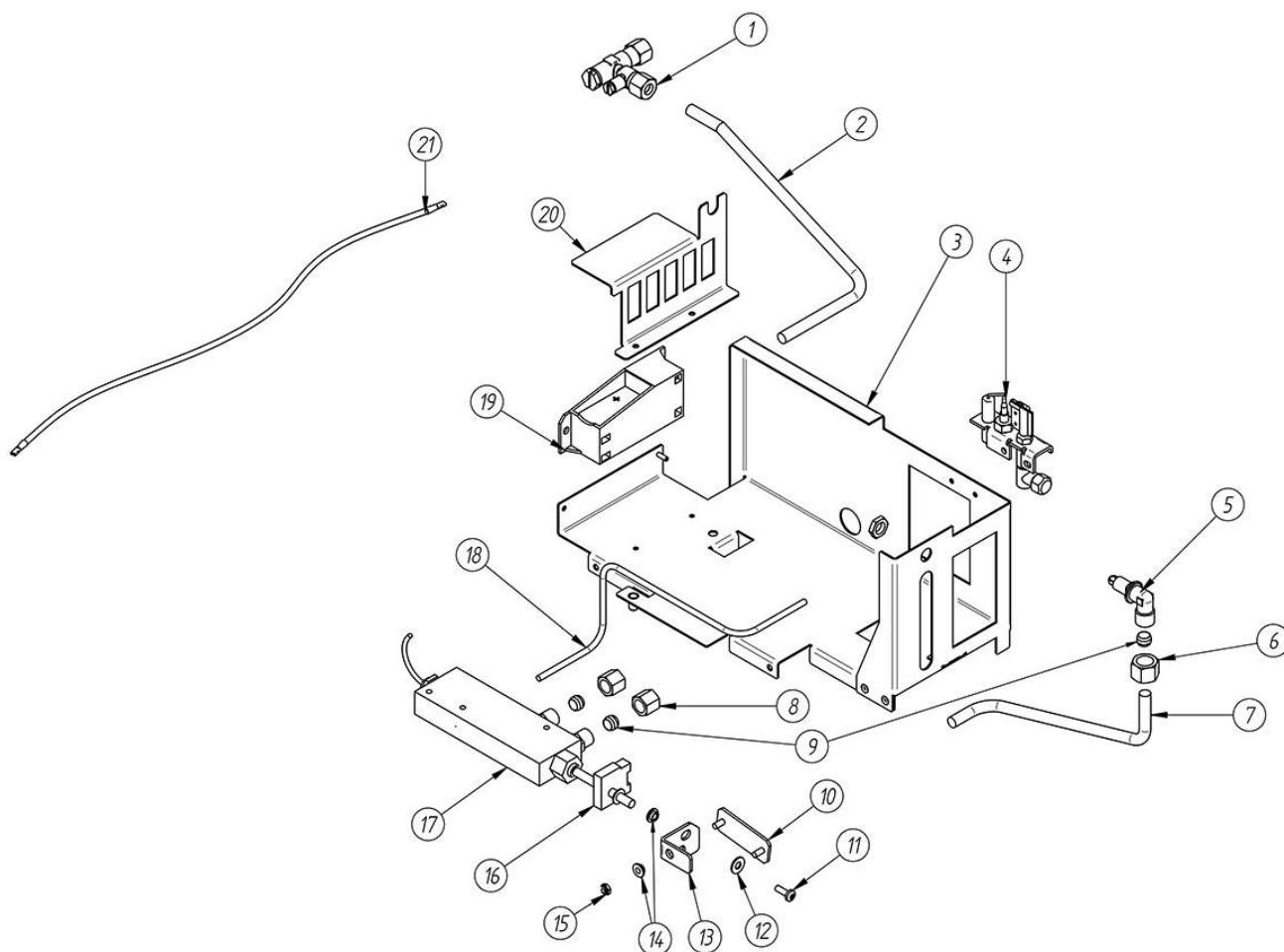

No.	Component	Part Code		
		Natural Gas	LPG	Quantity
1	Inlet Isolation Device & Pressure Test Point	GC0095		1
2	Inlet Pipe 8mm	GZ14520		1
3	Control Bracket	GZ14020		1
4	Oxypilot	PI0044	PI0045	1
5	Injector	IN0053 - Size 170	IN0031 - Size 150	1
6	1/4" BSP Nut	FA0029		1
7	Injector Feed Pipe 8mm	GZ14519		1
8	Nut 8mm	FA0122		2
9	Olive 8mm	FA0011		3
10	Bottom Link Assembly - 39mm	GZ11577		1

No.	Component	Part Code		
		Natural Gas	LPG	Quantity
11	M4 x 12 Screw	D2150-1412		1
12	M5 Large Washer	FA0705		1
13	Valve Actuator Bracket	GZ11007		1
14	Circular Clearance Spacer - M4	FA0685		2
15	M4 Nyloc Nut	C94323		1
16	Micro Switch Kit	GC0179		1
17	Control Valve	GC0168		1
18	Pilot Pipe 4mm	GZ14521		1
19	Igniter	EL0573		1
20	Battery Cover & Elbow Support	GZ14406		1
21	Igniter Lead	EL0578		3



Due to continual technical improvements please check online or with your Gazco retailer for the most up to date parts lists.

Only use Genuine Gazco spares when servicing your appliance.

All of our essential spare parts and consumable items are available to purchase from our webshop at www.gazcospares.com.

Service Records

1ST SERVICE

Date of Service
Next Service Due
Signed
Retailer's Stamp/GasSafe Registration Number

3RD SERVICE

Date of Service
Next Service Due
Signed
Retailer's Stamp/GasSafe Registration Number

5TH SERVICE

Date of Service
Next Service Due
Signed
Retailer's Stamp/GasSafe Registration Number

7TH SERVICE

Date of Service
Next Service Due
Signed
Retailer's Stamp/GasSafe Registration Number

9TH SERVICE

Date of Service
Next Service Due
Signed
Retailer's Stamp/GasSafe Registration Number

2ND SERVICE

Date of Service
Next Service Due
Signed
Retailer's Stamp/GasSafe Registration Number

4TH SERVICE

Date of Service
Next Service Due
Signed
Retailer's Stamp/GasSafe Registration Number

6TH SERVICE

Date of Service
Next Service Due
Signed
Retailer's Stamp/GasSafe Registration Number

8TH SERVICE

Date of Service
Next Due
Signed
Retailer's Stamp/GasSafe Registration Number

10TH SERVICE

Date of Service
Next Service Due
Signed
Retailer's Stamp/GasSafe Registration Number

Information Requirement - Gas Heaters

Information Requirement for Gaseous Fuel Local Space Heater

Model		Logic HE CF NG	Logic HE CF LPG
Fuel	Space Heating Emissions (NOx) - mg / kWh _{input} (GCV)	130	130

Heat Output	Nominal Heat Output - P_{nom}	3.9kW	3.9kW
	Minimum Heat Output (indicative) - P_{min}	1.6kW	1.6kW

Auxiliary Electricity Consumption	At Nominal Heat Output - el_{max}	N/A	N/A
	At Minimum Heat Output - el_{min}	N/A	N/A
	In Standby Mode - el_{sb}	N/A	N/A

Useful Efficiency (NCV)	Useful Efficiency at nominal heat output - $\eta_{th,nom}$	84.0%	84.0%
	Useful Efficiency at minimum heat output (indicative) - $\eta_{th,min}$	71.0%	71.0%

Permanent Pilot Flame Power requirement	Permanent Pilot Flame Power requirement (if applicable) - P_{pilot}	0.200kW	0.200kW
---	---	---------	---------

Type of heat output/room temperature control - Manual Control		
Two or more manual stages, no room temperature control	Yes	Yes

Other control options (multiple selections possible)		
Room temperature control, with presence detection	No	No
Room temperature control, with open window detection	No	No
With distance control option	No	No
With adaptive start control	No	No
With working time limitation	No	No
With black bulb sensor	No	No

Energy Efficiency Index	72.5%	72.5%
Energy Efficiency Class	D	D

Contact:	Gazco Ltd, Osprey Road, Sowton Industrial estate, Exeter, EX2 7JG
----------	---

Gazco Limited, Osprey Road, Sowton Industrial Estate, Exeter, Devon, England EX2 7JG
Technical Customer Services: (01392) 261950 Fax: (01392) 261951
E-mail: technicalservices@gazco.com

A member of the Stovax Group
E & O E