



Fire Your Imagination

Sheraton 5

Conventional Flue Log Effect Stove

with Thermostatic Remote Control



Instructions for Use, Installation and Servicing

For use in GB, IE (Great Britain and Republic of Ireland)

IMPORTANT

THE OUTER CASING, FRONT AND GLASS PANEL BECOME EXTREMELY HOT DURING OPERATION AND WILL RESULT IN SERIOUS INJURY AND BURNS IF TOUCHED. IT IS THEREFORE RECOMMENDED THAT A FIREGUARD COMPLYING WITH BS 8423 (LATEST EDITION) IS USED IN THE PRESENCE OF YOUNG CHILDREN, THE ELDERLY OR INFIRM.

ENSURE THAT ALL COMBUSTIBLE MATERIALS ARE NOT POSITIONED ABOVE OR NEAR TO THE APPLIANCE OUTER CASING.

This product contains a heat resistant glass panel. This panel should be checked during Installation and at each servicing interval. If any damage is observed on the front face of the glass panel (scratches, scores, cracks or other surface defects), the glass panel must be replaced and the appliance must not be used until a replacement is installed. Under no circumstances should the appliance be used if any damage is observed, the glass panel is removed or broken.

It is essential that ALL of the screws that retain the glass frame are replaced and tightened correctly. Under no circumstances should the appliance be operated if any of these screws are loose or missing.

These Instructions must be left with the appliance for future reference and for consultation when servicing the appliance. Please make the customer aware of the correct operation of the appliance before leaving these instructions with them.

The commissioning sheet found on Page 3 of this Instruction manual must be completed by the Installer prior to leaving the premises.

Contents

Sheraton 5 Conventional Flue Log Effect

Covering the following models:

	Sheraton 5
Nat Gas	505-014
LPG	505-428

Appliance Commissioning Checklist3

User Instructions4

Installation Instructions14

Technical Specifications 14

Site Requirements 16

Installation 18

Commissioning25

Servicing Requirements26

Fault Finding26

How to replace parts29

Spare parts list35

Service Records37

Information Requirement - Gas Heaters38



If you have purchased your stove or fire from an authorised stockist within our Expert Retailer Network, then automatically your product will carry a 2 year warranty as standard. The 2 year warranty can be further extended to a total warranty period of 5 years by registering your Gazco Stove or Fireplace within one month of the later of the purchase date or installation date. Accordingly, the start date for the warranty period is the date of purchase. During the registration process, the Expert Retailer details will be required for your Extended Warranty to be activated. Any product purchased outside of our Expert Retailer Network will carry a standard 12 month, non-extendable warranty.

It is a condition of the Extended Warranty that the installation complies with the relevant Building Regulations and is carried out by a suitably trained and qualified individual (GasSafe in the UK or equivalent in other countries) with the certificate of installation and the Commissioning Report on Page 3 completed and retained by the end user.

Full terms and conditions are detailed in the Warranty Statement on the Gazco website www.gazco.com. In the event of any conflict of information the wording on the website shall prevail.

Important Note: Should any problems be experienced with your product, claims must first be submitted to the Expert Retailer where the appliance was purchased from who will offer immediate assistance or contact Gazco on your behalf.



It is a requirement of the Building Regulations 2010 that the installation of this appliance is notified to the Local Authority. It is the responsibility of the GasSafe registered installer to carry out this notification to the Local Authority via the GasSafe register Competent Persons Scheme in England and Wales (different rules apply in Scotland and Northern Ireland).

When the installation has been notified, GasSafe will send a Building Regulations Compliance Certificate to you containing details of the work completed. Please ensure that the person responsible for the installation of this appliance completes this notification and records it in the Appliance Commissioning Checklist on page 3.

IT IS YOUR RESPONSIBILITY TO COMPLY WITH THE BUILDING REGULATIONS AND BE ABLE TO PRODUCE THIS CERTIFICATE SHOULD IT BE REQUIRED IN THE FUTURE.

Appliance Commissioning Checklist

To assist us in any guarantee claim please complete the following information:-

IMPORTANT NOTICE

Explain the operation of the appliance to the end user, hand the completed instructions to them for safe keeping, as the information will be required when making any guaranteed claims.

FLUE CHECK	PASS	FAIL
1. Flue Is correct for appliance		
2. Flue flow Test		
3. Spillage Test		
GAS CHECK		
1. Gas soundness & let by test		
2. Standing gas pressure	mb	
3. Appliance working pressure (on High Setting) Minimum Pressure Requirement: NG - 17.5mbar LPG - 34.5mbar NB All other gas appliances must be operating on full	mb	
4. Gas rate	m ³ /h	
5. Does Ventilation meet appliance requirements		
SAFETY CHECK		
1. Check soundness of the Thermocouple connections - including tightness and lead integrity		
2. Glass checked to ensure no damage, scratches, scores or cracks		
3. Glass frame secured correctly and all screws replaced		
BUILDING CONTROL NOTIFICATION	YES	NO
1. Installer notified GasSafe/Local Authority of installation via Competent Persons Scheme?		

RETAILER AND INSTALLER INFORMATION

Retailer	Installation Company
.....
.....
Contact No.	Engineer
Date of Purchase	Contact No.
Model No.	GasSafe Reg No.
Serial No.	Date of Installation
Gas Type	

User Instructions

Welcome

Congratulations on purchasing your Gazco Sheraton 5, if installed correctly Gazco hope it will give you many years of warmth and pleasure for which it was designed.

The purpose of this manual is to familiarise you with your appliance, and give guidelines for its installation, operation and maintenance. If, after reading, you need further information, please do not hesitate to contact your Gazco retailer.

WARNING



In the event of a gas escape or if you can smell gas, please take the following steps:

- Immediately turn off the gas supply at the meter/emergency control valve
- Extinguish all sources of ignition
- Do not smoke
- Do not operate any electrical light or power switches (On or Off)
- Ventilate the building(s) by opening doors and windows
- Ensure access to the premises can be made

Please report the incident immediately to the National Gas Emergency Service Call Centre on 0800 111 999 (England, Scotland and Wales) , 0800 002 001 (N. Ireland) or in the case of LPG, the gas supplier whose details can be found on the bulk storage vessel or cylinder.

The gas supply must not be used until remedial action has been taken to correct the defect and the installation has been recommissioned by a competent person.

1. General

- 1.1 Installation and servicing must only be carried out by a competent person whose name appears on the GasSafe register. To ensure the engineer is registered with GasSafe they should possess an ID Card carrying the following logo:



- 1.2 In all correspondence, please quote the appliance type and serial number, which can be found on the data badge located under the top plate between the carcass and firebox or on the Commissioning Checklist on Page 3.
- 1.3 **Do not** place curtains above the appliance:
You must have 300mm clearance between the appliance and any curtains at either side.
- 1.4 The manufacturer considers the full outer casing of this appliance to be a working surface and it will become hot whilst in operation. A suitable guard is recommended to protect young children, the aged and the infirm.
- 1.5 No furnishings or other objects should be placed within 1 metre of the front of the appliance.
- 1.6 If a shelf is fitted, a distance of 225mm above the appliance is required.
- 1.7 Do not attempt to burn rubbish in this appliance.
- 1.8 This appliance must only be operated with the door secured firmly in position. If any cracks appear in the glass the appliance must not be used until the glass panel is replaced.
- 1.9 This product is guaranteed for 5 years from the date of installation, as set out in the terms and conditions of sale between Gazco and your local Gazco retailer. Please consult with your local Gazco retailer if you have any questions. In all correspondence always quote the Model Number and Serial Number.

User Instructions

2. Operating the Appliance

There are two ways of lighting the appliance:

- 2a. Using the Manual Controls on the Control Box (located on the appliance).
- 2b. By Thermostatic Remote Control.

2a. Manual Operation (Control Box)

2a.1 The manual controls are located on the Control Box behind the drop down vanity cover, see Diagram 1.

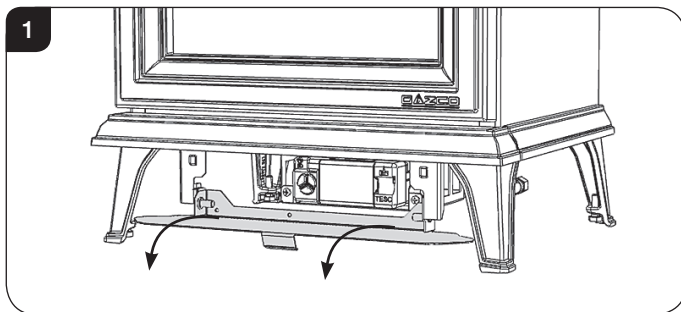

2a.2 There are a series of buttons on the left hand side of the Control Box, see Diagram 2.

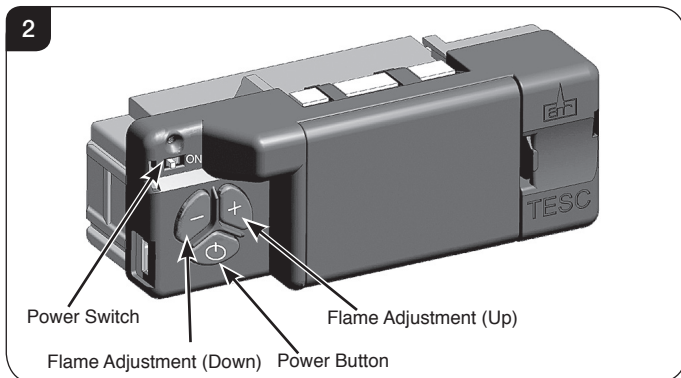

To operate the appliance the Power Switch on the Control Box must be switched ON (I).

Note: The Power Switch does not need to be turned off each time the appliance is not in use. However, if the appliance is left unattended for long periods of time (e.g. vacation), it is recommended to place the Power Switch into the off position.

Turning the appliance on:

- 2a.3 Press and hold the Power Button for 1 second and release. The burner will light approximately 2 to 3 seconds later.
- 2a.4 Use + and - buttons to adjust the flame height between Minimum and Maximum.

Turning the appliance off

- 2a.5 Press the power button to turn the appliance off.

IMPORTANT: YELLOW FLAMES TYPICALLY APPEAR WHEN THE APPLIANCE HAS REACHED NORMAL OPERATING TEMPERATURE. THIS CAN TAKE UP TO 30 MINUTES.

WARNING: IF THE APPLIANCE FAILS TO LIGHT OR BECOMES EXTINGUISHED IN USE, WAIT 3 MINUTES BEFORE ATTEMPTING TO RELIGHT.

THE APPLIANCE WILL TAKE 3 AUTOMATIC ATTEMPTS TO RESTART. DO NOT INTERRUPT THE VALVE DURING THIS PROCESS.

2b. Remote Control

To operate the appliance the Power Switch on the Control Box must be switched ON (I).

To activate the Remote Control it will be necessary to cradle the handset to unlock, see Diagram 3. The green light will illuminate to show the handset is ready to use.

IMPORTANT: Continue to cradle the handset throughout an operation to keep it unlocked.

If the green light goes off during an operation it will be necessary to reposition the handset so the light comes back on and restart the operation.



Handset Features

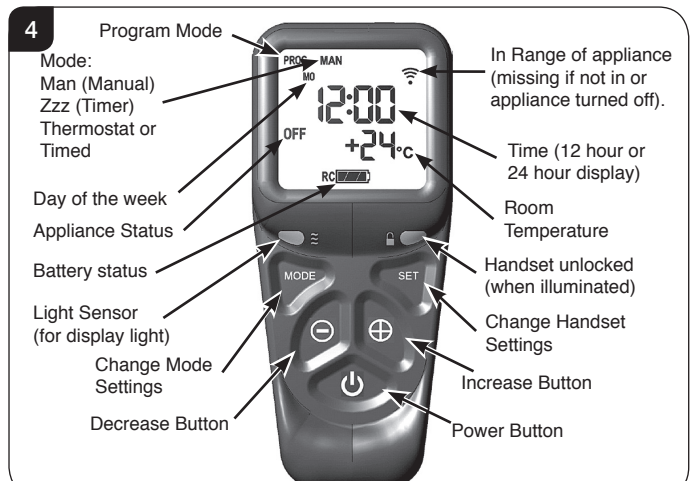

User Instructions

The icon at the bottom of the screen displays the battery condition of both the batteries in the handset and in the Control Box alternatively.



RC = Remote Control Handset and FC = Fire Control (Control Box).

i If the handset has been replaced or the fire has been serviced, see Installation Section 8b to set up the handset.

Manual Operation (Remote Control)

i To activate the Remote Control it will be necessary to cradle the handset to unlock, see Diagram 3. The green light will illuminate to show the handset is ready to use.
IMPORTANT: Continue to cradle the handset throughout an operation to keep it unlocked. If the green light goes off during an operation it will be necessary to reposition the handset so the light comes back on and restart the operation.

Turning the appliance on

- 2b.1 Press the  Power Button until Pilot flashes on the display.
- 2b.2 Release the  Power Button and the Flame symbol will appear on the display.

If the button is held the command will be cancelled for safety reasons.

- 2b.3 Holding the handset to unlock, use + and - buttons to adjust the flame height between Minimum and Maximum.

Turning the appliance off

- 2b.4 Holding the handset to unlock, press the  power button to turn the appliance off.

i **IMPORTANT: YELLOW FLAMES TYPICALLY APPEAR WHEN THE APPLIANCE HAS REACHED NORMAL OPERATING TEMPERATURE. THIS CAN TAKE UP TO 30 MINUTES.**

! **WARNING: IF THE APPLIANCE FAILS TO LIGHT OR BECOMES EXTINGUISHED IN USE, WAIT 3 MINUTES BEFORE ATTEMPTING TO RELIGHT.**

THE APPLIANCE WILL TAKE 3 AUTOMATIC ATTEMPTS TO RESTART. DO NOT INTERRUPT THE VALVE DURING THIS PROCESS.

Setting Timer Mode (in Manual operation)

Timer Mode will turn the appliance off after a set period of time has elapsed.

Timer Mode can be set before or during manual operation of the fire.

i **Note: If Timer mode is activated and the fire is manually turned off, the timer will be cancelled. Changes to the Timer will reset to the default time on next use.**

If the fire is off when the Timer mode is set then the timer will automatically start when the fire is turned on.

- 2b.5 Hold the handset to unlock and press and release the MODE button. The word MAN and the Zzz symbols flash at the top of the display.

- 2b.6 Press and release the SET button. This will activate the Timer mode.

The default time period is 1 hour, unless altered in 2b.39.

- 2b.7 Pressing the SET button again will show the remaining time. This can be altered by pressing the + or - buttons. The timer can be set between 1 minute and 24 hours.

- 2b.8 After adjusting the time press SET again to confirm the time setting desired.

Once the countdown has reached zero the fire will turn off.

Thermostatic Mode

The handset contains a thermostatic sensor to control the operation of the appliance according to the temperature of the room.

There are 3 temperature options that can be set:

Day Mode - indicated by a Sun symbol on the display (default temperature 24°C)

Night Mode - indicated by a Moon symbol on the display (default temperature 18°C)

Frost Protection - indicated by a Snowflake symbol on the display (default temperature 5°C)

Programming the Modes

- 2b.9 Holding the handset to unlock, press and hold the SET button until a beep is heard to indicate the command has been received.
- 2b.10 Release the SET button. PROG and a flashing thermometer symbol will be displayed at the top of the display.
- 2b.11 Press and release the SET button to enter Day Mode. The current temperature setting and mode will be displayed- for example the Sun symbol on the left shows it is in Day Mode and the default temperature is 24°C.
- 2b.12 To change the temperature press + or - whilst the set temperature is displayed to alter the setting.

User Instructions

- 2b.13 Press and release the SET button to confirm and to scroll to the Night Mode.
- 2b.14 To change the temperature press + or - whilst the set temperature is displayed to alter the setting.
- 2b.15 Press and release the SET button to confirm and to scroll to Frost Protection mode.
- 2b.16 To change the temperature press + or - whilst the set temperature is displayed to alter the setting.
- 2b.17 When finished press the SET button again and the new settings will be accepted.
The display will return to the time of day screen.

Choosing a Mode

When choosing a mode during operation the temperature can be temporarily changed, however these settings will reset to the previously set programmed settings when the fire is turned off.

- 2b.18 Holding the handset to unlock, press and release the MODE button several times until a thermometer symbol flashes at the top of the display.
- 2b.19 Press the SET button to enter the Thermostatic mode.
- 2b.20 Press the Set button again to see the current temperature setting and mode - for example the a Sun symbol on the left shows it is Day Mode and the default temperature is 24°C.
- 2b.21 With the temperature displayed, press + or - to alter the setting.
- 2b.22 Press the MODE button repeatedly to scroll through the settings and to select Night mode or Frost Protection.

The handset must be left in the chosen mode for it to operate.

- 2b.23 When finished press SET again and the new setting will be accepted.
The display will return to the time of day screen.

If at any time the power button is operated during Thermostatic Mode the control will cancel any thermostat operation and return the handset to Manual Mode.

Setting Timer Mode (in Thermostatic Operation)

Timer Mode will turn the appliance off after a set period of time has elapsed.
Timer Mode can be set before or during thermostatic operation of the fire.

- 2b.24 Hold the handset to unlock, press and release the MODE button until the word MAN and the Zzz symbols are flashing at the top of the display.
- 2b.25 Press and release the SET button.
This will activate the Timer mode.

The default time period is 1 hour, unless altered in 2b.39.

- 2b.26 Pressing the SET button again will show the remaining Time.
This can be altered by pressing the + or - buttons.
The timer can be set between 1 minute and 24 hours.

- 2b.27 After adjusting the time press SET again to confirm the time setting desired.

Once the countdown has reached zero the fire will turn off.



Note: If Timer mode is activated and the fire is manually turned off, the timer will be cancelled. Changes to the Timer will reset to the default time on next use.

If the fire is off when the Timer mode is set then the timer will automatically start when the fire is turned on.

Setting the Clock

To adjust the time on the handset after initial set up:

Holding the remote to keep the green light on and the handset unlocked:

- 2b.28 Press and hold the SET button until a beep is heard to indicate the command has been received.
- 2b.29 Release the SET button. PROG will be displayed at the top left of the display.
- 2b.30 Press the MODE button twice until SET UP flashes in the top right of the display.
- 2b.31 Press and release the SET button. The handset will display an H:24, see Diagram 5.



24 denotes a 24 hour clock and 12 denotes a 12 hour clock.

- 2b.32 Press the + or - button on the handset to toggle between the two settings.
Press the SET button to confirm and progress to setting the day of the week.

User Instructions

Setting the Day of the Week

2b.33 Press and release the + and - buttons until the correct day of the week is shown on the display.



Mo = Monday, **Tu** = Tuesday, **We** = Wednesday, **Th** = Thursday, **Fr** = Friday, **Sa** = Saturday and **Su** = Sunday.

2b.34 Press SET to confirm the day of the week and progress to setting the time.

Setting the Hour

2b.35 Press and release the + or - button to change the hour to the correct hour. Press SET to confirm and progress to setting the minute.



Setting the Minutes

2b.36 Repeat the process to change the minutes.

Setting the Temperature Display (Celsius or Fahrenheit)

2b.37 Press and release the + or - button to toggle between C and F. When the display shows the desired symbol, press and release the SET button to store.



2b.38 To enter Advanced Settings, see below. To finish, place the handset down and wait until the home screen is displayed and the unlock light goes off.



ALL THE NECESSARY SETTINGS REQUIRED HAVE NOW BEEN COMPLETED. ANY FURTHER FUNCTIONS ON THIS HANDSET ARE FOR FACTORY SETTING AND NOT TO BE USED.

The Handset is now ready to operate the appliance.

Advanced Menu Settings

It is possible to change additional preset settings of the control features.

2b.39 Follow steps 2b.28 to 2b.38 to access the Advanced Menu Settings. Press and release the SET button to enter the Advanced Settings Menu.

Advanced Settings are:

Back Light (L)

- A = Automatic (default setting).
The backlight comes on in the dark.
- O = Light never comes on.
- 1 = Light comes on when the handset is unlocked.

Display Contrast (C)

- 8 Levels from 0 - 7 (Default level 4).

P = Pairing with devices other than the Control Box.
This feature is not available on this appliance.



IMPORTANT: THE FURTHER FUNCTIONS ON THIS HANDSET ARE FOR FACTORY SETTING ONLY AND ARE NOT TO BE USED. PLACE THE HANDSET ON A FLAT SURFACE AND WAIT UNTIL THE HOME SCREEN IS DISPLAYED AND THE UNLOCK LIGHT TURNS OFF.

Paging the Handset

If the handset is lost it can be located by pressing the + only on the Control Box for 5 seconds. The handset will flash and make a noise for 60 seconds to indicate where it is. Pick up the Handset and cradle it to unlock. The flashing and noise will stop.

If the handset is not discovered in 60 seconds the process will need to be repeated.

User Instructions

Changing the Default Timer Mode

It is possible to change the default time period for the Timer mode.

The default time period for Timer mode is factory set to 1 hour.

To change the default time:

Holding the remote to keep the green light on and the handset unlocked:

- 2b.40 Press and hold the SET button until a beep is heard to indicate the command has been received.
- 2b.41 Release the SET button. PROG will be displayed at the top left of the display.
- 2b.42 Repeatedly press the MODE button until the Zzz symbol flashes at the top of the display.
- 2b.43 Press and release the SET button.
- 2b.44 Press the + or - buttons to alter the default time period. The timer can be set between 1 minute and 24 hours.
- 2b.45 After adjusting the time press SET again to confirm.

Note: This does not activate the Timer mode, see Installation Section, Manual Operation or Thermostatic Mode.

3. Replacing the Appliance Batteries

Replace batteries at least every 12 months during the annual service of the fire.



It is essential to use high quality batteries (Duracell or equivalent) when replacing batteries.

The icon at the bottom shows the battery condition of both the batteries in the handset and in the Control Box alternately, see Diagram 9.



RC = Remote Control Handset and FC = Fire Control (Control Box).



Note: Change the batteries in the handset before they are flat, to avoid having to reprogram the time of day in again. N.B. Pairing is not lost, even if the batteries are removed or flat.

The appliance Control Box requires 3 AA size alkaline batteries.

The handset requires 2 AA size alkaline batteries.

- 3.1 The appliance battery is located in the Control Box behind the drop down vanity cover.

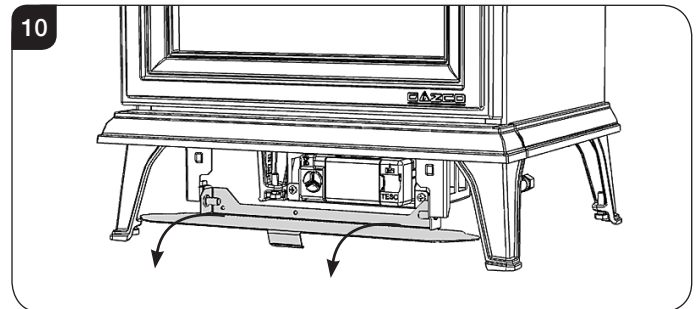

- 3.2 Slide the Power Switch on the Control Box to the OFF (o) position before attempting to change the batteries.

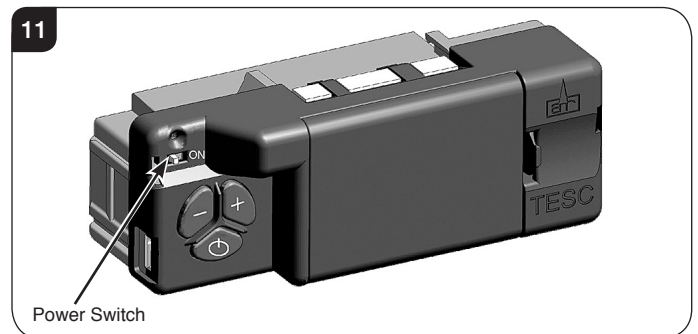

- 3.3 The battery covers can be opened without tools by using a fingernail and pressing to unhook the clip that retains to cover, see Diagram 12.

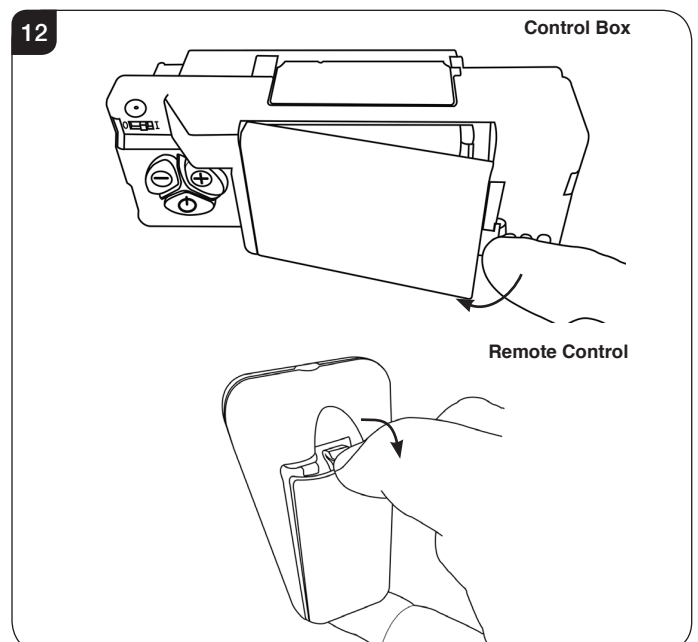

User Instructions

- 3.4 The orientation of these is shown molded into the battery compartment, see Diagram 13.

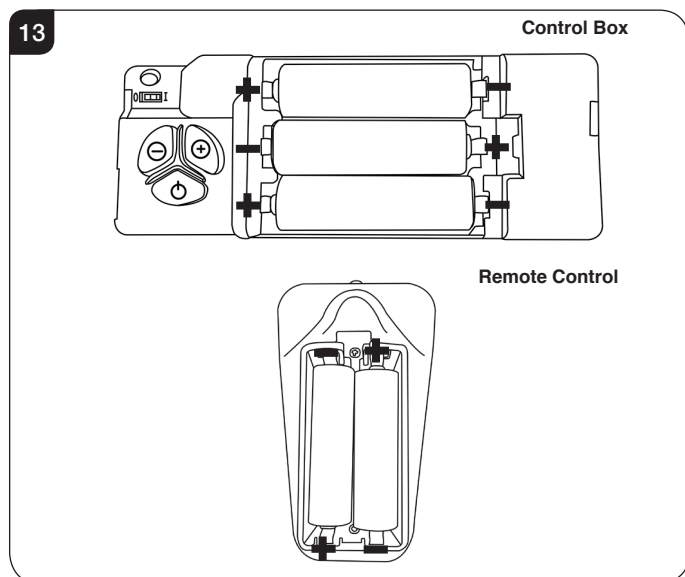

i **Power Supply via Micro USB**

It is possible to power the Control Box via a 5V Micro USB connection, see Diagram 14.
If a USB lead is used batteries are not required in the Control Box.

DO NOT CONNECT OTHER ELECTRIC DEVICES TO THE CONTROL BOX.

- 3.5 After fitting the batteries, slide the white Power Switch on the Control Box to the ON (I) position for the appliance to operate, see Diagram 14.

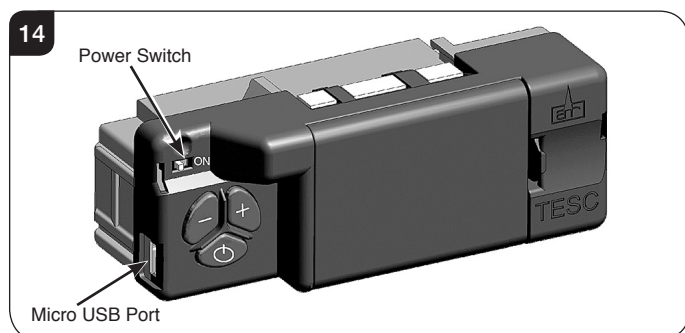

i **Note:** The Power Switch does not need to be turned off each time the appliance is not in use. However, if the appliance is left unattended for long periods of time (e.g. vacation), it is recommended to place the Power Switch into the off position.

4. Cleaning the Appliance



WARNING: NEVER CLEAN THE APPLIANCE WHILE IT'S HOT. THE APPLIANCE STAYS HOT FOR A LONG TIME AFTER SHUTDOWN.

IMPORTANT: THE OUTER PANNELLING AND DOOR OF THE APPLIANCE IS MADE FROM CAST IRON. TAKE CARE WHEN INSTALLING, REMOVING AND STORING TO AVOID DAMAGING THE OUTER CASING, HEARTH OR DOOR.

- 4.1 Make sure the fire and surrounds are cool before cleaning.

Use:

- A dry cloth to clean the appliance casting.
- A damp cloth for the glass front.

- 4.2 Remove the frame to gain access to the viewing aperture by lifting the hooks clear of the slots on the front of the appliance, see Diagram 15.

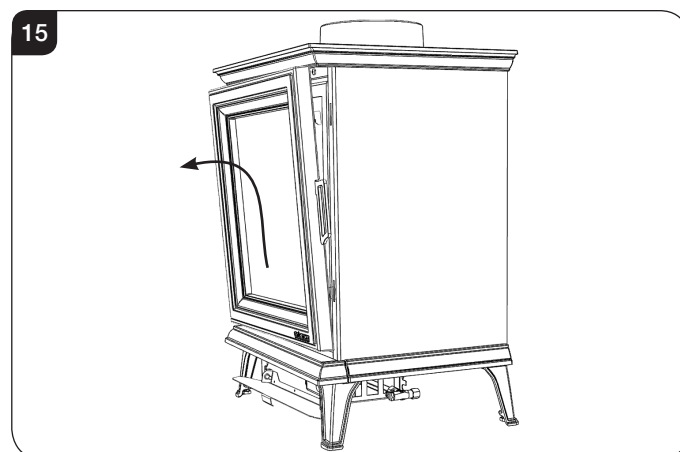

- 4.3 Using a screwdriver remove the 4 screws securing the window panel to the appliance, see Diagrams 16.

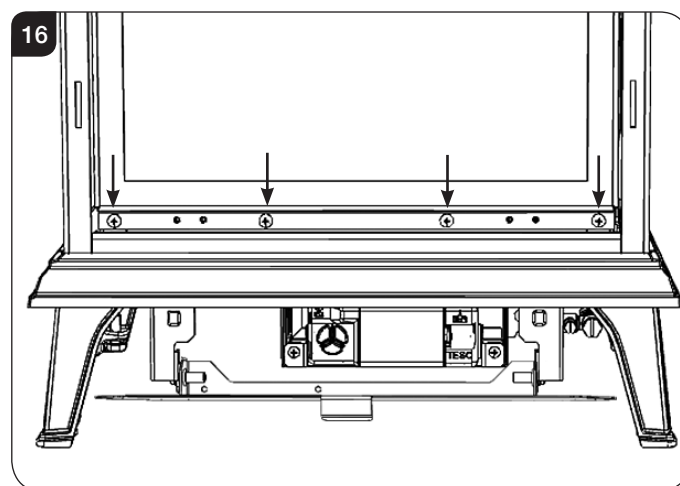

User Instructions

- 4.4 The frame can be removed by pulling the lower edge of the window panel forward and lifting the top return off the firebox, see Diagram 17.

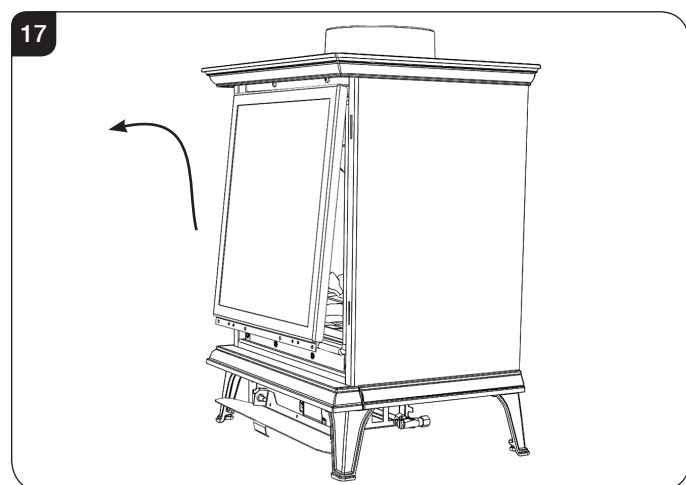

The glass frame must be refitted to the appliance following cleaning or servicing.

- 4.5 Hook the top return of the glass panel over the top of the firebox and ensure it is central.
- 4.6 Push the lower edge towards the firebox and secure with the 4 screws.
- 4.7 Replace ALL of the securing screws ensuring that a screw is present in all fixing slots.



UNDER NO CIRCUMSTANCES SHOULD THE APPLIANCE BE USED IF ANY OF THE GLASS FRAME RETAINING SCREWS ARE LOOSE OR MISSING.

5. Arrangement of Fuel Bed

Advice on handling and disposal of fire ceramics



The fuel effect in this appliance are made from Refractory Ceramic Fibre (RCF), a material which is commonly used for this application.

Protective clothing is not required when handling these articles, but we recommend you follow normal hygiene rules of not smoking, eating or drinking in the work area and always wash your hands before eating or drinking.

To ensure that the release of RCF fibres are kept to a minimum, during installation and servicing a HEPA filtered vacuum is recommended to remove any dust accumulated in and around the appliance before and after working on it. When servicing the appliance it is recommended that the replaced items are not broken up, but are sealed within heavy duty polythene bags and labelled as RCF waste.

RCF waste is classed as stable, non-reactive hazardous waste and may be disposed of at a licensed landfill site.

Excessive exposure to these materials may cause temporary irritation to eyes, skin and respiratory tract; wash hands thoroughly after handling the material.

User Instructions

6. Log Layout

LOGS MUST BE POSITIONED ACCORDING TO THE FOLLOWING INSTRUCTIONS TO GIVE THE CORRECT FLAME EFFECT.

All logs can be identified by a letter (A - D) on their underside. Logs A and B have holes to locate each onto a burner stud.

- 6.1 Ensure the burner tray is clean and free from any debris, see Diagram 18.

Note: The LPG and Nat Gas burner trays are visually different but the log layouts are the same.

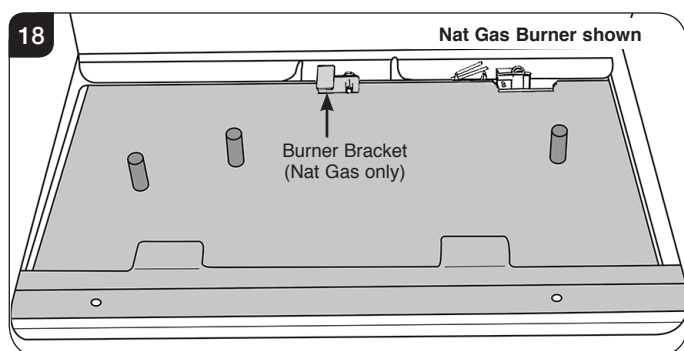

- 6.2 Place Log A in position on the 2 locating pins, see Diagram 19.

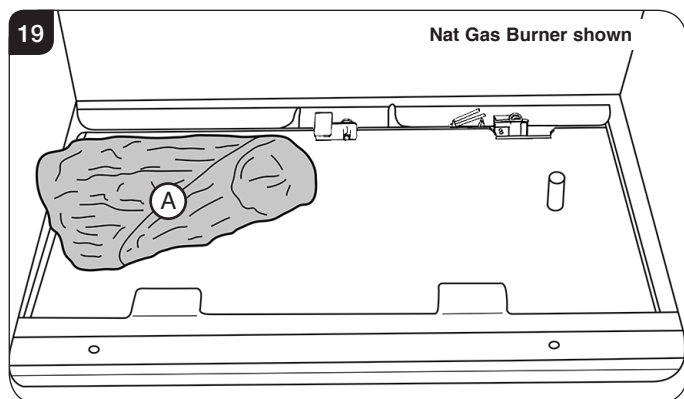

- 6.3 Spread the Lava Rock evenly over the fuel bed and around Log A, see Diagram 20.

Ensure that the fuel effect does not obstruct the pilot.

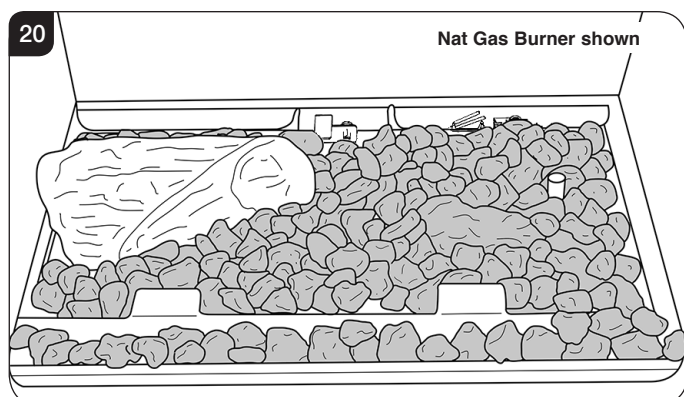

- 6.4 Position the 2 embers on the lip at the front of the fuel bed, see Diagram 21.

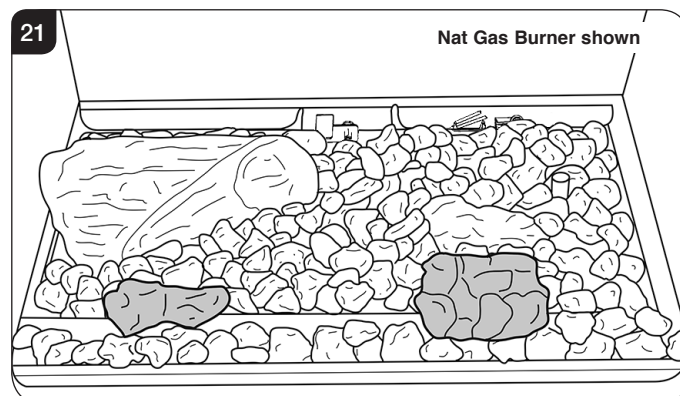

- 6.5 Log B is positioned on the right hand locating pin, and rests against the back liner, see Diagram 22.

Nat Gas only: Log B also rests on the rear burner bracket.

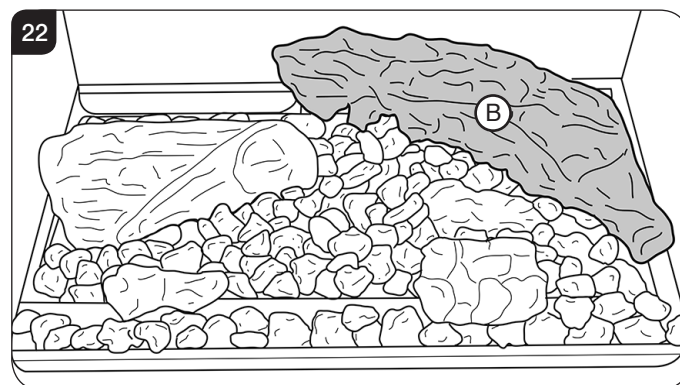

- 6.6 Log C rests on Log A and the front tray with the locating pin facing up, see Diagram 23.

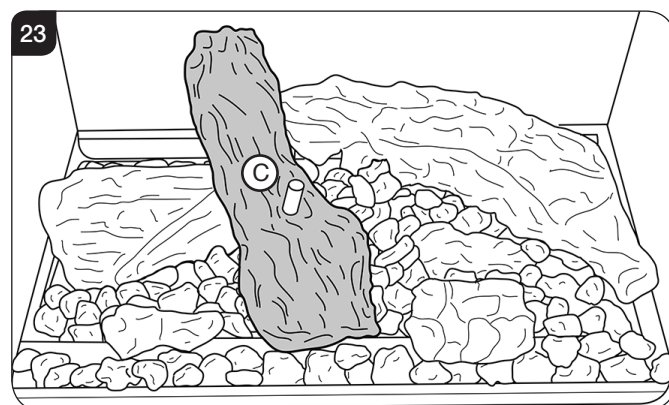

User Instructions

- 6.7 Log D fits onto the locating pin and rests on Log B, see Diagram 24.

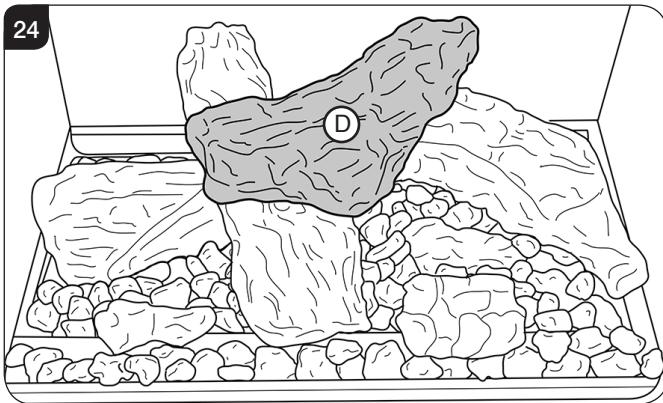

- 7.9 Sparingly spread an amount of the Embaglow fibres provided, covering the ports in the burner tray, on the sections highlighted, see Diagram 25.
Take care not to use more than half a packet per application.

WARNING - DO NOT PLACE NEAR THE PILOT AREA.

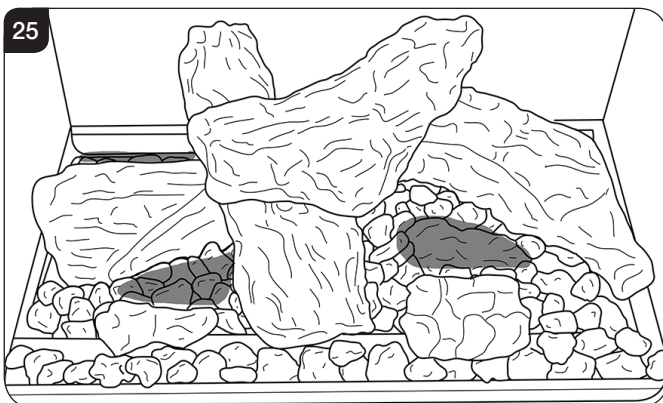

7. Oxygen Depletion Sensor

The appliance is fitted with an oxygen sensitive pilot system that will act to cut off the gas supply to the appliance should the oxygen in the room fall below its normal level. If the appliance is turned off by this device, it usually indicates that there is a problem with the flue system, and this should be inspected by a qualified engineer. **Do not attempt to use the appliance until an engineer says it is safe to do so.**

This device is not a substitute for an independently mounted carbon monoxide detector.

8. Flame Failure Device

- 8.1 This is a safety feature incorporated on this appliance which automatically switches off the gas supply if the pilot goes out and fails to heat the thermocouple.

IF THIS OCCURS DO NOT ATTEMPT TO RELIGHT THE APPLIANCE FOR 3 MINUTES.

9. Running In

- 9.1 During initial use of a new Gazco appliance a strong odour will be encountered as various surface coatings become hot for the first time. Although these odours are harmless it is recommended that the appliance is operated on maximum for 4 to 8 hours in order to fully burn off these coatings. After this period the odours should then disappear.

If the odours persists, please contact your installer for advice.

- 9.2 During the first few hours of burning there may be discolouration of the flames. This will also disappear after a short period of use.

10. Servicing

- 10.1 The appliance must be serviced every 12 months by a qualified GasSafe Engineer. In all correspondence always quote the Model number and the Serial number which may be found on the Commissioning Checklist (Page 3).

11. Ventilation

- 11.1 Any purpose provided ventilation should be checked periodically to ensure that it is free from obstruction.

12. Installation Details

- 12.1 Your installer should have completed the commissioning sheet at the front of this book. This records the essential installation details of the appliance. In all correspondence always quote the Model number and Serial number.

13. Hot Surfaces

- 13.1 Parts of this appliance become hot during normal use. Regard all parts of the appliance as a 'working surface', except for the access to the controls.
- 13.2 Provide a suitable fire guard to protect young children and the infirm.

Installation Instructions

Technical Specification

Covering the following models:

	Sheraton 5
Nat Gas	505-014
LPG	505-428

Model	Gas CAT.	Gas Type	Working Pressure	Aeration	Injector	Gas Rate m ³ /h	Input kW (Gross)		Country
							High	Low	
Sheraton 5	I ₂ H	Natural Gas G20	20mbar	2 x 5.5mm Ø	360	0.553	5.8	2.9	GB, IE
	I ₃ P	Propane G31	37mbar	2 x 14mm Ø	120	0.203	5.4	2.8	
Efficiency Class 2 - 76% Net									
Flue Outlet Size TOP/REAR EXIT 127mm (5") ø									
Gas Inlet Connection Size 8mm ø									
Minimum flue specification T250 / N2 / O / D / 1									
Maximum flue temperature 240°C									

i The net efficiency of these appliances have been measured as specified in EN613:2001 and the result after conversion to gross using the appropriate factor from Table E4 of SAP 2012 is 68.5%. The test data has been certified by Kiwa Nederand BV. The gross efficiency value may be used in the UK Government's Standard Assessment Procedure (SAP) for energy rating of dwellings.

Installation Instructions

Technical Specification

This appliance has been certified for use in countries other than those stated. To install this appliance in these countries, it is essential to obtain the translated instructions and in some cases the appliance will require modification. Contact Gazco for further information.

PACKING CHECKLIST

Qty Description	Fixing Kit containing:-
1 x Appliance	1 x Instruction manual
1 x Flue Blanking plate	1 x Embaglow
1 x Log set*	
*Packed in appliance	

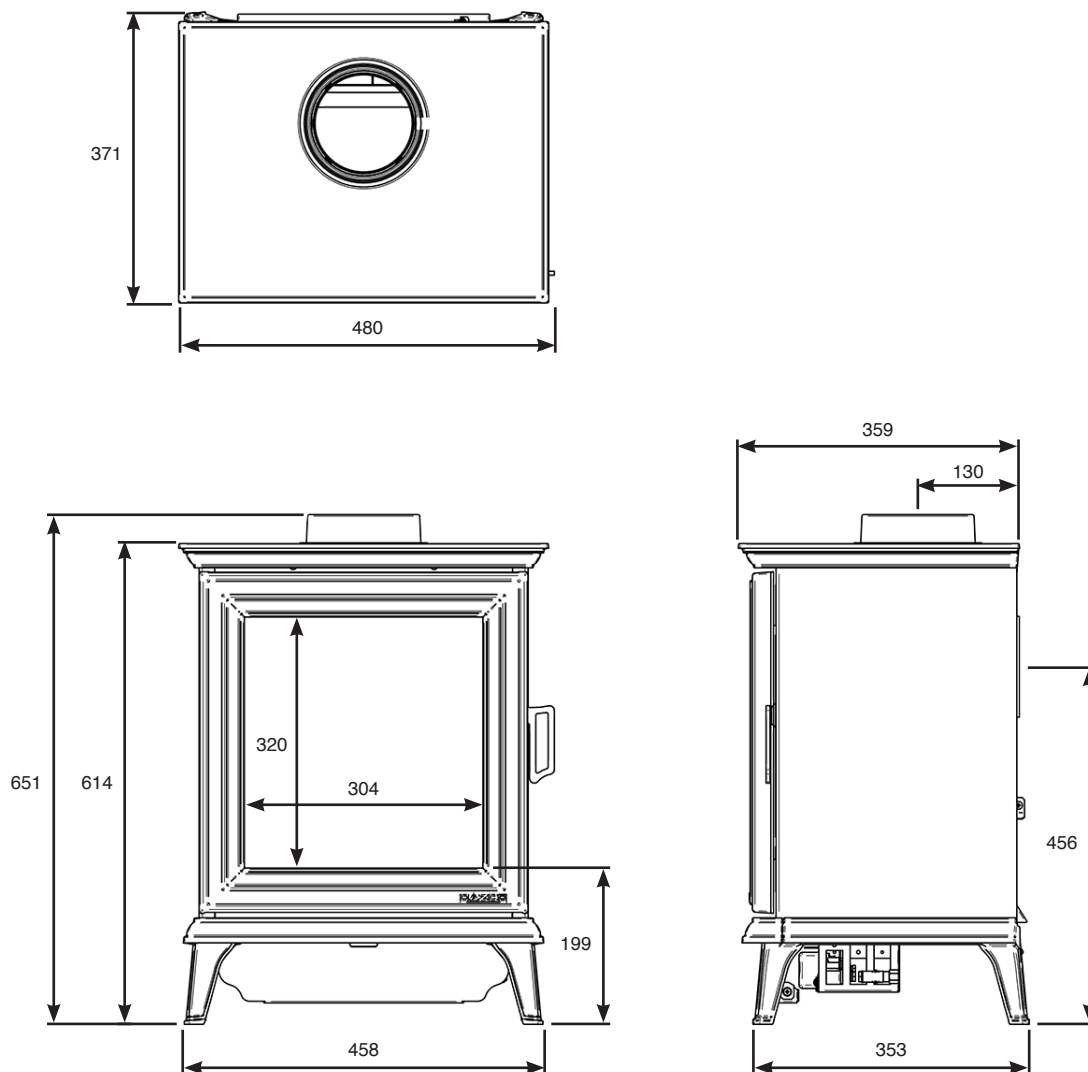

Installation Instructions

Site Requirements

1. Flue & Chimney Requirements

WHEN INSTALLING A FLUE SYSTEM PLEASE REFER TO THE MANUFACTURERS INSTRUCTIONS.

- 1.1 The European chimney standards now describe chimneys and flues by their temperature, pressure and resistance to corrosion, condensation and fire. To identify the correct flue system, the minimum flue specification is shown in the Technical Specification. Existing chimneys are not covered by this system.
- 1.2 The chimney or flue system must comply with the rules in force, and must be a minimum of 127mm (5") in diameter.
- 1.3 A 5" (127mm) liner must be used if fitting the appliance into an existing brick built chimney. Larger lined flues can work, but in some instances could cause cold start flue problems resulting in nuisance shutdown. Lined flues above 7" (175mm) are not recommended.

Suitable systems are:

- a) Flexible liner which must be continuous from the appliance spigot to the roof terminal.
- b) Gazco Linerless kit.

UNDER NO CIRCUMSTANCES MUST THE LINERLESS KIT BE USED WITH ANY INSTALLATION OTHER THAN AN EXISTING MASONRY CHIMNEY WHICH HAS A MINIMUM DIAMETER OF 178mm (7"). THE CHIMNEY MUST BE SOUND AND CLEAN. IF PREVIOUSLY USED FOR SOLID FUEL, IT MUST BE SWEEPED PRIOR TO PROCEEDING WITH THE INSTALLATION.

NOTE: If the Linerless kit is to be used, due care should be taken to prevent condensation forming in the chimney. Do not fit the Linerless Kit if the chimney is taller than 10 metres (external wall) or 12 metres (internal wall).

- 1.4 The minimum flue height for the appliance must be 3 metres (10ft). Any horizontal flue run from the rear outlet must not exceed 100mm from the back of the appliance.
- 1.5 The chimney or flue must be free from any obstruction. Any damper plates must be removed or secured in the fully open position, and no restrictor plates fitted.
- 1.6 The chimney must be swept prior to the installation, but it need not be swept if it can be seen the chimney is clean and unobstructed throughout its entire length.

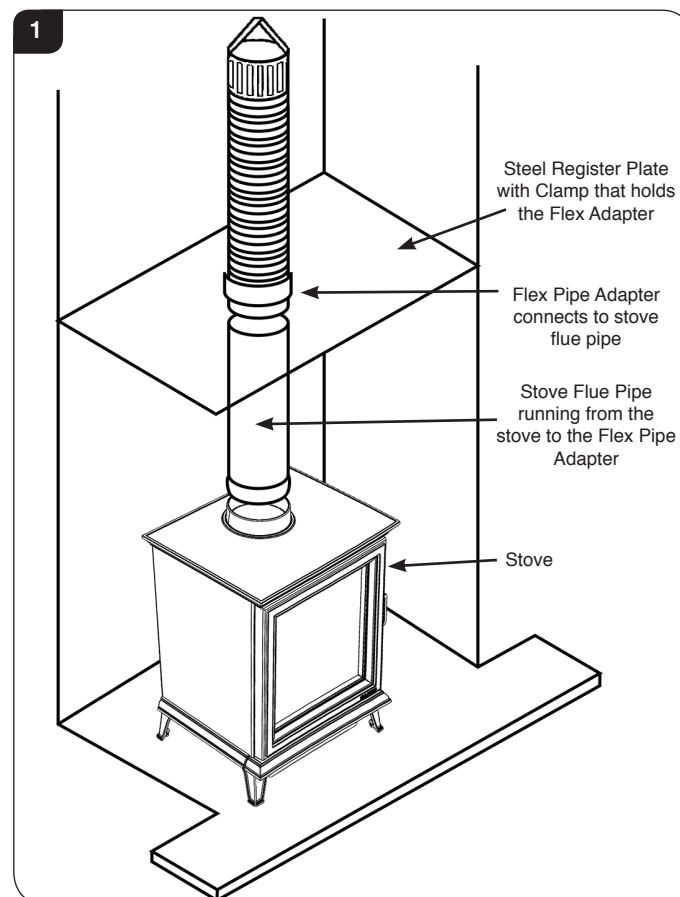

2. Flue Options

A range of Vitreous Enamel Gloss Black flue pipe is available to compliment the Sheraton 5. Please contact your Gazco retailer for further information.

Installation Instructions

Site Requirements

3. Gas Supply

THIS APPLIANCE IS INTENDED FOR USE ON A GAS INSTALLATION WITH A GOVERNED METER.

- 3.1 Before installation, ensure that the local distribution conditions (identification of the type of gas and pressure) and the adjustment of the appliance are compatible.
- 3.2 Ensure the gas supply delivers the required amount of gas and is in accordance with the rules in force.
- 3.3 You can use soft copper tubing on the installation and soft soldered joints outside the appliance and below the fire.
- 3.4 A means of isolating the gas supply to the appliance must be provided independent of any appliance control.
- 3.5 All supply gas pipes must be purged of any debris that may have entered prior to connection to the appliance.
- 3.6 The gas supply must be installed in a way that does not restrict the removal of the appliance for servicing and inspection.

4. Ventilation

IMPORTANT: Ensure any national ventilation requirements are taken into account during installation of the appliance.

FOR THE REPUBLIC OF IRELAND REFER TO THE RULES IN FORCE FOR VENTILATION REQUIREMENTS.

5. Appliance Location

- 5.1 Building Regulations state this appliance must stand on a non-combustible hearth that is at least 12mm thick and projects 50mm minimum from the base of the appliance in all directions, however Gazco recommend the hearth extends to the following dimensions, see Diagram 2.

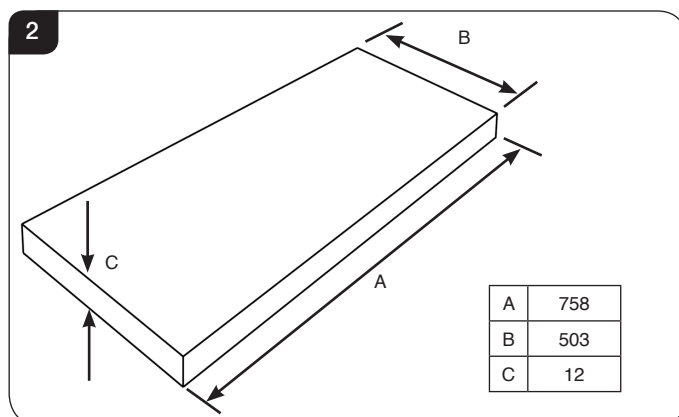

MINIMUM CLEARANCE

- 5.2 The appliance is not suitable for installation against a combustible wall.
- 5.3 Ensure that all minimum clearances to combustible materials are complied with, see Diagrams 3 and 4.

The specified clearances provide the minimum distance to combustible materials. If the appliance is intended to be installed into a non-combustible opening the clearance to the **sides and above** the appliance can be reduced. However, it is recommended that the specified clearances are maintained irrespective of the materials used in the construction of the opening to allow adequate air flow and access to controls. **The clearance at the rear of the appliance must always be a minimum of 50mm.**

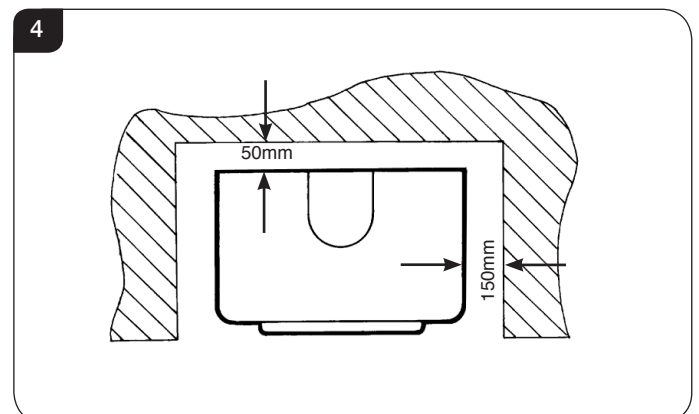
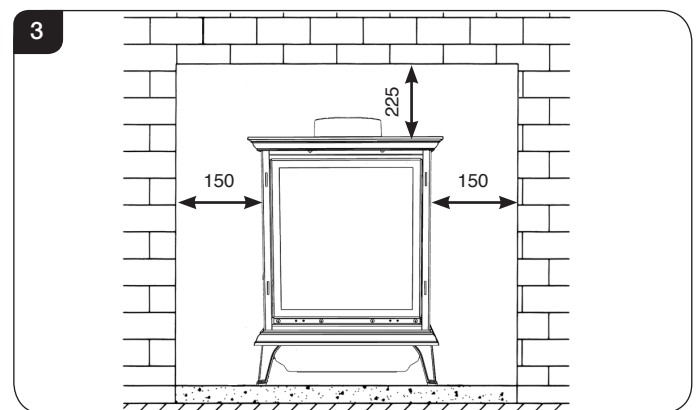

- 5.4 In a non-combustible recess be careful to allow enough clearance at the sides and rear of the appliance to perform spillage tests and reach the controls.

Installation Instructions

1. Safety Precautions

- 1.1 For your own and other's safety, you must install this appliance according to local and national codes of practice. Failure to install the appliance correctly could lead to prosecution. **Read these instructions before installing and using this appliance.**
- 1.2 These instructions must be left intact with the user.
- 1.3 Do not attempt to burn rubbish on this appliance.
- 1.4 Keep all plastic bags away from young children.
- 1.5 Do not place any object on or near to the appliance and allow adequate clearance above the appliance.

IF THE APPLIANCE IS EXTINGUISHED OR GOES OUT IN USE, WAIT 3 MINUTES BEFORE ATTEMPTING TO RELIGHT THE APPLIANCE.

- 1.6 The appliance is fitted with the Gazco Flue Sure System, which will act to cut off the gas supply to the burners in the event of incorrect operation of the flue. If the system acts to cut off the gas supply, this indicates that there is insufficient flue pull. If this occurs a minimum of 10 minutes should be allowed before trying to relight. Continued operation of this safety device means there may be a serious problem with the flue system. A qualified GasSafe engineer should inspect this.
- 1.7 Do not alter or tamper with the Flue Sure System. Use only genuine Gazco replacement parts when servicing the system - refer to the Servicing Section, **Replacing Parts**.

DO NOT USE THE APPLIANCE UNTIL AN ENGINEER SAYS IT IS SAFE TO DO SO.



IMPORTANT: REFER TO DATA BADGE AND TECHNICAL SPECIFICATION AT THE FRONT OF THE MANUAL TO ENSURE THE APPLIANCE IS CORRECTLY ADJUSTED FOR THE GAS TYPE AND CATEGORY APPLICABLE IN THE COUNTRY OF USE.

FOR DETAILS OF CHANGING BETWEEN GAS TYPES REFER TO SERVICING, SECTION 12, REPLACING PARTS.

Unpacking

- 1.8 Remove the appliance from its packaging, and check that it is complete and undamaged.

Put the loose ceramic parts to one side so that they are not damaged during installation.

2. Installation of the Appliance

- 2.1 Decide whether to use top or rear flue exit. The appliance is factory built for top flue exit but it can be changed to rear exit by swapping the flue spigot and blanking plate located on the appliance.
- 2.2 Position the appliance ensuring all appropriate clearances are observed.
- 2.3 Lower the drop down vanity cover to access the controls see Diagram 1.

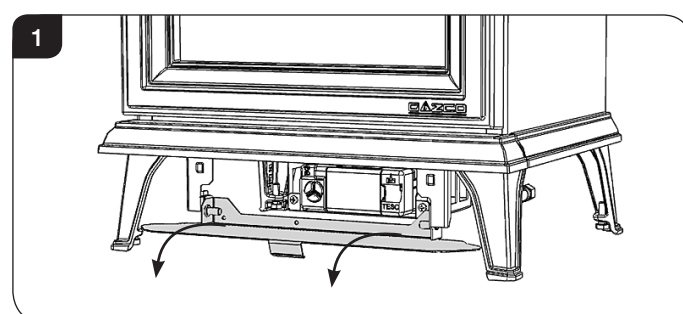

- 2.4 Having run the gas supply to the appliance **PURGE THE SUPPLY PIPE.** This is essential to expel any debris that can block the gas controls.
- 2.5 Connect the gas supply to the 8mm compression elbow at the right-hand front corner of the appliance.

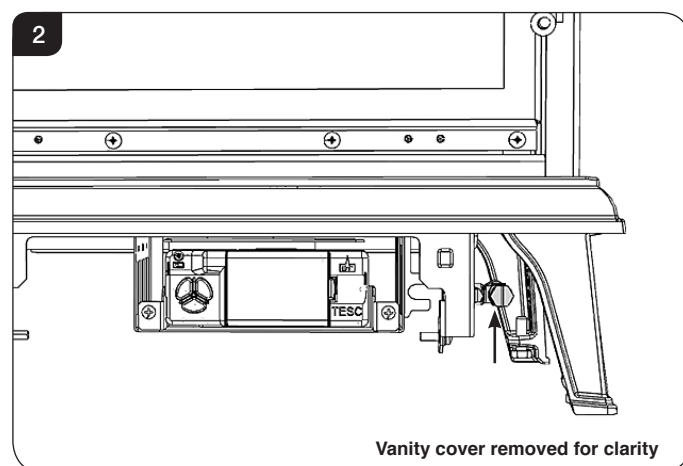

- 2.6 The flue system can now be connected to the appliance.
- 2.7 Ensure all joints are sealed with a fire resistant cement and use a self-tapping screw at the flue spigot joint.

3. Gas Soundness Pressure Check

- 3.1 Connect a suitable pressure gauge to the test point located on the inlet fitting and turn the gas supply on. Light the appliance and check all gas joints for possible leaks. Turn the appliance to maximum and check that the supply pressure is as stated on the databadge. Turn the gas off and replace the test point screw, turn the gas on and check the test point for leaks.

4. Removing the Door



IMPORTANT: THE OUTER PANELLING AND DOOR OF THE APPLIANCE IS MADE FROM CAST IRON. TAKE CARE WHEN INSTALLING, REMOVING AND STORING TO AVOID DAMAGING THE OUTER CASING, HEARTH OR DOOR.

- 4.1 The ceramic logs are located behind the door.
- 4.2 Remove the frame to gain access to the viewing aperture by lifting the hooks clear of the slots on the front of the appliance, see Diagram 3.

Note: This will lift the cast top slightly.

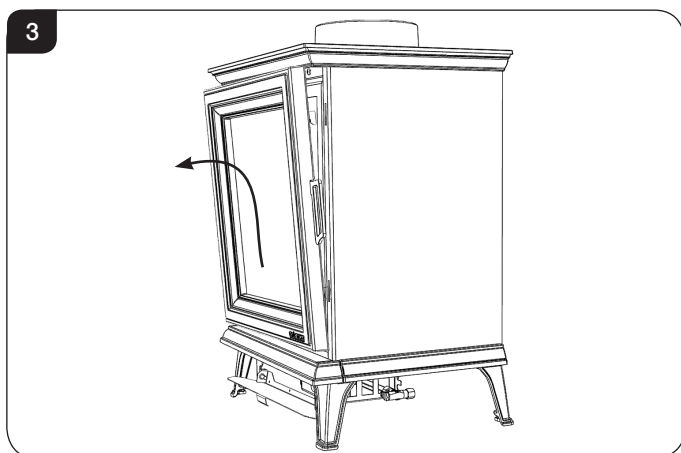

- 4.3 Using a screwdriver remove the 4 screws securing the window panel to the appliance, see Diagrams 4.

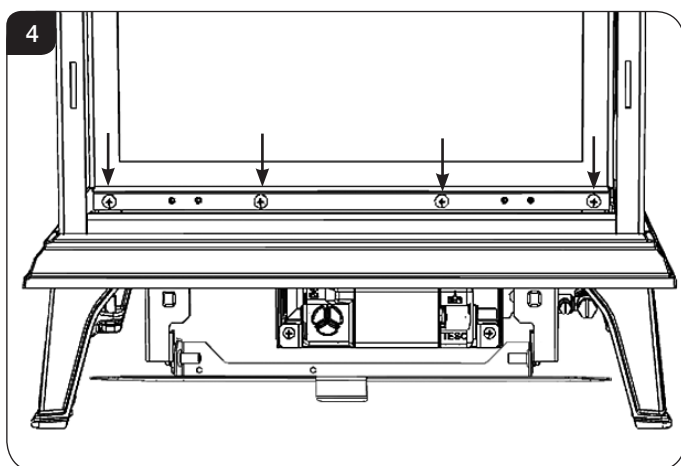

- 4.4 The frame can be removed by pulling the lower edge of the window panel forward and lifting the top return off the firebox, see Diagram 5.

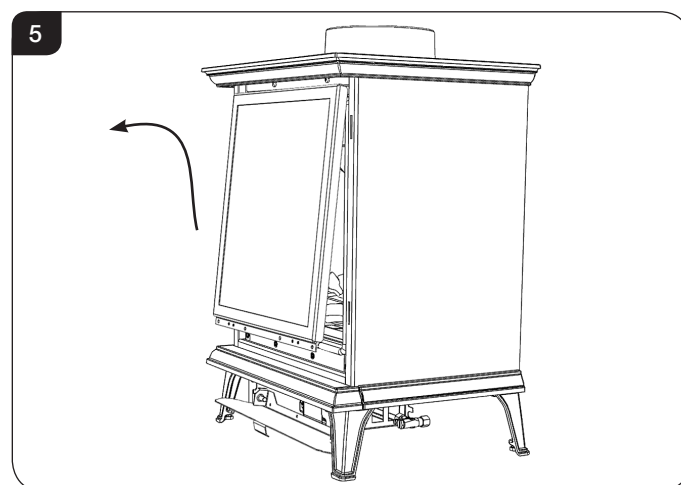

- 4.5 Place carefully to one side.
Remove the box and place in a safe location.

5. Arrangement of Fuel Bed

Advice on handling and disposal of fire ceramics



The fuel effect in this appliance are made from Refractory Ceramic Fibre (RCF), a material which is commonly used for this application.

Protective clothing is not required when handling these articles, but we recommend you follow normal hygiene rules of not smoking, eating or drinking in the work area and always wash your hands before eating or drinking.

To ensure that the release of RCF fibres are kept to a minimum, during installation and servicing a HEPA filtered vacuum is recommended to remove any dust accumulated in and around the appliance before and after working on it. When servicing the appliance it is recommended that the replaced items are not broken up, but are sealed within heavy duty polythene bags and labelled as RCF waste.

RCF waste is classed as stable, non-reactive hazardous waste and may be disposed of at a licensed landfill site.

Excessive exposure to these materials may cause temporary irritation to eyes, skin and respiratory tract; wash hands thoroughly after handling the material.

Installation Instructions

6. Log Layout

LOGS MUST BE POSITIONED ACCORDING TO THE FOLLOWING INSTRUCTIONS TO GIVE THE CORRECT FLAME EFFECT.

All logs can be identified by a letter (A - D) on their underside. Logs A and B have holes to locate each onto a burner stud.

- 6.1 Ensure the burner tray is clean and free from any debris, see Diagram 6.

Note: The LPG and Nat Gas burner trays are visually different but the log layouts are the same.

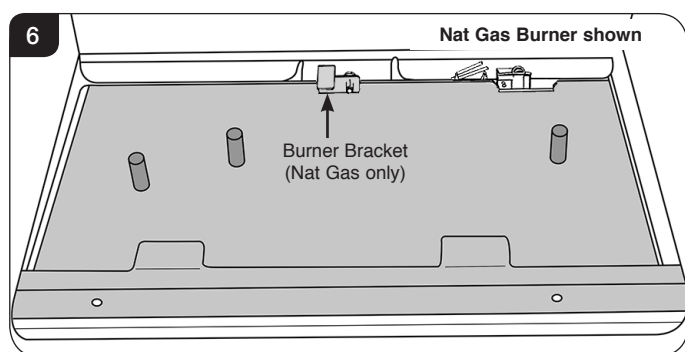

- 6.2 Place Log A in position on the 2 locating pins, see Diagram 7.

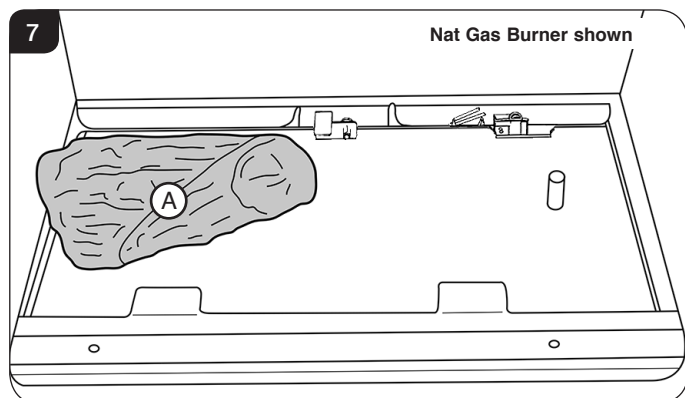

- 6.3 Spread the Lava Rock evenly over the fuel bed and around Log A, see Diagram 8.

Ensure that the fuel effect does not obstruct the pilot.

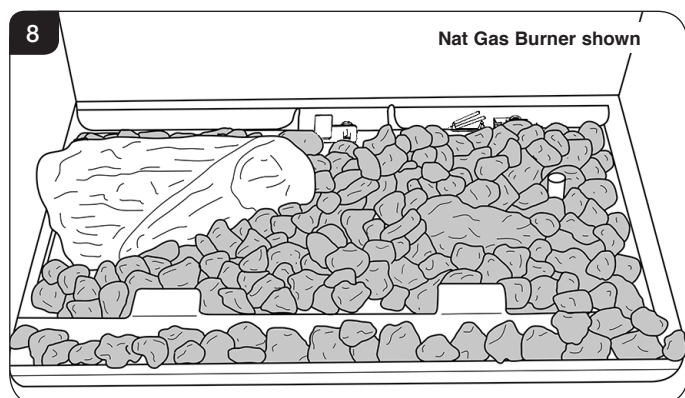

- 6.4 Position the 2 embers on the lip at the front of the fuel bed, see Diagram 9.

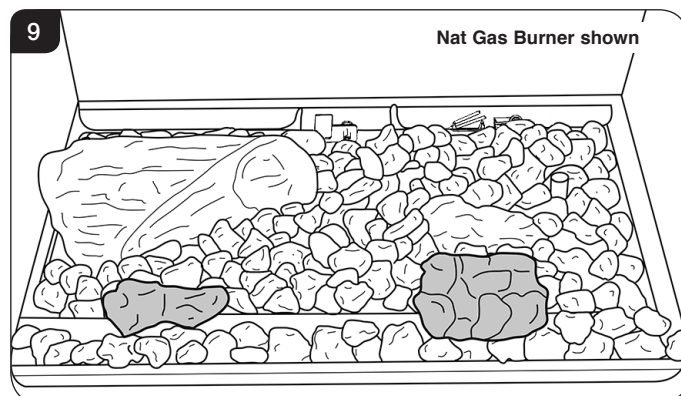

- 6.5 Log B is positioned on the right hand locating pin, and rests against the back liner, see Diagram 10.

Nat Gas only: Log B also rests on the rear burner bracket.

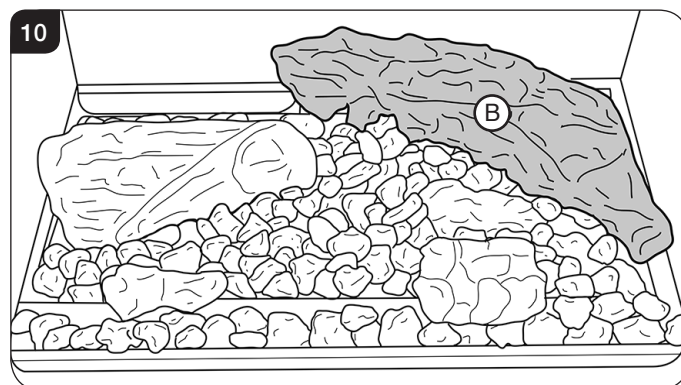

- 6.6 Log C rests on Log A and the front tray with the locating pin facing up, see Diagram 11.

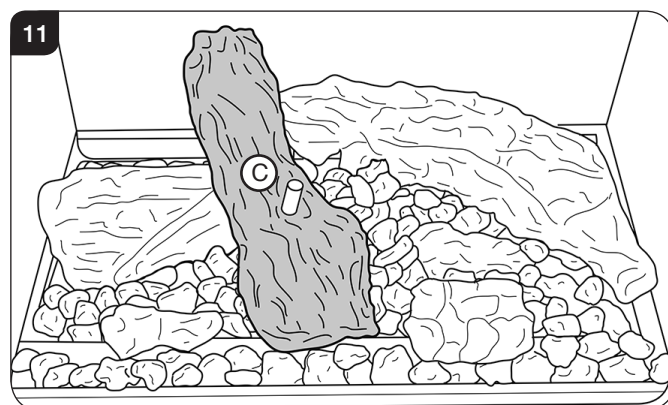

Installation Instructions

- 6.7 Log D fits onto the locating pin and rests on Log B, see Diagram 12.

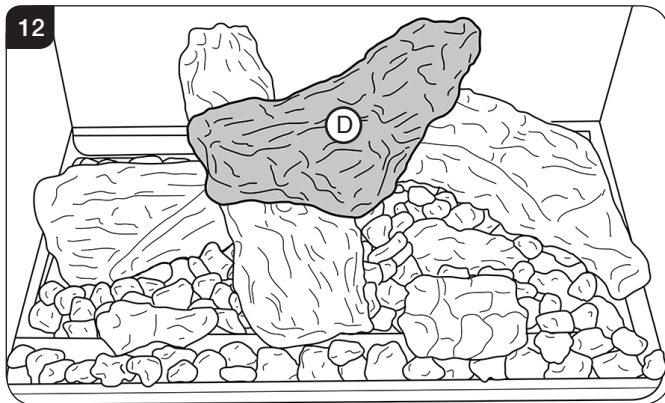

- 6.8 Sparingly spread an amount of the Embaglow fibres provided, covering the ports in the burner tray, on the sections highlighted, see Diagram 13. Take care not to use more than half a packet per application.

WARNING - DO NOT PLACE NEAR THE PILOT AREA.

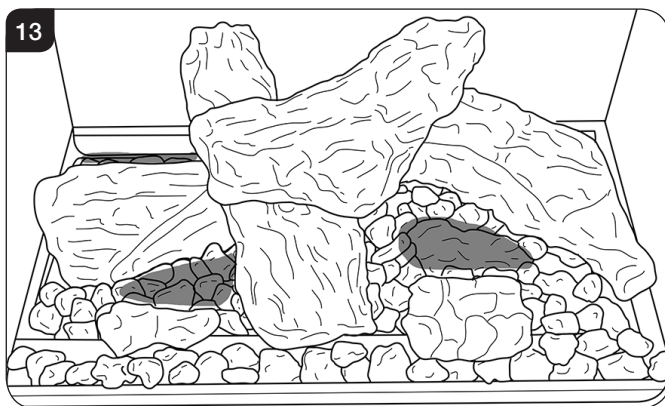

7. Completion of Assembly

To fit the window frame:

- 7.1 Hook the top return of the glass panel over the top of the firebox and ensure it is central.

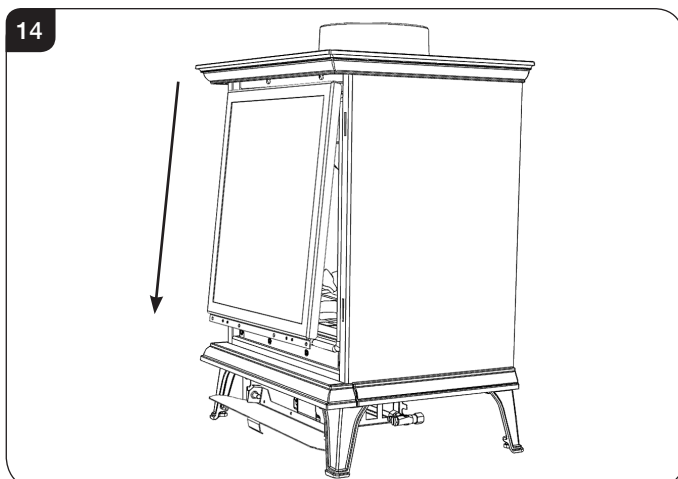

- 7.2 Push the lower edge towards the firebox and secure with the 4 screws.

- 7.3 Replace ALL of the glass frame securing screws ensuring that a screw is present in all fixing slots, see Diagram 15.

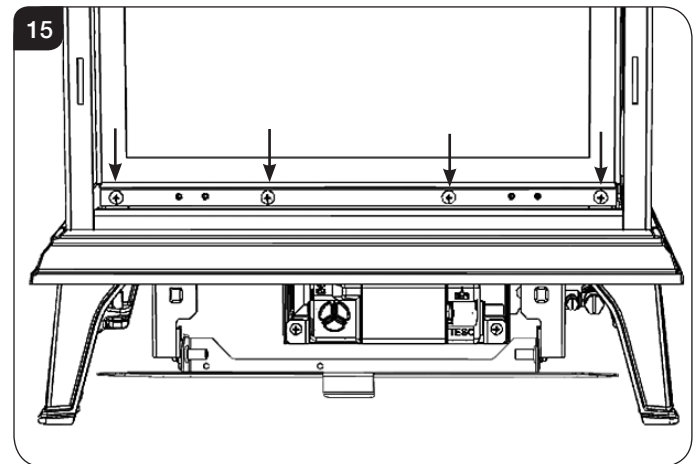

! UNDER NO CIRCUMSTANCES SHOULD THE APPLIANCE BE USED IF ANY OF THE GLASS FRAME RETAINING SCREWS ARE LOOSE OR MISSING.

- 7.4 Lift the cast lid slightly and fit the front by inserting the hooks on the back of the frame into the slots on the front of the appliance, see Diagram 16.

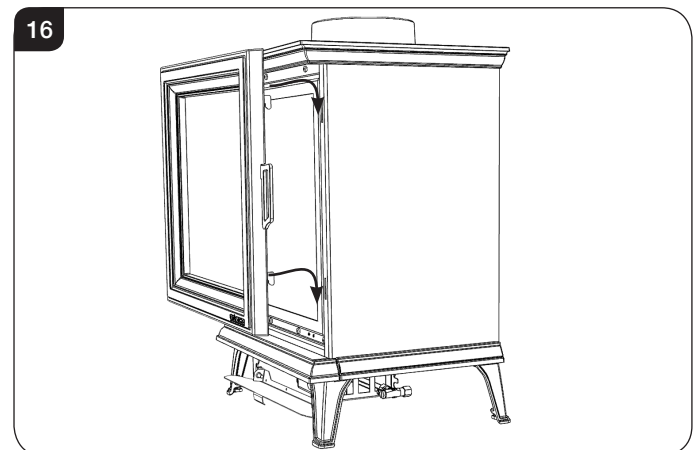

Installation Instructions

8. Operating the Appliance

There are two ways of lighting the appliance:

- 8a. Using the Manual Controls on the Control Box (located on the appliance)
- 8b. By thermostatic remote control

8a. Manual Operation (Control Box)

- 8a.1 The manual controls are located on the Control Box behind the drop down vanity cover, see Diagram 17.

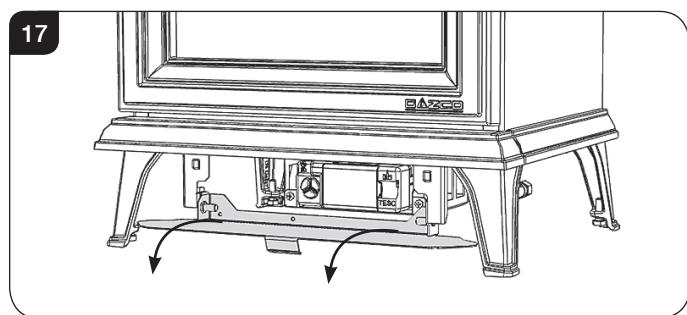

- 8a.2 There are a series of buttons on the left hand side of the Control Box, see Diagram 18.

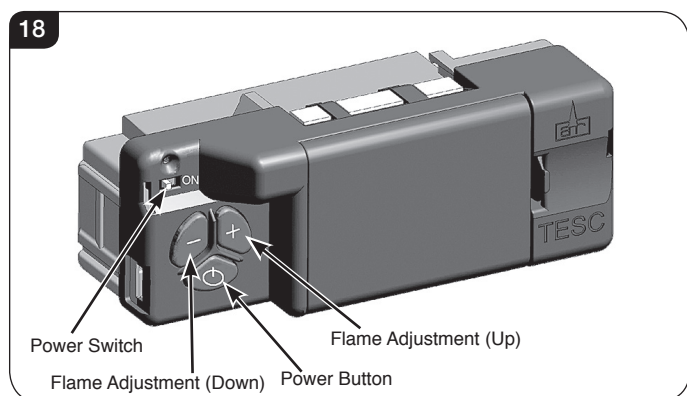

To operate the appliance the Power Switch on the Control Box must be switched ON (I).

Note: The Power Switch does not need to be turned off each time the appliance is not in use. However, if the appliance is left unattended for long periods of time (e.g. vacation), it is recommended to place the Power Switch into the off position.

Turning the appliance on:

- 8a.3 Press and hold the  Power Button for 1 second and release.
The burner will light approximately 2 to 3 seconds later.
- 8a.4 Use + and - buttons to adjust the flame height between Minimum and Maximum.

Turning the appliance off

- 8a.5 Press the  power button to turn the appliance off.

IMPORTANT: YELLOW FLAMES TYPICALLY APPEAR WHEN THE APPLIANCE HAS REACHED NORMAL OPERATING TEMPERATURE. THIS CAN TAKE UP TO 30 MINUTES.

WARNING: IF THE APPLIANCE FAILS TO LIGHT OR BECOMES EXTINGUISHED IN USE, WAIT 3 MINUTES BEFORE ATTEMPTING TO RELIGHT.

THE APPLIANCE WILL TAKE 3 AUTOMATIC ATTEMPTS TO RESTART.
DO NOT INTERRUPT THE VALVE DURING THIS PROCESS.

8b. Remote Control

To operate the appliance the Power Switch on the Control Box must be switched ON (I).

IMPORTANT: To activate the Remote Control it will be necessary to cradle the handset to unlock. The green light will illuminate to show the handset is ready to use. Continue to cradle the handset throughout an operation to keep it unlocked. If the green light goes off during an operation it will be necessary to reposition the handset so the light comes back on and restart the operation.

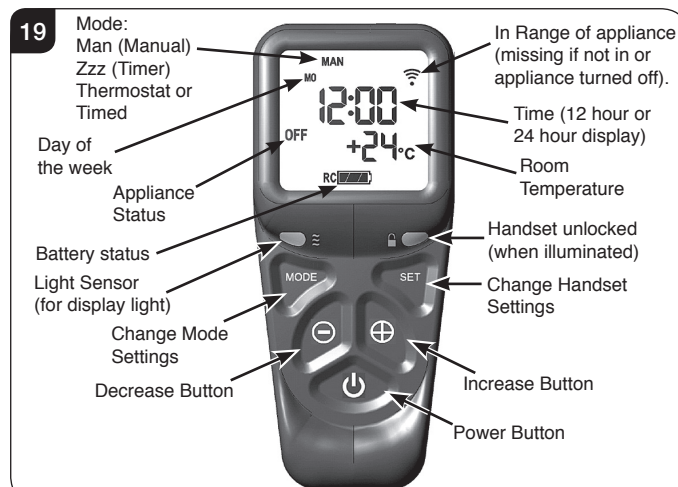

Handset Initial Set Up

Following initial set up or new pairing it will be necessary to set the time and date.

i **Note:** Pressing SET button will advance the display to the next screen and pressing MODE button will return it to the previous setting.

Setting the Time

8b.1 Once the handset is paired the screen will show that the time is not yet set. The handset will then automatically progress to the next setup screen, see Diagram 20.



Setting the display for 12 or 24 Hour Clock

8b.2 Holding the remote to keep the green light on and the handset unlocked the handset will display an H:24, see Diagram 21.



24 denotes a 24 hour clock and 12 denotes a 12 hour clock.

8b.3 Press the + or - button on the handset to toggle between the two settings. Press the SET button to confirm and progress to setting the day of the week.

Setting the Day of the Week

8b.4 Press and release the + and - buttons until the correct day of the week is shown on the display.



Mo = Monday, **Tu** = Tuesday, **We** = Wednesday, **Th** = Thursday, **Fr** = Friday, **Sa** = Saturday and **Su** = Sunday.

8b.5 Press SET to confirm the day of the week and progress to setting the time.

Setting the Hour

8b.6 Press and release the + or - button to change the hour to the correct hour. Press SET to confirm and progress to setting the minute.



Setting the Minutes

8b.7 Repeat the process to change the minutes.

Setting the Temperature Display (Celsius or Fahrenheit)

8b.8 Press and release the + or - button to toggle between C and F. When the display shows the desired symbol, press and release the SET button to store.



Installation Instructions

- 8b.9 Place the handset down and wait until the home screen is displayed and the unlock light goes off.



ALL THE NECESSARY SETTINGS REQUIRED HAVE NOW BEEN COMPLETED. ANY FURTHER FUNCTIONS ON THIS HANDSET ARE FOR FACTORY SETTING AND NOT TO BE USED.

The Handset is now ready to operate the appliance.

Operating the Appliance

Turning the appliance on

- 8b.10 Press the  Power Button until Pilot flashes on the display.

- 8b.11 Release the  Power Button and the Flame symbol will appear on the display.

If the button is held the command will be cancelled for safety reasons.

- 8b.12 Holding the handset to unlock, use + and - buttons to adjust the flame height between Minimum and Maximum.

Turning the appliance off

- 8b.13 Holding the handset to unlock, press the power button to turn the appliance off.



IMPORTANT: YELLOW FLAMES TYPICALLY APPEAR WHEN THE APPLIANCE HAS REACHED NORMAL OPERATING TEMPERATURE. THIS CAN TAKE UP TO 30 MINUTES.



WARNING: IF THE APPLIANCE FAILS TO LIGHT OR BECOMES EXTINGUISHED IN USE, WAIT 3 MINUTES BEFORE ATTEMPTING TO RELIGHT.

THE APPLIANCE WILL TAKE 3 AUTOMATIC ATTEMPTS TO RESTART. DO NOT INTERRUPT THE VALVE DURING THIS PROCESS.

Commissioning

1. Commissioning

- 1.1 Close all doors and windows in the room.
- 1.2 Ignite the appliance and operate on maximum for 10 minutes.
- 1.3 Position a lighted smoke match just inside the draught diverter opening at the rear of the appliance.
- 1.4 Check all smoke is drawn into the opening, see Diagram 1.

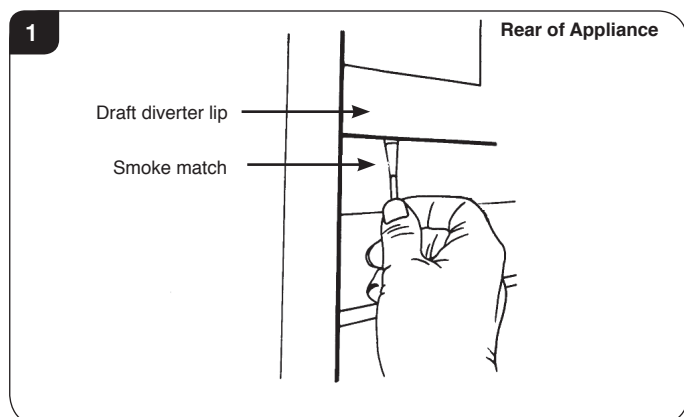

- 1.5 If there is any doubt, run the appliance for a further 10 minutes, and repeat the test.
- 1.6 If there are any extractor fans in adjacent rooms, the test must be repeated with the fans running on maximum and interconnecting doors open.

IF SPILLAGE PERSISTS, DISCONNECT THE APPLIANCE AND SEEK EXPERT ADVICE.

- 1.7 Complete the Commissioning Checklist at the front of this manual covering:
 - Thermocouple soundness checks.
This is to include ensuring the thermocouple is secure on the pilot bracket assembly, lead connection and integrity.
 - Flue checks
 - Gas checks
 - Log layout - flame picture
- 1.8 Upon completion of the commissioning and testing of the installation and correct operation of the appliance, the installer must instruct the user how to operate the appliance.
- 1.9 Guide the user through the User Instructions paying particular attention to:
 - a) Regular servicing (Section 10 of the User Instructions).
 - b) Ventilation (Section 11 of the User Instructions) - point out the ventilation positions where applicable.
 - c) Hot surfaces (Section 13 of the User Instructions).

2. Pairing the Appliance

It may be necessary to pair the handset to the appliance following servicing.

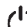
- 2.1 Ensure the Power switch on the Control Box is in the ON (I) position.
- 2.2 Cradle the handset to unlock.
The green light must be illuminated for the handset to accept commands.
- 2.3 Simultaneously press and hold the - and + buttons on the Control Box, until the red light flashes on the Control Box.
- 2.4 Release the - and + buttons and within 1 second press the  Power Button on the Control Box.

The handset emits a short beep, the green light on the handset flashes and the following icon is displayed, see Diagram 2.



- 2.5 With the display showing the icon press and hold the SET button to pair the handset to the appliance.
- 2.6 Following new pairing it will be necessary to set the time and date, see Installation Instructions, Section 11b.

If too much time passes without the SET command the display will show the following, see Diagram 3.



The handset has not paired and the process will need to be started again.

Servicing Instructions

Servicing/Fault Finding Charts

1. Servicing Requirements

IMPORTANT – The glass panel on this appliance should be checked for any signs of damage on the front face of the glass panel (scratches, scores, cracks or other surface defects). If damage is observed, the glass panel must be replaced and the appliance must not be used until a replacement is installed. Under no circumstances should the appliance be used if any damage is observed. Please isolate the appliance until a replacement glass panel has been obtained and installed. Replacement glass panels can be purchased from Gazco via the retailer from which the appliance was purchased or any other Gazco distributor.

This appliance must be serviced at least once a year by a competent person.

All tests must be carried out in accordance with the current GasSafe recommendations.

1.1 Before Testing:

- Conduct a gas soundness test for the property ensuring there are no leaks before servicing.
- Check the operation of the appliance before testing.

1.2 Special checks:

- Clean the burner using a vacuum cleaner with a soft brush attachment. Ensure all debris is removed from the burner ports.
- Clean away lint or fluff from the pilot.
- Clean away lint or fluff from under the burner.
- Check the spark gap on the pilot is correct, see Diagram 1.
- Ensure that the glass frame is secured correctly and that all retaining screws are in place.
- Check debris collection space & clean if necessary.

1.3 Correct any faults found during the initial test.

1.4 Re-commission the appliance in accordance with Commissioning Procedures.

1.5 Advise the customer of any remedial work undertaken.

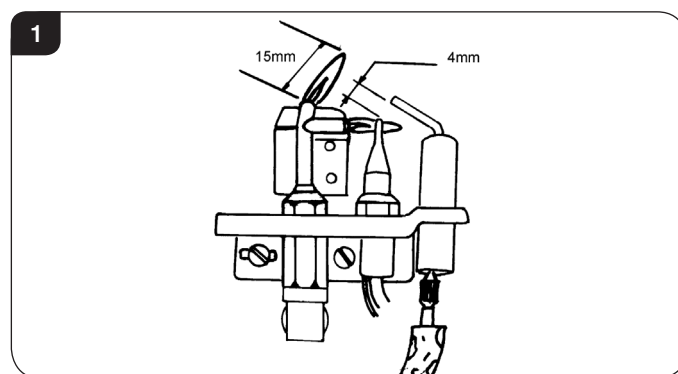

IGNITION FUNCTIONAL CHECK 1

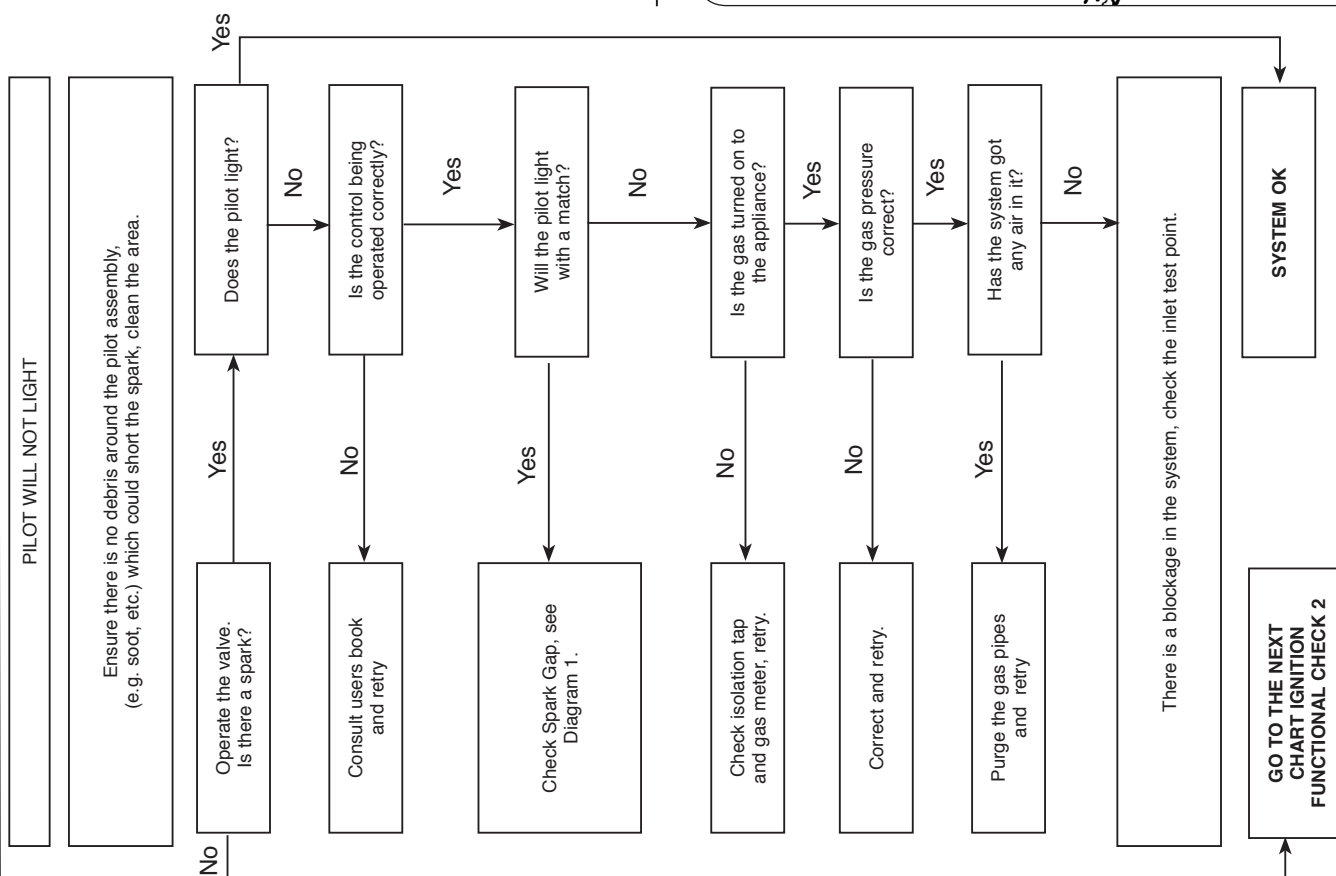

Servicing Instructions

Fault Finding Charts

FLAME FAILURE FUNCTIONAL CHECK

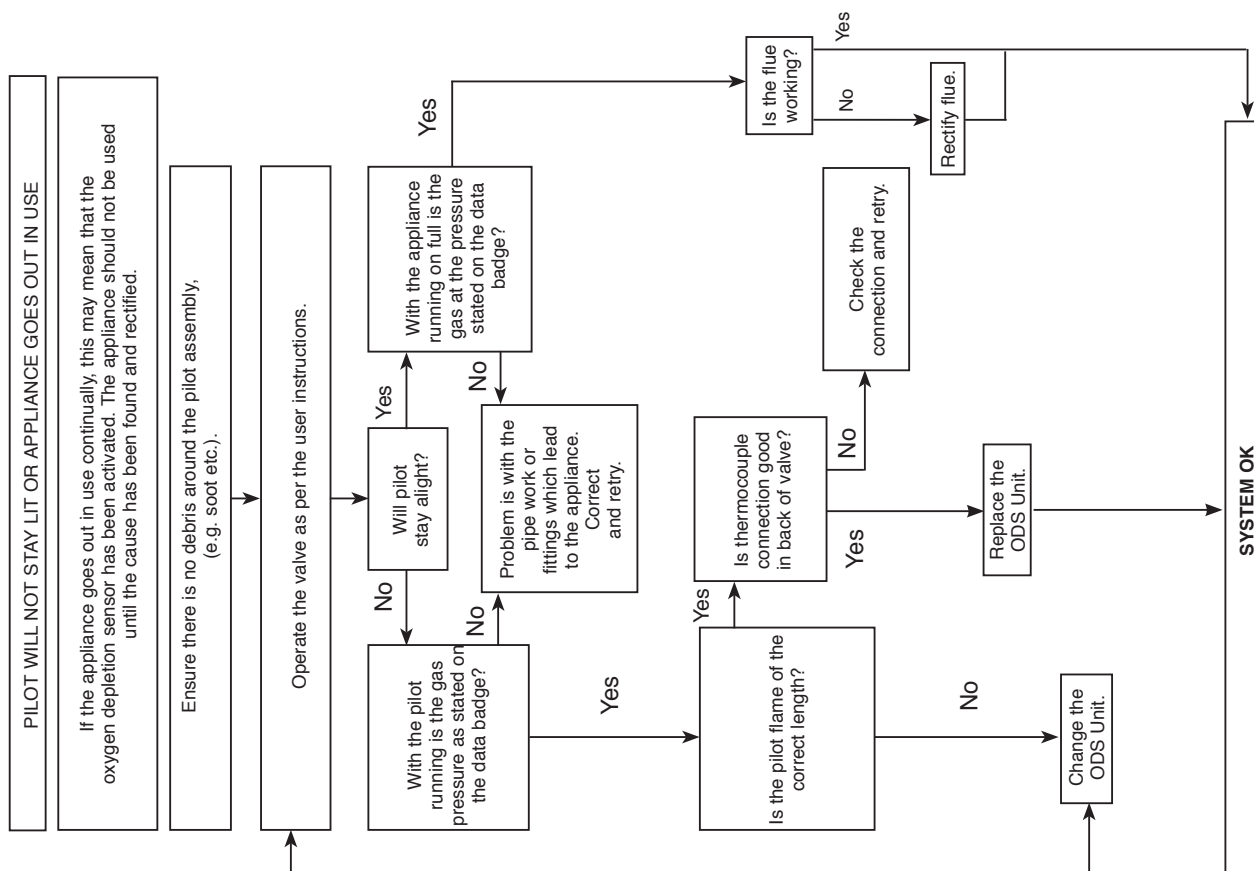

IGNITION FUNCTIONAL CHECK 2

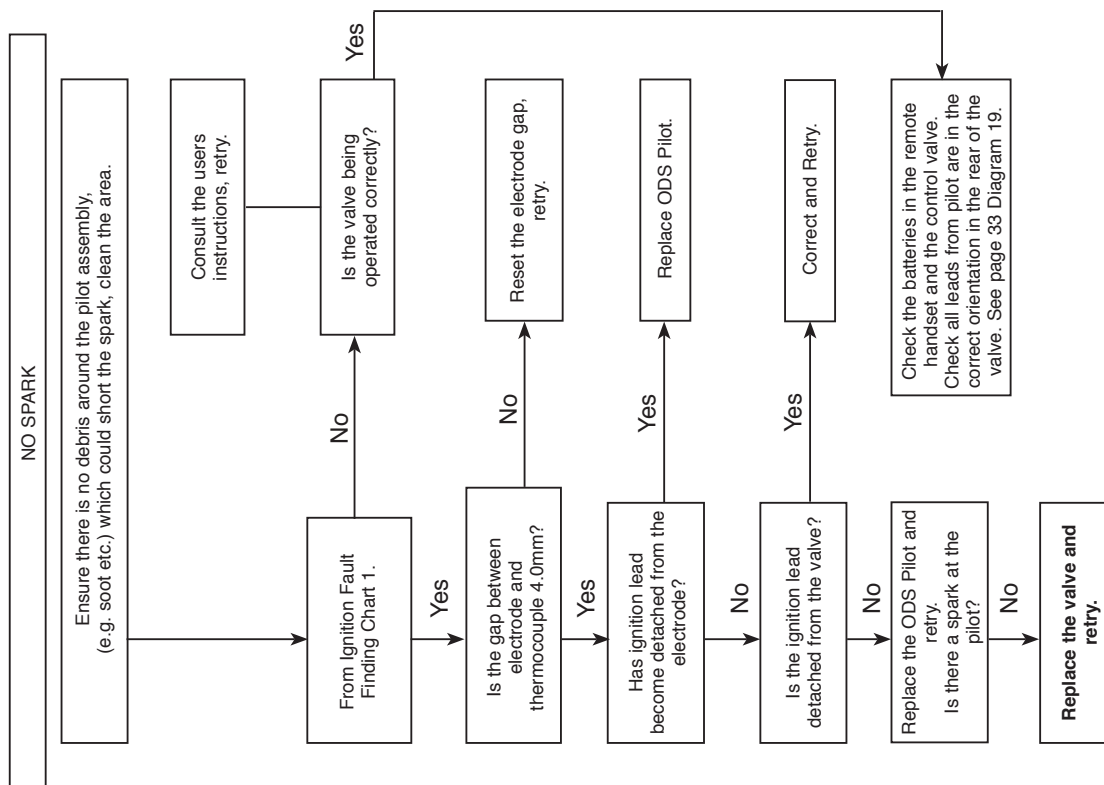

Servicing Instructions

Fault Finding Charts

Electronic Control Valve Fault Analysis

Red Indicator	Meaning
Permanently Lit	Valve tried to light but failed and in LOCKOUT E00
Flashing very fast	Valve is busy (will not accept any command)
Flashing once a second	Valve detects an error
Flashing once every 10 seconds	Indication of low battery power in valve
Flashing twice every 10 seconds (handset only)	Indication of low battery power in handset and valve
Permanently off	Valve in standby or in a stable operation
On momentarily after power up	Valve doing a self test
Appears after pressing start	Indicates time to release pressing the start button

If the valve indicates an error:

Allow the appliance to cool (if hot).

Check the battery status and replace with new if in any doubt.

Reset the error by first pressing the power button (with the appliance cool).
Press once again to start the fire.

If the error repeats refer to the error code table below.

Error Code	Meaning
E00	Valve Locked due to failed ignition.
E01	Indicates that possibly the content of CO is too high in ambient atmosphere.
E02	Ambient temperature around Gas valve in the fire too hot (exceeded 72°C).
E03	Thermocouple connection to valve issue. Incorrect reading from thermocouple.
E04	Flame detected on pilot after valve has shutdown.
E05	Flame detected on pilot before valve has started.
E06 & 07	Occurs when supply voltage is too low to operate the valve.
E24	Occurs when thermocouple does not reach its final temperature within 1 minute.

Servicing Instructions - Replacing Parts

1. General

- 1.1 All main components can be replaced without removing the appliance from its installation.
- 1.2 Ensure the appliance and surrounds are cool before servicing.
- 1.3 Lower the drop down vanity cover to access the isolation device, see Diagram 1.

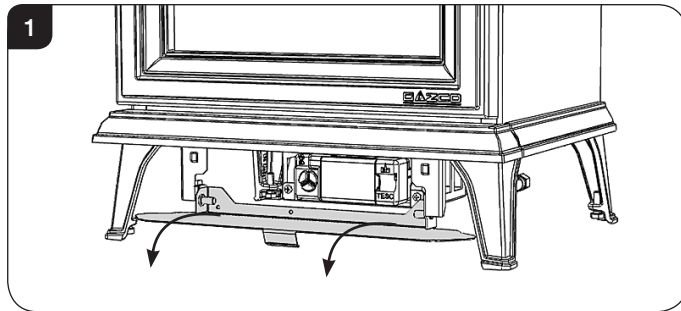

IT IS ESSENTIAL THAT THE GAS SUPPLY TO THE APPLIANCE IS TURNED OFF AT THE ISOLATION DEVICE BEHIND THE VANITY COVER BEFORE PROCEEDING FURTHER.

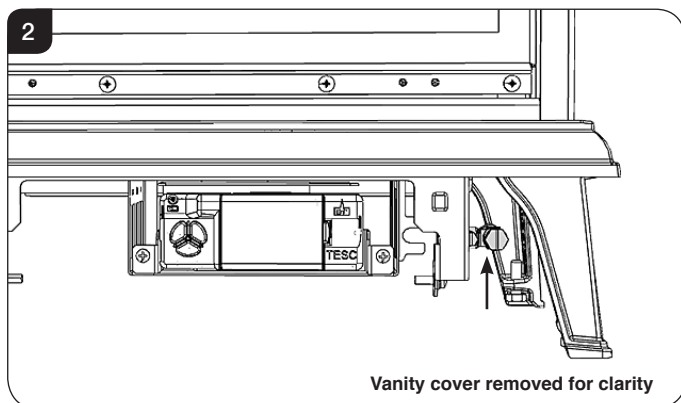

2. Removing the Door



IMPORTANT: THE OUTER PANELLING AND DOOR OF THE APPLIANCE IS MADE FROM CAST IRON. TAKE CARE WHEN INSTALLING, REMOVING AND STORING TO AVOID DAMAGING THE OUTER CASING, HEARTH OR DOOR.

- 2.1 The ceramic logs are located behind the door.
- 2.2 Remove the frame to gain access to the viewing aperture by lifting the hooks clear of the slots on the front of the appliance, see Diagram 3.

Note: This will lift the cast top slightly.

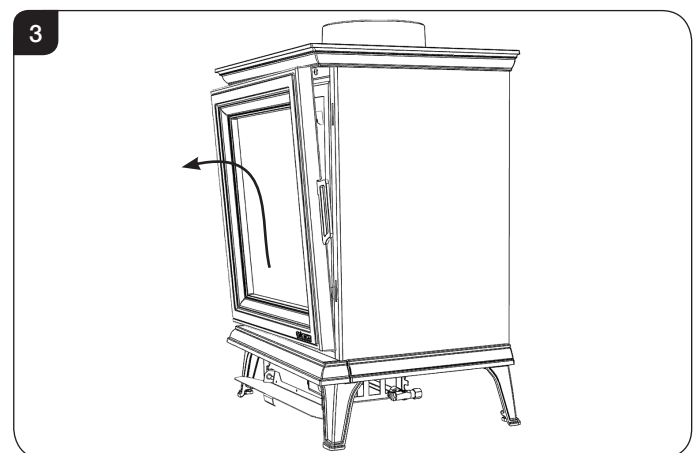

- 2.3 Using a screwdriver remove the 4 screws securing the window panel to the appliance, see Diagrams 4

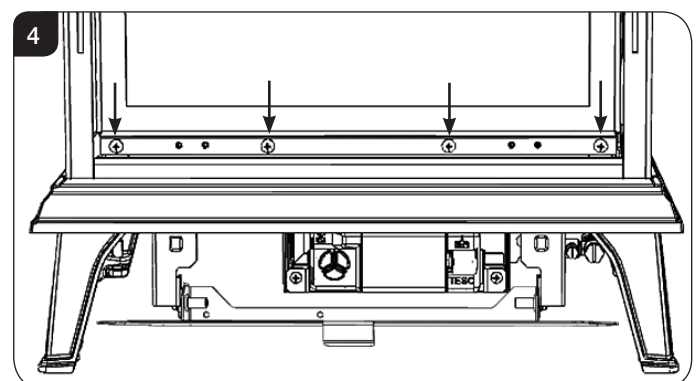

Servicing Instructions - Replacing Parts

- 2.4 The frame can be removed by pulling the lower edge of the window panel forward and lifting the top return off the firebox, see Diagram 5.

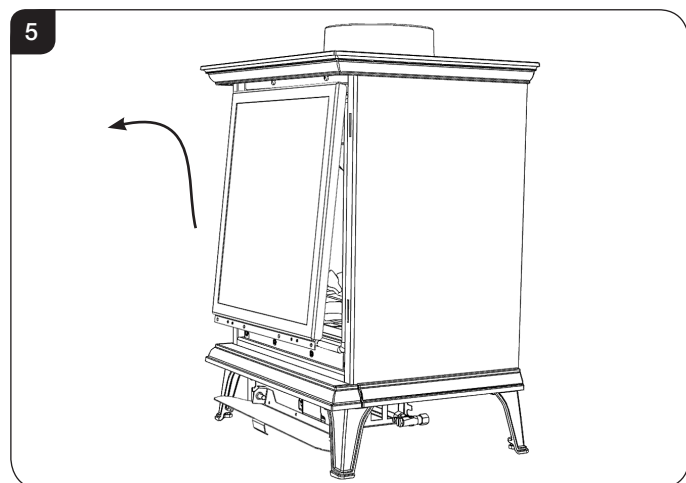

- 2.5 Place carefully to one side.
- 2.6 Carefully remove the ceramic fuel bed components.
- To refit the door:
- 2.7 Refit in reverse order ensuring that the rope seal is intact.
- 2.8 Hook the top return of the glass panel over the top of the firebox and ensure it is central.
- 2.9 Push the lower edge towards the firebox and secure with the 4 screws.

Replace ALL of the glass frame securing screws ensuring that a screw is present in all fixing slots, see Diagram 3.

NEVER OPERATE THE APPLIANCE WHEN THE DOOR IS REMOVED, OR THE GLASS IS BROKEN.



UNDER NO CIRCUMSTANCES SHOULD THE APPLIANCE BE USED IF ANY OF THE GLASS FRAME RETAINING SCREWS ARE LOOSE OR MISSING.

- 2.10 Lift the cast lid slightly and fit the front by inserting the hooks on the back of the frame into the slots on the front of the appliance.

3. Appliance Battery

It is not necessary to remove the appliance battery to service the appliance, however the Power Switch on the Control Box must be switched to the OFF (o) position.

- 3.1 The Power Switch is located on the Control Box at the bottom of the appliance behind the vanity cover, see Diagram 6.
- 3.2 **Slide the Power Switch on the Control Box to the OFF (o) position before servicing the appliance.**

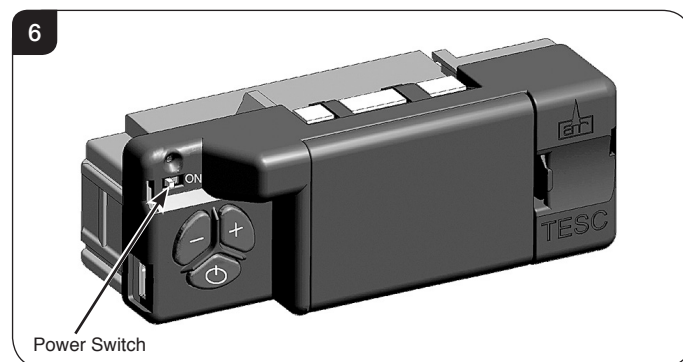

4. Baffle & Liners

BAFFLE

- 4.1 The baffle must be removed before the liners can be taken out of the appliance.

To do this undo the 4 screws securing it to the roof of the firebox, see Diagram 7.

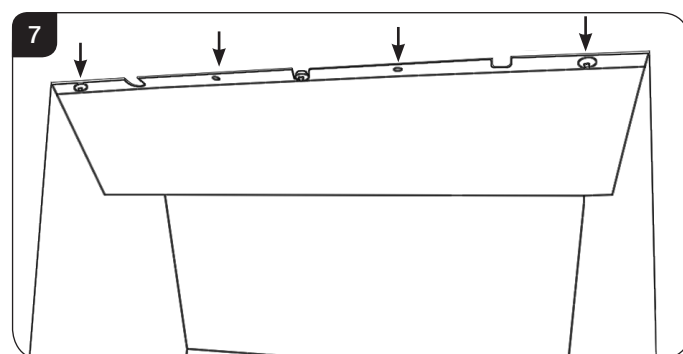

- 4.2 The baffle can now be removed through the front of the appliance.

Once the baffle has been removed the liners can then be taken out.

- 4.3 To remove the side liners:

Tilt towards the centre of the firebox.

Lift up and pull out of position, see Diagram 8.

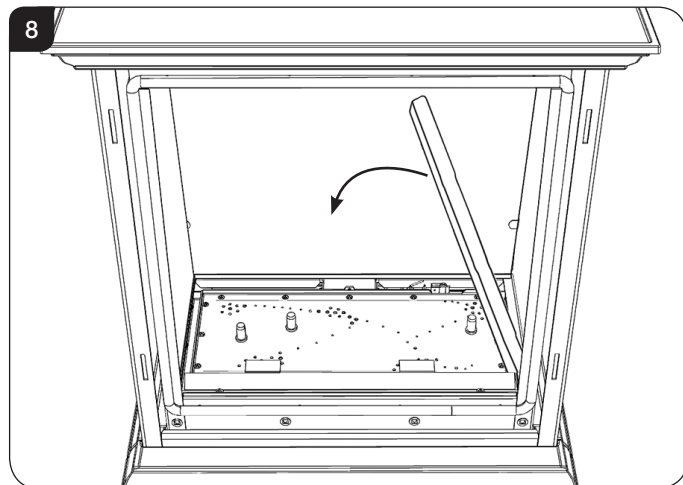

Support the rear liner when handling the last side and remove carefully.

- 4.4 Lean the top of the panel forward, lift and twist slightly to allow removal through the front of the appliance.

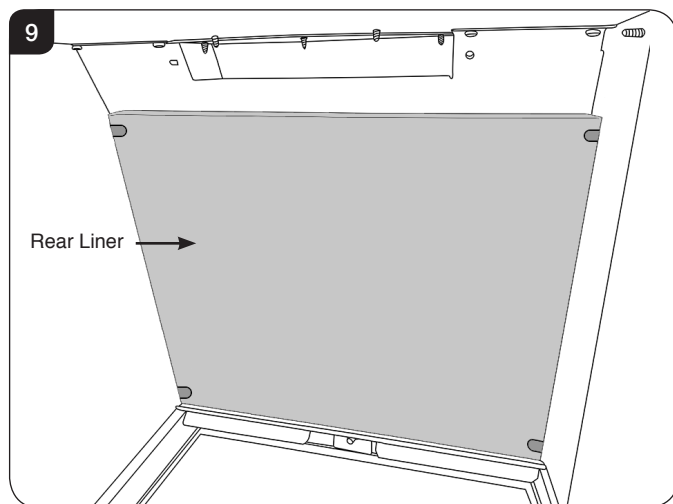

- 4.5 With the liners and baffle removed the firebox is clear for cleaning and maintenance, see Diagram 10.

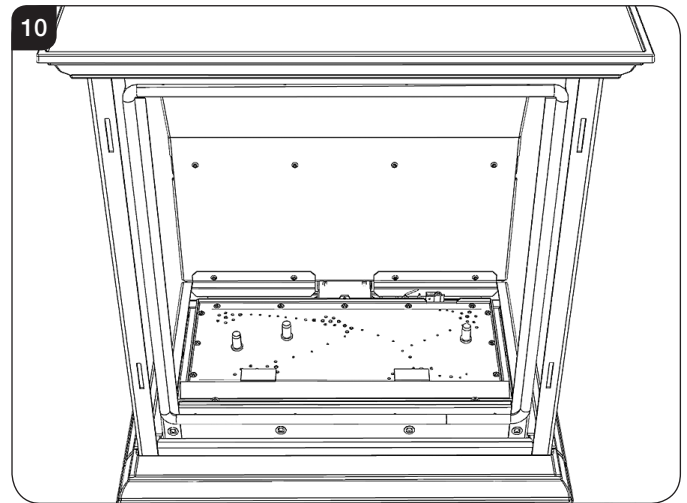

- 4.6 To replace the liners and baffle reverse these procedures.

To replace the main burner:

- 5.1 Undo the 2 screws to remove the fuel bed trim, see Diagram 11.

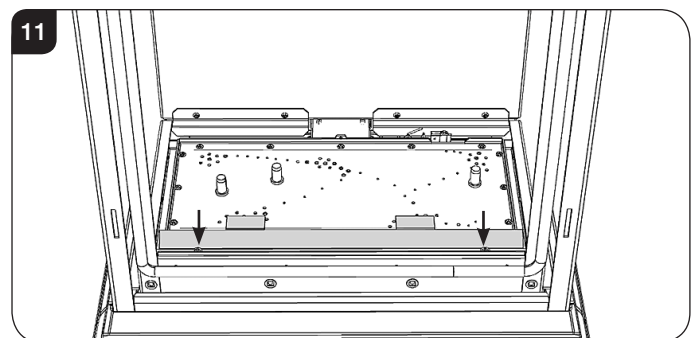

- 5.2 Remove the 2 securing screws at the front of the burner, see Diagram 12.

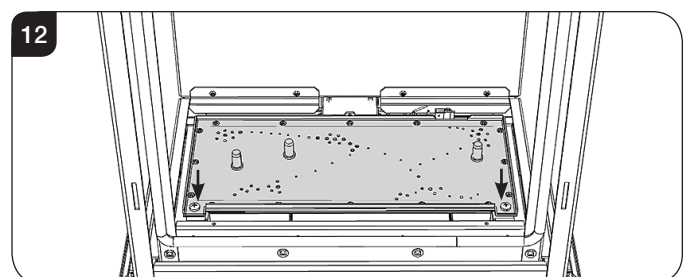

Servicing Instructions - Replacing Parts

- 5.3 Lift the burner out of the firebox at an angle clear the brackets, exposing the service hatch, see Diagram 13.

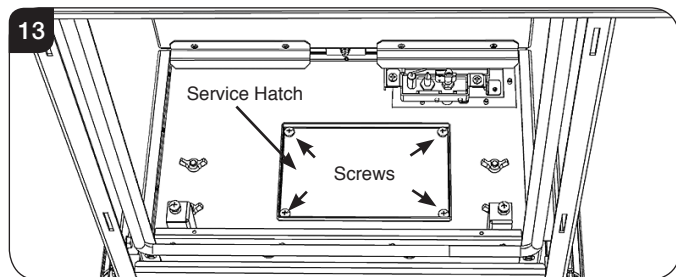

- 5.4 Refit in reverse order.

Important: Ensure the burner engages with the injector at the rear of the firebox, see Diagram 14.

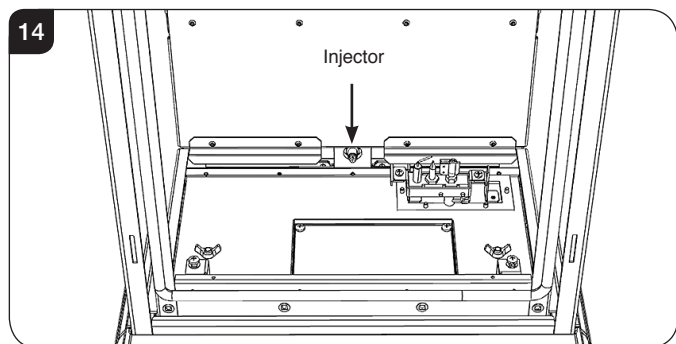

6. Control Assembly & Service Hatch

- 6.1 It is not necessary to remove the complete control assembly to service or replace parts of this appliance. The following sections will detail how to individually remove and replace each element.

- 6.2 The appliance has a servicing hatch to allow access to the gas valve and control assembly in the base of the firebox.

Remove the 4 screws holding the service hatch, see Diagram 13.

Remove the panel.

- 6.3 This will allow access to the rear of the valve, see Diagram 15.

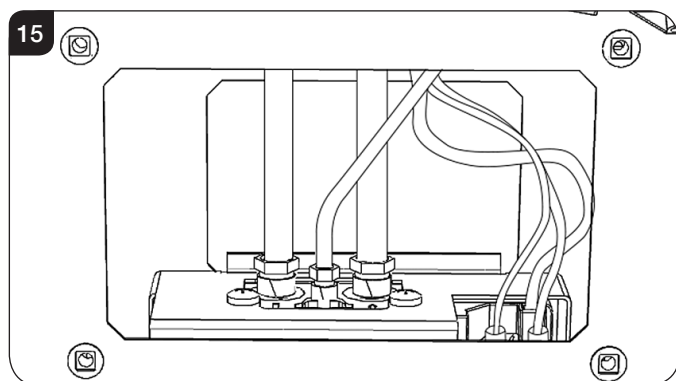

- 6.4 Reposition the service hatch and tighten the 4 screws, see Diagram 16.

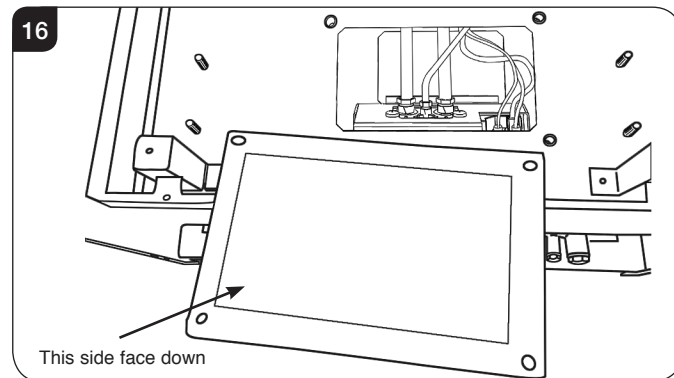

7. ODS Pilot Unit



IMPORTANT: UNDER THE TERMS OF THE EXTENDED WARRANTY IT WILL BE COMPULSORY TO CHANGE THE COMPLETE PILOT UNIT ON THIS APPLIANCE IN YEARS 2 AND 4.

Note: The pilot unit on the appliance is a non serviceable unit due to the complex nature of its manufacture.

Replacement of the complete unit must be carried out when one of the following items becomes faulty:

- Pilot injector
- Ignition electrode
- Thermocouple leads
- Ignition Lead

- 7.1 Remove the Main Burner and service hatch, see Sections 5 & 6.

- 7.2 Undo the pilot pipe from the pilot unit, see Diagrams 17.

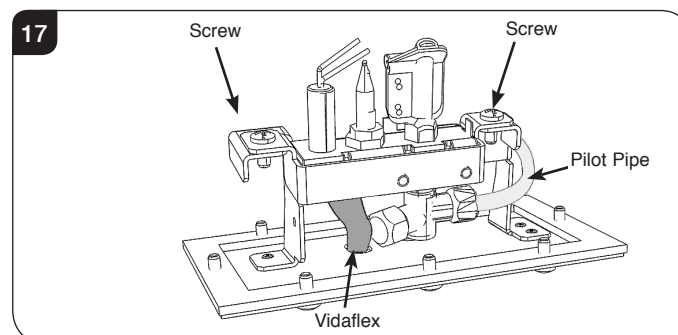

- 7.3 Remove the 2 screws securing the pilot assembly, see Diagram 17.

- 7.4 Unplug the red and green thermocouple connections (A) and the white ignition lead (B) from the gas valve, see Diagram 18.

NOTE: Ensure the correct orientation when replacing, see Diagram 18 detail.

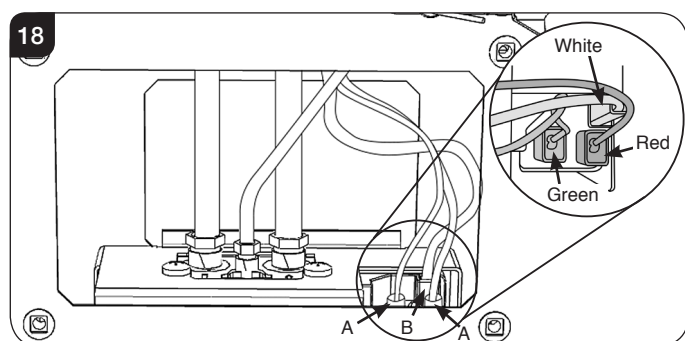

- 7.5 Gently withdraw the leads with Vidaflex through the base of the firebox.

Note: Ensure that the Vidaflex is replaced when refitting the new pilot unit.

- 7.6 Replace with a new pilot assembly and check the spark gap, see Diagram 19.

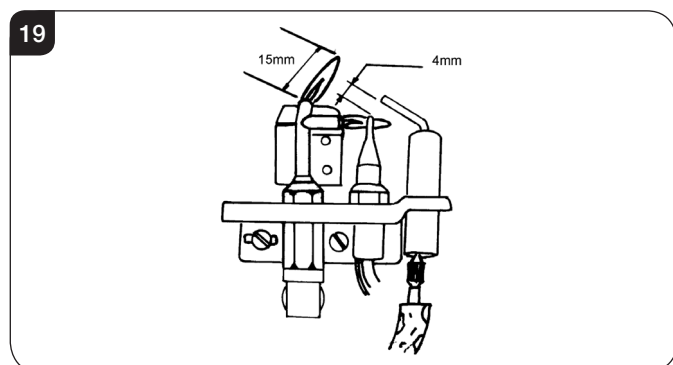

NOTE: Ensure the correct orientation when replacing.

- 7.7 After reassembly check for gas soundness and carry out a functional check.

8. Ignition Lead

- 8.1 The Ignition Lead used on this appliance can not be replaced individually. If a new lead is required it will be necessary to change the pilot unit, see Section 7.

9. Gas Valve

- 9.1 Remove the Main Burner and service hatch, see Sections 5 & 6.

- 9.2 Unplug the red and green thermocouple connections (A) and the white ignition lead (B) from the gas valve, see Diagram 20.

NOTE: Ensure the correct orientation when replacing, see Diagram 20 detail.

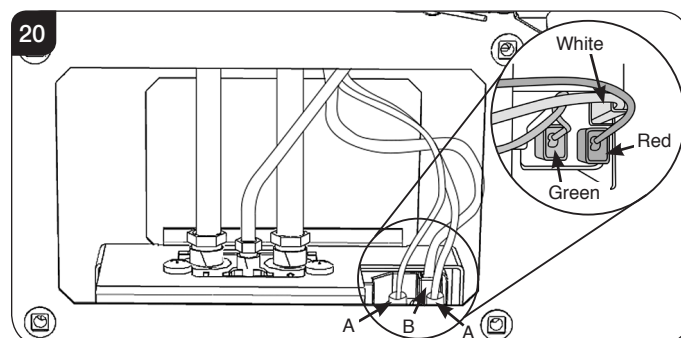

- 9.3 Undo the inlet pipe from the gas valve, see Diagram 21, Arrow A.

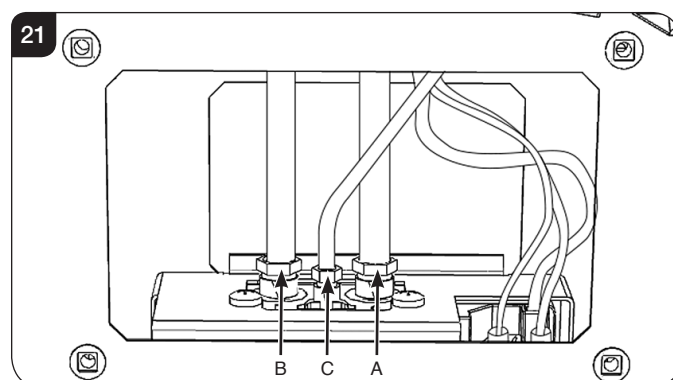

- 9.4 Undo the main injector feed pipe from the gas valve, see Diagram 21, Arrow B.

- 9.5 Undo the pilot pipe from the gas valve, see Diagram 21, Arrow C.

- 9.6 Undo 2 screws securing the gas valve to the bracket, see Diagram 22.

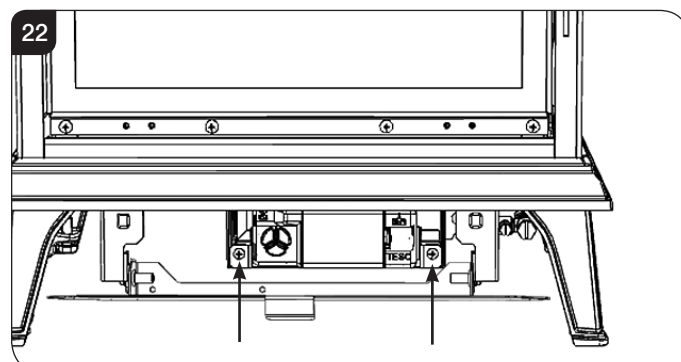

- 9.7 The gas valve can now be slid forward to remove from the burner unit.

Servicing Instructions - Replacing Parts

- 9.8 To replace the gas valve reverse the above procedure.

NOTE: Ensure the correct orientation of the connections when replacing, see Diagram 19 detail.

- 9.9 Check for gas leaks.

10. Main Injector

- 10.1 To remove the main injector turn off the gas supply at the isolation device.
- 10.2 Remove the main burner and service hatch, see Section 5.
- 10.3 Undo the main injector feed pipe from the gas valve, see Diagram 23.

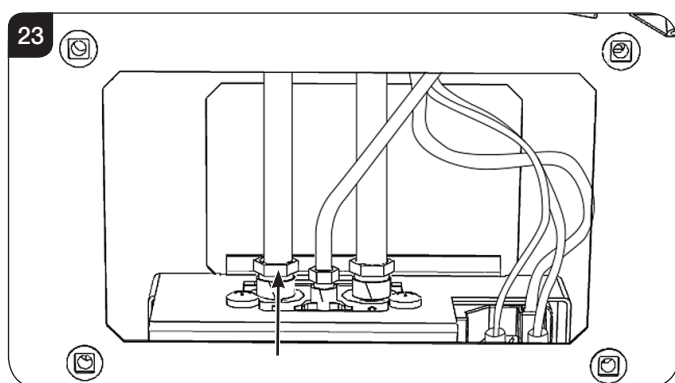

- 10.4 Working from inside the firebox remove the lock nut from the injector, see Diagram 24.

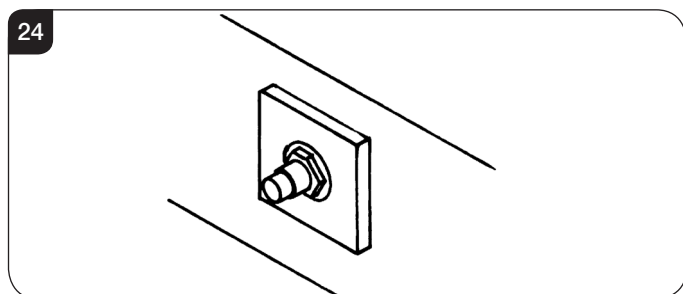

- 10.5 Gently push the injector pipe backwards and extract the injector with the feed pipe through the service hatch.
- 10.6 Holding the injector with a spanner undo the feed pipe.
Note the orientation of the Injector.
- 10.8 Re-assemble in reverse order.
- 10.9 Turn on the gas supply and check for leaks.

11. Primary Aeration Plate

NOTE: Not all models have aeration plates.
Please refer to the Technical Specification.

- 11.1 To replace the primary aeration plate turn off the gas supply at the isolation device.
- 11.2 Remove the burner, see Installation Instructions, Replacing Parts, Section 5.
- 11.3 Undo the 2 nuts and remove the plate.
- 11.4 Replace with the correct size plate and secure the 2 nuts. Ensure that the lower edge of the plate is located over the venturi flange, see Diagram 25.

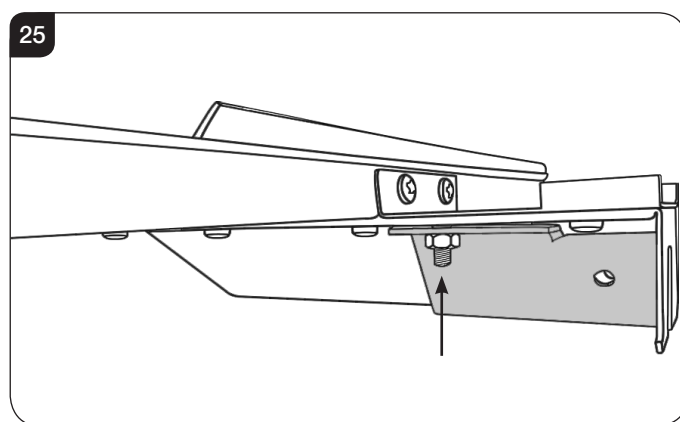

12. Changing Between Gas Types

A kit of parts is available for this - Contact your Gazco retailer for further information.

It will be necessary to change the following:

- Burner
- Injector
- Pilot
- Gas Valve

Always quote the Model number and Serial number when ordering any spare parts.

Servicing Instructions - Replacing Parts

13. Spares List

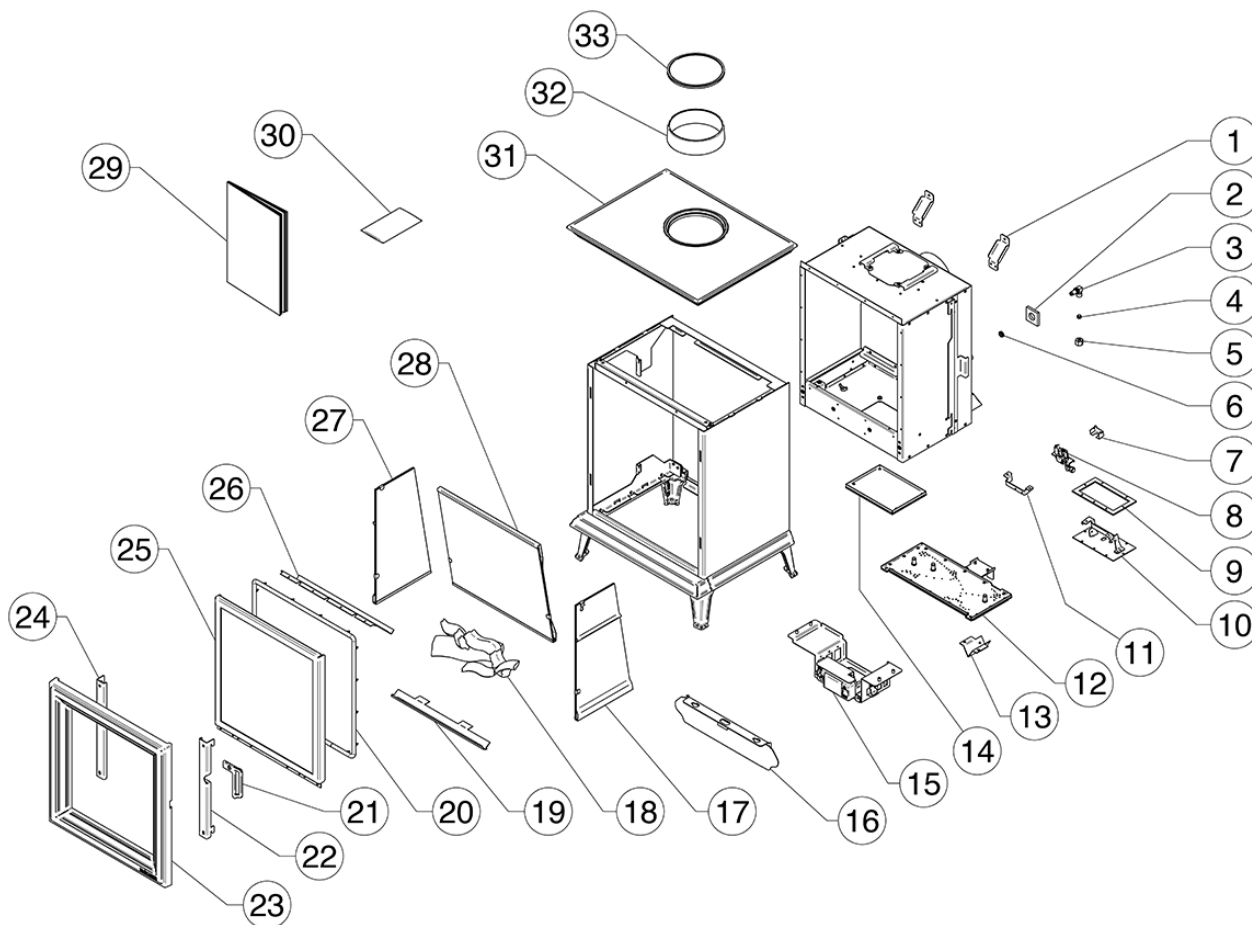

No.	Component	Part Code		Quantity
		Natural Gas	LPG	
1	Restraint Bracket	GZ13397		2
2	Venturi Seal	FA0171		1
3	Injector	IN0023	IN0052	1
4	Olive 8mm	FA0011		1
5	1/4" BSP Nut	FA0029		1
6	1/8" BSP Locknut	FA0241		1
7	Lint Arrester Shield	PI0056		1
8	Oxy Pilot	PI0090	PI0092	1
9	Pilot Bracket Gasket	CE2083		1
10	Pilot Bracket Assembly	GZ15884		1
11	Pilot Bracket	GZ15695		1
12	Burner Assembly	GZ13746	GZ13748	1
13	Aeration Plate	GZ15859	GZ10410	1
14	Control Access Cover	GZ15897		1
15	Engine Assembly	GZ15923	GZ15924	1
16	Vanity Panel Assembly	GZ15749		1
17	RH Glass Panel Assembly	GZ13422		1

No.	Component	Part Code		Quantity
		Natural Gas	LPG	
18	Log Set	CE1755		1
19	Front Stone Channel	GZ13477		1
20	Door Seal	FA0725		1
21	Door Handle	ME602112		1
22	RH Door Hook	GZ15672		1
23	Cast Door	CA0864		1
24	LH Door Hook	GZ15671		1
25	Glass Frame Assembly	GZ13410		1
26	Baffle	GZ13720		1
27	LH Glass Panel Assembly	GZ13423		1
28	Rear Glass Panel Assembly	GZ13635		1
29	Instruction Manual	PR2773		1
30	Embaglow	GZ8471		1
31	Cast Top	CA0870		1
32	Cast Flue Collar	999-010		1
33	Cast Blanking Plate	CA0871		1



Due to continual technical improvements please check online or with your Gazco retailer for the most up to date parts lists.

Only use Genuine Gazco spares when servicing your appliance.

All of our essential spare parts and consumable items are available to purchase from our webshop at www.gazcospares.com.

Servicing Instructions - Replacing Parts

13. Spares List - Control Assembly

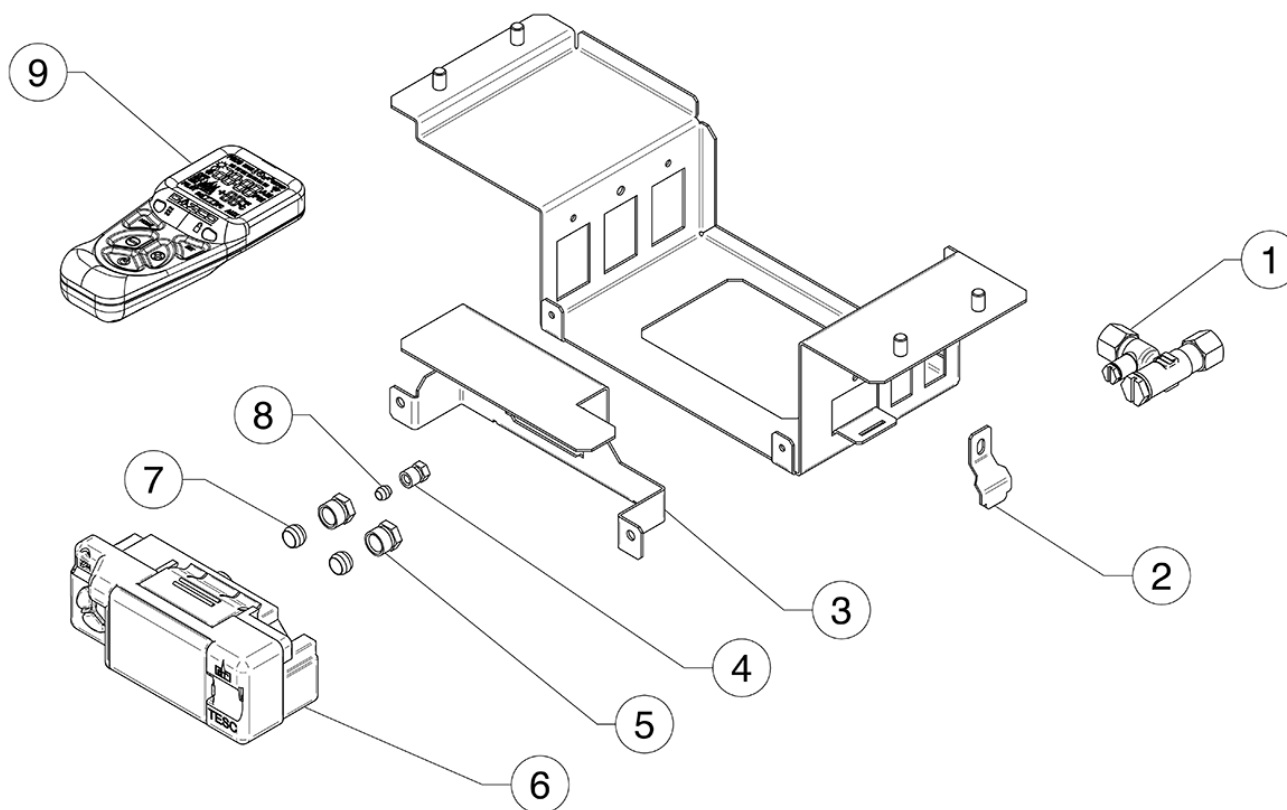

No.	Component	Part Code		Quantity
		Natural Gas	LPG	
1	Inlet Isolation Valve	GC0095		1
2	Pipe Clamp	GZ15748		1
3	Control Valve Bracket	GZ15741		1
4	4mm Tube Nut	FA0782		1
5	8mm Tube Nut	FA0780		2
6	Gas Control Valve	GC0182K		1
7	Olive 8mm	FA0011		2
8	Olive 4mm	FA0781		1
9	Handset	EL0807		1



Due to continual technical improvements please check online or with your Gazco retailer for the most up to date parts lists.

Only use Genuine Gazco spares when servicing your appliance.

All of our essential spare parts and consumable items are available to purchase from our webshop at www.gazcospares.com.

Service Records

1ST SERVICE

Date of Service.....
Next Service Due
Signed
Retailer's Stamp/GasSafe Registration Number

3RD SERVICE

Date of Service.....
Next Service Due
Signed
Retailer's Stamp/GasSafe Registration Number

5TH SERVICE

Date of Service.....
Next Service Due
Signed
Retailer's Stamp/GasSafe Registration Number

7TH SERVICE

Date of Service.....
Next Service Due
Signed
Retailer's Stamp/GasSafe Registration Number

9TH SERVICE

Date of Service.....
Next Service Due
Signed
Retailer's Stamp/GasSafe Registration Number

2ND SERVICE

Date of Service.....
Next Service Due
Signed
Retailer's Stamp/GasSafe Registration Number

4TH SERVICE

Date of Service.....
Next Service Due
Signed
Retailer's Stamp/GasSafe Registration Number

6TH SERVICE

Date of Service.....
Next Service Due
Signed
Retailer's Stamp/GasSafe Registration Number

8TH SERVICE

Date of Service.....
Next Due
Signed
Retailer's Stamp/GasSafe Registration Number

10TH SERVICE

Date of Service.....
Next Service Due
Signed
Retailer's Stamp/GasSafe Registration Number

Information Requirement - Gas Heaters

Information Requirement for Gaseous Fuel Local Space Heater

Model		Sheraton 5 NG	Sheraton 5 LPG
Fuel	Space Heating Emissions (NOx) - mg / kWh _{input} (GCV)	130	130

Heat Output	Nominal Heat Output - P_{nom}	4.2kW	4.3kW
	Minimum Heat Output (indicative) - P_{min}	1.6kW	1.6kW

Auxiliary Electricity Consumption	At Nominal Heat Output - $e_{l,max}$	N/A	N/A
	At Minimum Heat Output - $e_{l,min}$	N/A	N/A
	In Standby Mode - $e_{l,SB}$	N/A	N/A

Useful Efficiency (NCV)	Useful Efficiency at nominal heat output - $\eta_{th,nom}$	76.0%	76.0%
	Useful Efficiency at minimum heat output (indicative) - $\eta_{th,min}$	61.8%	61.8%

Permanent Pilot Flame Power requirement	Permanent Pilot Flame Power requirement (if applicable) - P_{pilot}	N/A	N/A
-----------------------------------------	-----------------------------------------------------------------------	-----	-----

Type of heat output/room temperature control		
Electronic room temperature control + day timer	Yes	Yes

Other control options (multiple selections possible)		
Room temperature control, with presence detection	No	No
Room temperature control, with open window detection	No	No
With distance control option	No	No
With adaptive start control	No	No
With working time limitation	No	No
With black bulb sensor	No	No

Energy Efficiency Index	72.0%	72.0%
Energy Efficiency Class	D	D

Contact:	Gazco Ltd, Osprey Road, Sowton Industrial Estate, Exeter, EX2 7JG
----------	-------------------------------------------------------------------

Gazco Limited, Osprey Road, Sowton Industrial Estate, Exeter, Devon, England EX2 7JG
Technical Customer Services: (01392) 261950 Fax: (01392) 261951
E-mail: technicalservices@gazco.com

A member of the Stovax Group
E & O E